

- Engine Exhaust
- Boiler Breeching/Stack
- Grease Duct
- Gas and Oil Vents

USS Universal Stack System

Models DWKL and SWKL Submittal Record

- ☐ DWKL Double Wall
- ☐ SWKL Single Wall
- ☐ DWKL-Lt Double Wall
- ☐ SWKL-Lt Single Wall
- ☐ DWKL-Vt Double Wall
- ☐ SWKL-Vt Single Wall

PROJECT: _____

PREPARED BY: _____

PREPARED FOR: _____

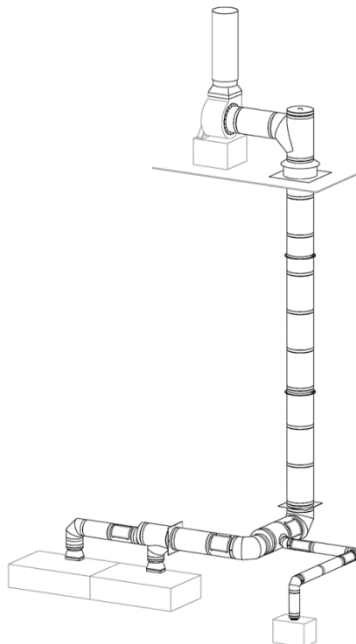
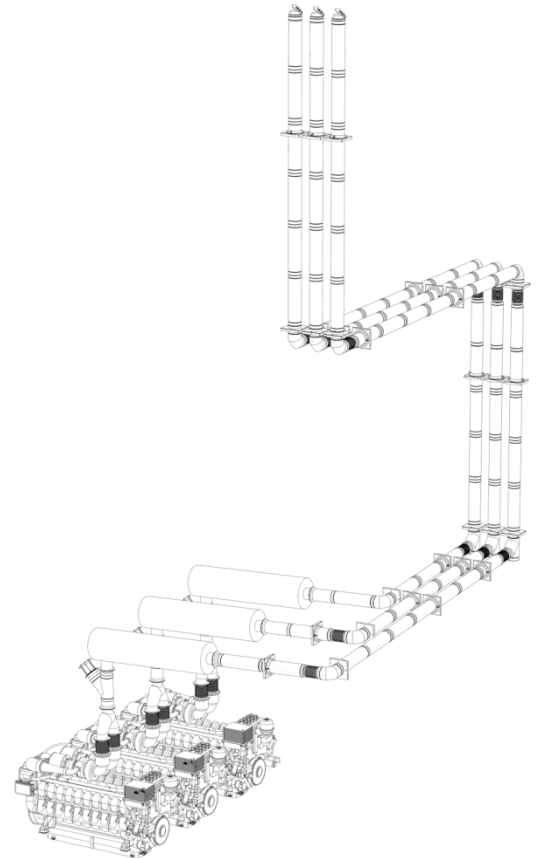

INDEX

INTRODUCTION

Jeremias Exhaust Systems	3
40 Years of Experience	3
Research & Development	3
All Stainless Steel Construction	4
Best Insulation	4
Joint Connection Surface Area	4

TECHNICAL SPECIFICATIONS

Model and Part Identifications	5
Material and Thicknesses	5
Underwriters Laboratories Listings	5
Operating Pressures	5
Code and Standards	5
Operating Temperatures	5
Joint Detail	6
Pipe Weight per Foot	6
Sizing/Pressure Calculations	6
Submittal and Warranted Designs	6
Joint Assembly	7
KL Paste	7
Support Innovations	7

ITEMS

(supports)

APS Anchor Plate Support
HDB Heavy Duty Base
WB Wall Brackets
FAR Full Angle Ring
HAR Half Angle Ring
LSB Light Support Band
GWB Guy Wires Band

(pipe and other lengths)

9L 9" Fixed Pipe Length
12L 12" Fixed Pipe Length
18L 18" Fixed Pipe Length
24L 24" Fixed Pipe Length
30L 30" Fixed Pipe Length
36L 36" Fixed Pipe Length
42L 42" Fixed Pipe Length
48L 48" Fixed Pipe Length
UDL Universal Drain Length
TPL Test/Nozzle Port Length
18CL 18" Cut Pipe Length
30CL 30" Cut Pipe Length
18AL 18" Adjustable Length
30AL 30" Adjustable Length
18AG 18" Adjustable Length w/ Gasket
30AG 30" Adjustable length w/ Gasket
18ALG 18" Adjustable Length w/ Graphite
30ALG 30" Adjustable Length w/ Graphite
LBL 18" Lined Bellows Length

(fittings and accessories)

15EL 15° Elbow
30EL 30° Elbow
45EL 45° Elbow
45EL 45° Elbow
87EL 87° Elbow
90EL 90° Elbow
45T 45° Tee
87T 87° Tee
90T 90° Tee
87BT 87° Boot Tee

90BT 90° Boot Tee
90WT 90° Wye Tee
DCB Drain Tee Cap Bottom
DCS Drain Tee Cap Side
TCA Tee Cap Access
PRV Pressure Relief Valve
<i>(increasers and reducers)</i>
TI Tapered Increaser
TR Tapered Reducer
TEI Tapered Eccentric Increaser
TER Tapered Eccentric Reducer
SI Stepped Increaser
SR Stepped Reducer
SEI Stepped Eccentric Increasers
SER Stepped Eccentric Reducer
<i>(start and end adapters)</i>
RCIS & RCIE Raw Collar Adapter Inside
RCOS & RCOE Raw Collar Adapter Outside
FCS & FCE Flange Collar Adapter
FCK Flange Collar Kit
AFS & AFE 125/150 Lb ANSI Flange
TRS & TRE Transition to Round
FPS & FPE Fan Plate Adapter
D2S DWKL to SWKL Adapter
S2D SWKL to DWKL Adapter
<i>(terminations)</i>
OTN, OTNH, OTS, & OTSH Open Termination
EC & ECH Exit Cone
FTN, FTNH, FTS, & FTSH Flat Top Rain Cap
WRC High Wind Rain Cap
SCN, SCNH, SCS, SCSH Stack Cap
MCS & MCSH Miter Cut Termination w/ Screen
EFT & EFTH Engine Flip Top
NLWH No-Loss Weather Head
<i>(thimble and flashings)</i>
HTT High Temperature Insulated Thimble
FRF Flat Roof Flashing
PRF Pitched Roof Flashing
SC Storm Collar
VRF Ventilated Roof Flashing
VSC Ventilated Storm Collar
HSDW Heat Shield for DWKL

SAMPLE DESIGNS

Sample 1 - DWKL Engine Exhaust	8
Sample 2 - DWKL Boiler Stack	9
Sample 3 - SWKL Fume Hood Vent	10
Sample 4 - DWKL Commercial Grease Duct	11
Sample 5 - DWKL Pizza Oven Chimney	12
Sample 6 - DWKL Restaurant Exhaust	13
Sample 7 - SWKL Dishwasher Exhaust	14
Sample 8 - DWKL Category III or IV Sidewall	15
Sample 9 - DWKL/SWKL Sealed Combustion	16
Sample 10 - SWKL Comm. Laundry Exhaust	17
Sample 11 - SWKL Chimney Liner	18

WARRANTY STATEMENT	19
--------------------	----

NOTES/COMPANY INFO	20
--------------------	----

INTRODUCTION

Jeremias Exhaust Systems

Models DWKL and SWKL are factory built high pressure and high temperature exhaust systems for various type of appliances. Model DWKL is Double Wall and Model SWKL is Single Wall. Each may be intermixed in the same stack, chimney, grease duct or vent system.

Models DWKL and SWKL are intended for use in connecting heating and hot water appliances, engines, and turbines to the outdoors. There are also many other applications and uses including, but not limited to the following: Chimney Liners, Chutes, Dryer Vents, Fume Venting, Industrial Oven and Process Stacks, Incinerator Exhausts, Paint Booth Exhausts, Particle Conveying, and Ventilation Ducts.

STRONG - OPEN - INTERNATIONAL



40 Years of Experience

Jeremias is one of the world's leading manufacturers of flue and chimney systems for the exhaust of gases and ventilation, covering all kinds of domestic, commercial and industrial applications. Jeremias Group product range includes over fifty (50) different CE or UL certified systems covering commercial and domestic applications complimented by freestanding Industrial steel chimneys up to 10 feet in diameter. Jeremias offers its clients a wide range of high quality products, technical support for projects, and stack sizing software.

With over 40 years of experience in the venting and component exhaust industries, Jeremias has seven (7) manufacturing plants in six (6) different countries worldwide. Jeremias today has more than 1,000 employees and is proud of its German engineering origins, and fortunately is now also manufactured in the USA from 100% local materials!

Here in North America, Jeremias Inc. focuses on only high pressure exhaust systems for commercial and industrial applications.

Research and Development

Jeremias has over fifty (50) CE Certified exhaust and chimney systems worldwide for domestic, commercial, and industrial applications. "CE Certification" is the mandatory conformity safety testing for products sold throughout Europe and other parts of the world.

In North America, Jeremias employs only Underwriters' Laboratories (UL) for testing, certifications, and listings to all applicable UL and ULC Standards.



INTRODUCTION

Opened in 2013, the Jeremias R&D Lab in Logan, OH has the industry's most experienced lab technicians on staff and incorporates the latest equipment technologies. This laboratory enables Jeremias to provide industry leadership with a continued focus on new factory-built exhaust applications and unique listings. For example, Model DWKL is the first double wall commercial exhaust system in North America that is purposely designed to use insulation between the walls from the start; whereas other manufacturers derived insulated versions from the original air space design.

All Stainless Steel Construction



The standard 444 stainless steel (EN 1.4521) inner wall is the new standard for high temperatures yet still corrosion resistant to flue gas condensation. 444 stainless steel provides a better higher temperature solution over austenitic 304 or 316 stainless steels due to lower expansion coefficient value, meaning no cracking from less expanding oxides. 444 stainless steel has very good resistance to pitting corrosion in chloride media, much better than 304 (EN 1.4301) and 316 (EN 1.4401) stainless steels, and even better than 316L (EN 1.4404) stainless steel. 444 stainless steel also has a higher minimum proof strength than 304 stainless steel in combination with lower work hardening behavior.

The outer jacket is always made of stainless steel. Type 430 stainless steel with a bright annealed finish is standard. All accessories (including support plates and angle rings) are also made of stainless steel. This means there is no cross contamination in the factory from carbon steel cutting/welding. Jeremias cleans all external welds to assure the customer clearly sees the quality standard we are setting.

Jeremias backs our exhaust systems with an industry's first Twenty-Five (25) Year Standard Warranty.

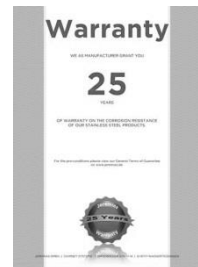

Best Insulation

Jeremias uses the new Superwool® Plus fiber blanket by Thermal Ceramics (Augusta, Georgia), which has improved handling strength and enhanced thermal properties. Superwool® Plus blanket is manufactured from pure raw materials using a new manufacturing technology. In addition to enhanced thermal properties, large nuisance dust particles have been effectively eliminated making the product soft to the touch and less irritating during use. Superwool® Plus blanket contains neither binder nor lubricant and does not emit any fumes or smells during the first high temperature firing.

Jeremias compresses a 1½" blanket into a 1¼" area delivering better clearances and skin temperatures than other loose fitting blanket insulated pipes. This also eliminates any chance of insulation settling during shipment and storage. See the installation clearance example using the same pipe I.D. as compared to other manufacturers. Jeremias Model DWKL clearly is the industry leader in the smallest required footprint.



Largest Joint Connection Surface Area

Models DWKL and SWKL are cylindrical, factory-built, modular venting systems that incorporate a steel to steel conical joint and clamp system for quick and easy assembly in the field. A Jeremias supplied high temperature ceramic lubricating and assembly paste is applied on the conical joint to assure the best steel to steel connection; and it is then tapped into place creating a gas-tight and liquid-tight seal.

The conical joints have a 2.2" steel to steel surface-area at each connection allowing greater stiffness, sealing, and durability compared to ½" flange to flange systems. Example, 6" I.D. SWKL/DWKL has a 41.45 in² overlap at each joint where a ½" flanged systems has 9.42 in². UL Testing resulted in the industry's first 90" W.C. pressure capability after continuous 1400°F flue gas temperatures.

The double wall Model DWKL is insulated with 1¼" thick compressed fiber insulation which allows the inner and outer pipes to stay aligned, without the use of additional clips or brackets. On other designs, clips or brackets act as a thermal bridge from the inner wall to outer jacket, so with no additional thermal bridge at the joint means there are no hot spots at pipe and fitting connections.

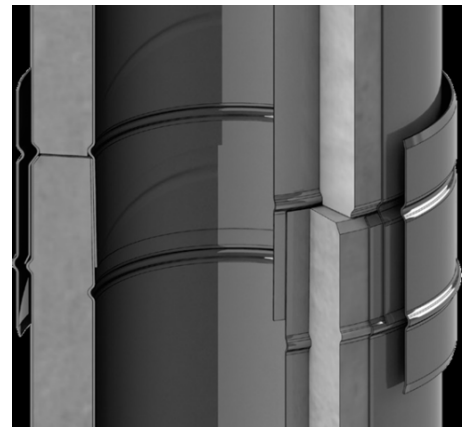

TECHNICAL SPECIFICATIONS

Model and Part Identifications

DWKL, Double Wall, universal, for all applications
SWKL, Single Wall, universal, for most applications
DWKL-Lt, Double Wall Light, for all applications
SWLT-Lt, Single Wall Light, for most applications
DWKL-Vt, Double Wall Gas Vent, for 1000°F max. applications
SWG-Vt, Single Wall Gas Vent, for 1000°F max. applications

Part numbers include the Model, diameter, item code, then variation (if any).

Example 1: DWKL8-36L for an 8 inch inner diameter Model DWKL double wall 36 inch length of pipe.

Example 2: SWKL3-45EL-Vt for a 3 inch inner diameter Model SWKL single wall 45° Elbow Gas & Oil Vent

Material Options and Thicknesses

Inner Liner of DWKL and SWKL:
 o 0.035" thick Type 444 stainless steel

Inner Liner of DWKL-Lt and SWKL-Lt:
 o 0.020" thick Type 444 stainless steel

Inner Liner of DWKL-Vt and SWKL-Vt options:
 o 0.020" thick Type 444 stainless steel
 o 0.020" thick Type AL29-4C stainless steel

Insulation of DWKL and DWKL-Lt:
 o 1.5" blanket 8 PCF fiber compressed to 1.25" thick (9.6 PCF net effective)

Insulation of DWKL-Vt:
 o 1.25" thick cut 8 PCF Mineral Wool

Outer Jacket of DWKL, DWKL-Lt, and DWKL-Vt options:
 o 0.025" thick Type 430 stainless steel with BA Finish
 o 0.025" thick Type 304 stainless steel with 2B Finish

Underwriters Laboratories Listings

UL File Number for All Listings: MH59917

United States:

DWKL & DWKL-Lt Double Wall with compressed fiber

1. UL-103 Standard, Building Heating Appliance Chimney
2. UL-103 Standard, Additional Type HT Listing
3. UL-2561 Standard, 1400F Chimney Listing
4. UL-103 & UL-2561 Standards, Additional Positive Pressure Listing to 90" WC after 1400°F
5. UL-1978 Standard, Grease Duct
6. UL-1738 Standard, Venting Systems for Gas-Burning Appliances, Categories II, III and IV
7. UL-441 Standard, Gas Vents
8. UL-641 Standard, Type L Low-Temperature Vent

SWKL & SWKL-Lt Single Wall

1. UL-103 Standard, Building Heating Appliance Chimney
2. UL-103 Standard, Additional Positive Pressure Listing
3. UL-1978 Standard, Grease Duct
4. UL-1738 Standard, Venting Systems for Gas-Burning Appliances, Categories II, III and IV
5. UL-1777 Standard, Chimney Liners

DWKL-Vt Gas Vents with cut mineral wool insulation

1. UL-103 Standard, Building Heating Appliance Chimney
2. UL-103 Standard, Additional Positive Pressure Listing to 90" WC after 1400°F
3. UL-1738 Standard, Venting Systems for Gas-Burning Appliances, Categories II, III and IV
4. UL-441 Standard, Gas Vents
5. UL-641 Standard, Type L Low-Temperature Vent

SWKL-Vt Single Wall Gas Vents

1. UL-103 Standard, Building Heating Appliance Chimney
2. UL-103 Standard, Additional Positive Pressure Listing to 90" WC after 1400°F
3. UL-1738 Standard, Venting Systems for Gas-Burning Appliances, Categories II, III and IV
4. UL-1777 Standard, Chimney Liners

Canada:

DWKL & DWKL-Lt Double Wall compressed fiber insulation

1. Industrial Type 540°C Chimney
2. Industrial Type 760°C Chimney
3. ULC-S662 Standard for Factory-Built Grease Ducts
4. ULC-S636 Standard for Type BH Gas Venting Systems
5. ULC-S605 Standard for Gas Vents
6. ULC-S609 Standard for Low-Temperature Vents Type L

SWKL & SWKL-Lt Single Wall

1. ULC-S662 Standard for Factory-Built Grease Ducts
2. ULC-S636 Standard for Type BH Gas Venting Systems
3. ULC-S635 Standard for Lining Systems for Chimneys

DWKL-Vt Gas Vents with cut mineral wool insulation

1. ULC-S636 Standard for Type BH Gas Venting Systems
2. ULC-S605 Standard for Gas Vents
3. ULC-S609 Standard for Low-Temperature Vents Type L

SWKL-Vt Single Wall Gas Vents

1. ULC-S636 Standard for Type BH Gas Venting Systems
2. ULC-S635 Standard for Lining Systems for Chimneys

UL & ULC Listings Matrix:

Criteria	DWKL	SWKL	DWKL-Lt	SWKL-Lt	DWKL-Vt	SWKL-Vt
UL-103 Building Heating Appliance Chimney ULC/ORD-C959 Industrial Type 540°C Chimney	X	X ¹	X	X ¹	X	X
Additional UL-103 Type HT	X		X			
UL-2561 1400°F Chimney ULC/ORD-C959 Industrial Type 760°C Chimney	X		X			
UL-1978 Grease Duct ULC-S662 Grease Duct	X	X	X	X		
UL-1738 Special Gas Vent ULC-S636 Gas Vent	X	X	X	X	X	X
Optional 400°F UL-1738 Special Gas Vent	X	X	X	X	X	X
Optional Plastic (PVC, CPVC, PP) Special Gas Vent	X	X	X	X	X	X
UL-441 Gas Vents ULC-S605 Gas Vents	X		X		X	
UL-641 Type L Vent ULC-S609 Vents Type L	X		X		X	
UL-1777 Chimney Liner ULC-S635 Lining Systems for Existing Chimneys		X ²		X ²		X ²

Notes: 1. UL only, not ULC 2. UL (gas/oil), ULC (all fuels)

Operating Pressures

All Jeremias Inc. models have been evaluated and Listed by UL for positive pressures up to 90" W.C. internal static pressure with exposure up to 1400°F internal continuous temperatures.

TECHNICAL SPECIFICATIONS

Code and Standards

When installed per their instructions, all Jeremias Inc. models are code compliant with the following codes and standards:

- NFPA 31
- NFPA 37
- NFPA 54
- NFPA 96
- NFPA 211
- UMC
- CMC
- CSA-B139
- CSA-B149
- IMC
- IFGC
- ULC-S650

The following agencies or associations produce codes, standards, or guidelines by which all Jeremias Inc. Models may be installed and used:

- ASHRAE (American Society of Heating, Refrigerating and Air Conditioning Engineers)
- CSA (Canadian Standards Association)
- IAPMO (International Association of Plumbing and Mechanical Officials)
- ICC (International Code Congress)
- NFPA (National Fire Protection Association)
- UL (Underwriters Laboratories, Inc.)
- ULC (Underwriters' Laboratories of Canada)

Operating Temperatures

Operating Temperatures:

Criteria	Permitted Temperatures
UL-103 Building Heating Appliance Chimney ULC/ORD-C959 Industrial Type 540°C Chimney	1000°F (540°C) Continuous 1400°F (760°C) Intermittent
Additional UL-103 Type HT	2100°F (1150°C) for 10 Minutes
UL-2561 1400°F Chimney ULC/ORD-C959 Industrial Type 760°C Chimney	1400°F (760°F) Continuous 1800°F (980°C) Intermittent
UL-1978 Grease Duct	500°F (260°C) Continuous 2000°F (1093°C) for 30 Minutes
UL-1738 Special Gas Vent ULC-S636 Gas Vent	550°F (288°C) Continuous
Optional 400°F UL-1738 Special Gas Vent	400°F (204°C) Continuous
Optional Plastic (PVC, CPVC, PP) Special Gas Vent	148°F (64°C) Continuous for PVC 194°F (90°C) Continuous for CPVC 248°F (120°C) Continuous for PP
UL-441 Gas Vents ULC-S605 Gas Vents	480°F (249°C) Continuous
UL-641 Type L Vent ULC-S609 Vents Type L	570°F (300°C) Continuous
UL-1777 Chimney Liner ULC-S635 Lining Systems for Existing Chimneys	UL-1777: 570°F Continuous ULC-S635: 650°C Continuous

Joint Detail

All Jeremias Inc. models are cylindrical, factory-built, modular venting systems that incorporate a steel to steel conical joint and clamp system for quick and easy assembly in the field.

A Jeremias supplied high temperature ceramic lubricating and assembly paste is applied on the inner wall conical joint to assure the best steel to steel connection.

The double wall models are insulated with 1½" thick fiber (compressed to ¼") or 1¼" cut mineral wool which allows the inner and outer pipes to stay aligned.

Models DWKL/DWKL-Lt/DWKL-Vt Joint Assembly Detail

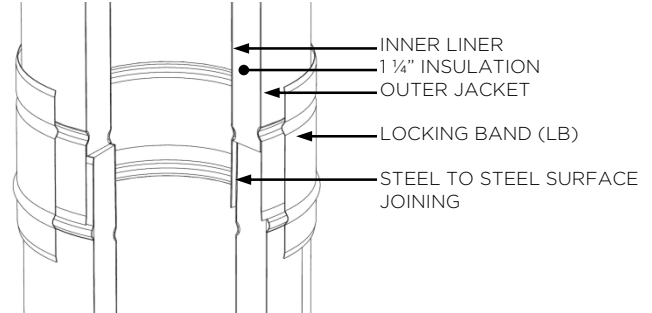

Further features of the Jeremias double wall insulated systems include:

- a) Reduced clearance to combustibles
- b) Reduced outer pipe skin temperatures
- c) Reduced building heat gain
- d) Increased efficiencies of energy recovery systems
- e) Reduced noise levels caused by high velocity exhausts
- f) Enhanced chimney draft

Models SWKL/SWKL-Lt/SWKL-Vt Joint Assembly Detail

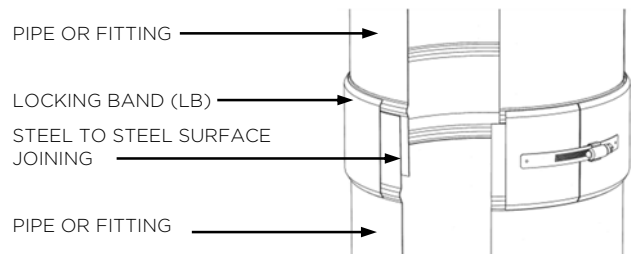

Further features of Jeremias single wall systems include:

- a) No field welding
- b) All stainless steel construction
- c) Smooth flowing inner liner compared to welded steel
- d) Wide array of accessories such as supports and drains
- e) May be interconnected with the double wall models

Sizing/Pressure Calculations

Jeremias' engineering uses its own software based upon the "Chimney, Gas Vent, and Fireplace Systems" chapter of the ASHRAE Handbook to assure that the exhaust and chimney system is sized in accordance with the appliance manufacturers' installation instructions.



TECHNICAL SPECIFICATIONS

Pipe Weight per Foot

The approximate installed weight of the DWKL and SWKL exhaust systems can be found using this table. This table does not include accessories such as supports and guides, nor shipping packaging or palletizing weight.

Inside Diameter	DWKL DWKL-Rx	SWKL	DWKL-Vt DWKL-Lt	SWKL-Vt SWKL-Lt
3" (76mm)	3.5 (5.1)	1.1 (1.7)	3.0 (4.4)	0.6 (1.0)
4" (102mm)	4.4 (6.5)	1.5 (2.2)	3.8 (5.7)	0.9 (1.3)
5" (127mm)	5.3 (7.9)	1.9 (2.8)	4.4 (6.5)	1.1 (1.6)
6" (152mm)	6.3 (9.3)	2.2 (3.3)	5.4 (8.0)	1.3 (1.9)
7" (178 mm)	7.2 (10.7)	2.6 (3.9)	6.1 (9.1)	1.5 (2.2)
8" (203mm)	8.1 (12.1)	3.0 (4.4)	6.8 (10.1)	1.7 (2.5)
9" (229mm)	9.1 (13.5)	3.4 (5.0)	7.6 (11.3)	1.9 (2.8)
10" (254mm)	10.0 (14.9)	3.7 (5.6)	8.4 (12.5)	2.1 (3.2)
11" (249mm)	10.9 (16.3)	4.1 (6.1)	9.1 (13.5)	2.3 (3.5)
12" (305mm)	11.9 (17.7)	4.5 (6.7)	10.0 (14.9)	2.6 (3.8)
13" (330mm)	12.8 (19.1)	4.9 (7.2)	10.7 (15.9)	2.8 (4.1)
14" (456mm)	13.8 (20.5)	5.2 (7.8)	11.6 (17.3)	3.0 (4.4)
16" (406mm)	15.6 (23.2)	6.0 (8.9)	13 (19.3)	3.4 (5.1)
18" (457mm)	17.5 (26.0)	6.7 (10.0)	14.6 (21.7)	3.8 (5.7)
20" (508mm)	19.4 (28.8)	7.5 (11.1)	16.2 (24.1)	4.3 (6.3)
22" (559mm)	21.3 (31.6)	8.2 (12.2)	17.8 (26.5)	4.7 (5.0)
24" (610mm)	23.1 (34.3)	9.0 (13.3)	19.2 (28.6)	5.1 (7.6)

KL Paste

KL Paste is a ceramic lubricating and assembly paste. The purpose is to help guide the pipe connections to assure the best steel to steel connection. It also seals the joint by allowing the ceramic to fill any microscopic steel imperfections. On fittings it will help the installer rotate to the correct position before tapping in place.

Use 1 teaspoon of paste per 24" length of joint perimeter. Example: 10 inch diameter has 31" of perimeter length, so use about 1.3 teaspoons per each 10 inch joint connection. Below table allows for a 20% waste.

Table 1-1, No. (#) of Joints per 3.5 oz. Tube

Ø	3"	4"	5"	6"	7"	8"	9"	10"
#	42.6	32.0	25.6	21.3	18.2	16.0	14.2	12.8
11"	12"	13"	14"	16"	18"	20"	22"	24"
11.6	10.6	9.8	9.1	8.0	7.1	6.4	5.8	5.3

Submittal and Warranted Designs

Jeremias also provides CAD layout designs that show all required accessories, including drains, supports, access panels, etc., to be in accordance with any specific appliance manufacturers' installation instructions.

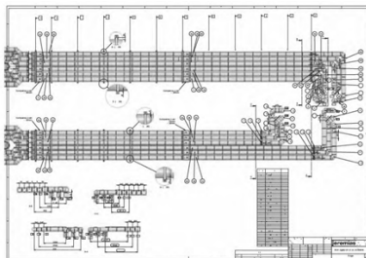

Joint Assembly

The Jeremias double wall models joint system is designed for a quick and easy installation. Follow Steps 1 through 4 for general pipe and fittings assembly.

Models DWKL/DWKL-Lt/DWKL-Vt Joint Assembly

Step 1

Clean the inner side of the female end and the outer side of the male end of each pipe. Apply the KL Paste to the female inner liner.

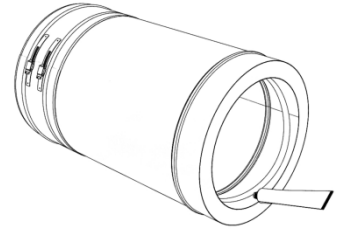

Step 2

Use your hands to center both pipes in alignment. Connect both pipes and press them together as much as possible by hand.

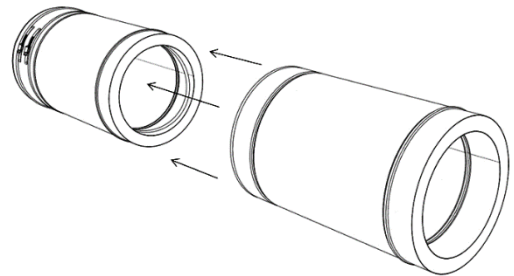

Step 3

Use the wood plate (supplied with shipment) and place it on the end of the assembly.

Tap 2-3 times. Make sure to press both inner and outer pipes together; the inner should not be more than 1/8" longer than the outer pipe once the male/female conical ends are engaged.

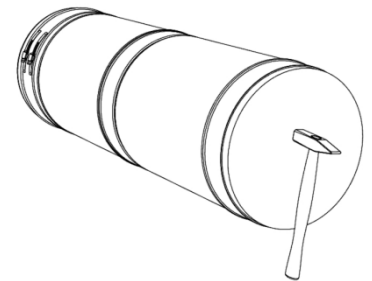

Step 4

Install and fix the Locking Band (LB). To ensure the connection is secure, the Locking Band must be perfectly fitted in both grooves.

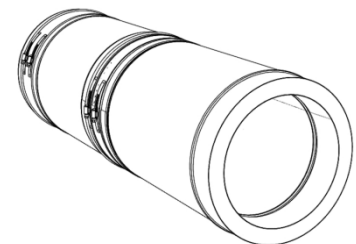

The single wall models have exactly the same joint as the inner portion of the above double wall models. Use the same installation procedures for both systems.

SAMPLE SYSTEMS

SAMPLE 1 - DWKL ENGINE EXHAUST THREE (3) 14" I.D. / 16 1/2" O.D. EXHAUST SYSTEMS

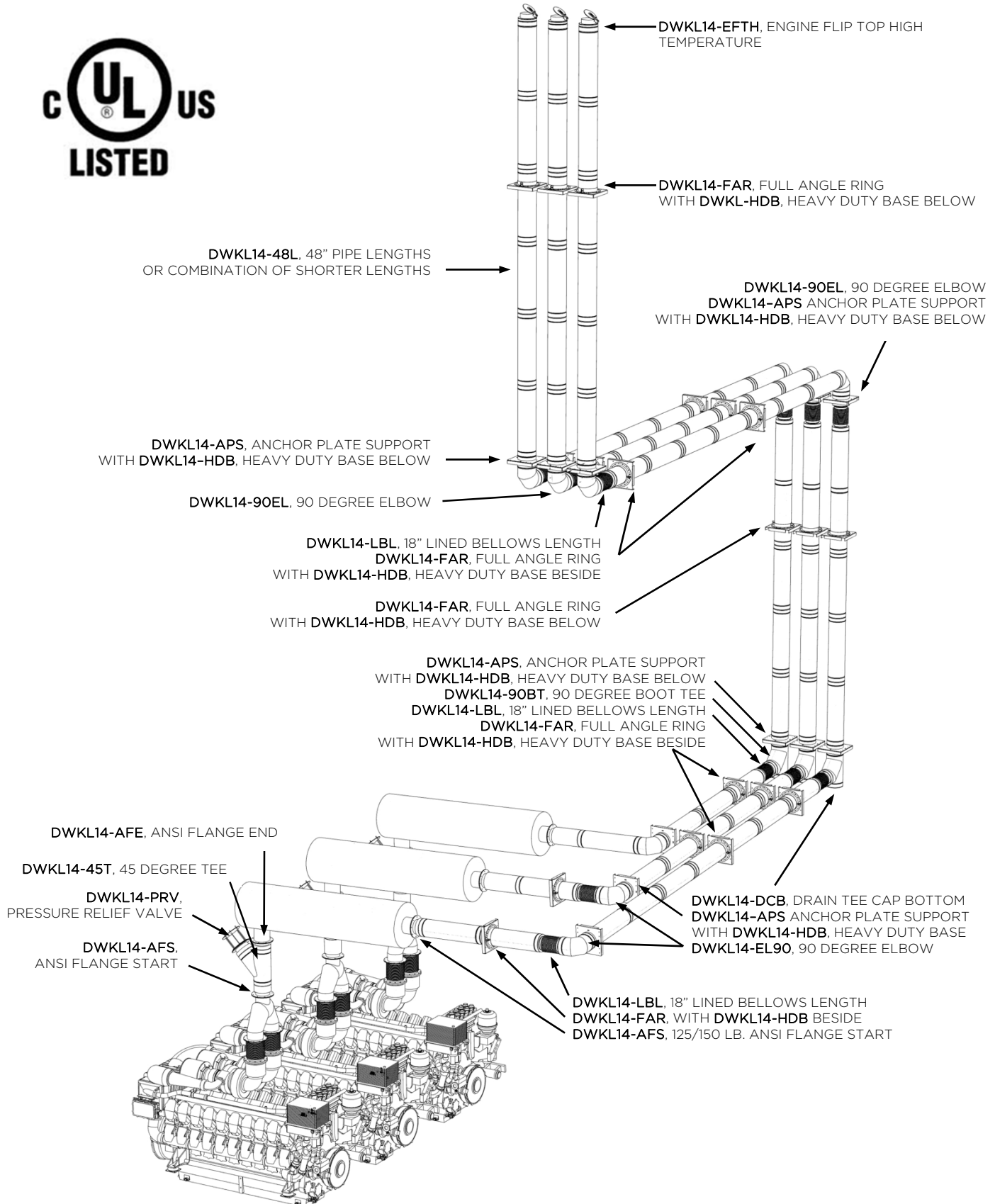

SAMPLE SYSTEMS

SAMPLE 2 - DWKL BOILER STACK

TWO (2) 16" I.D. INTO 20" I.D. / 22 ½" O.D. STACK

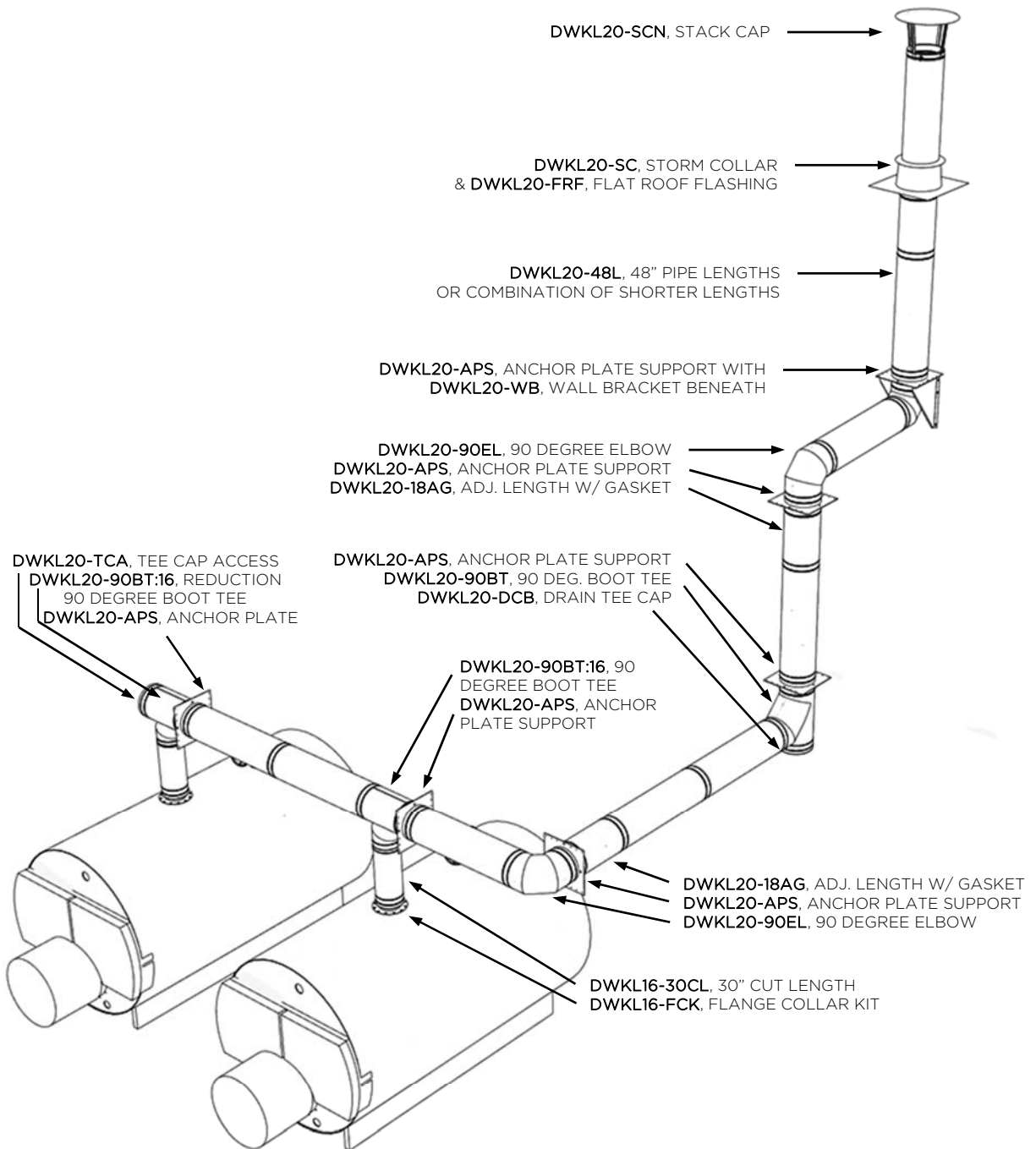

SAMPLE SYSTEMS

SAMPLE 3 - SWKL FUME HOOD VENT

THREE (3) 8" I.D. INTO 10" I.D. AND 14" I.D. SINGLE WALL EXHAUST

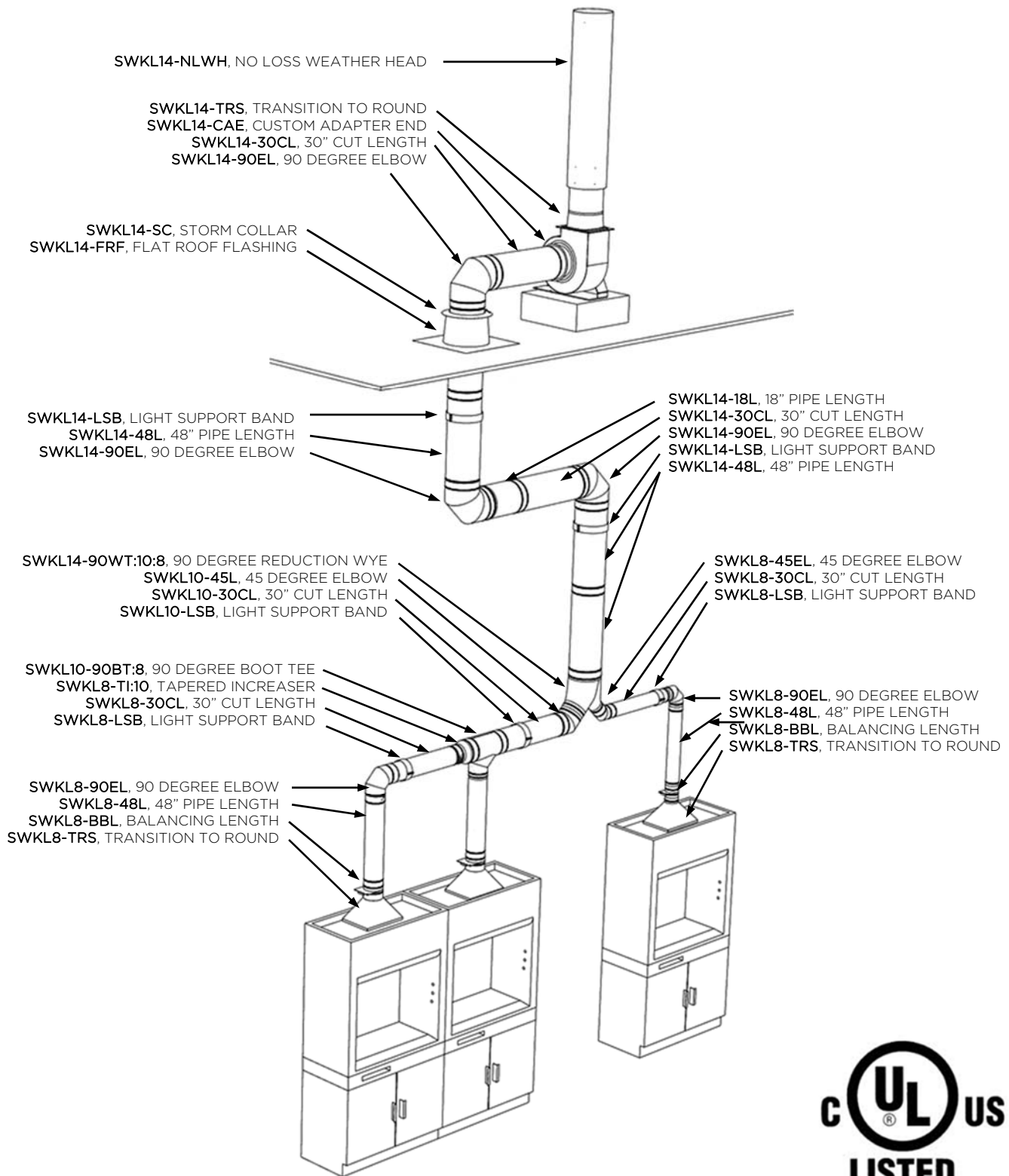

SAMPLE SYSTEMS

SAMPLE 4 - DWKL COMMERCIAL GREASE DUCT 2X 14", INTO 20", 1X 8", INTO COMMON 24" GREASE DUCT

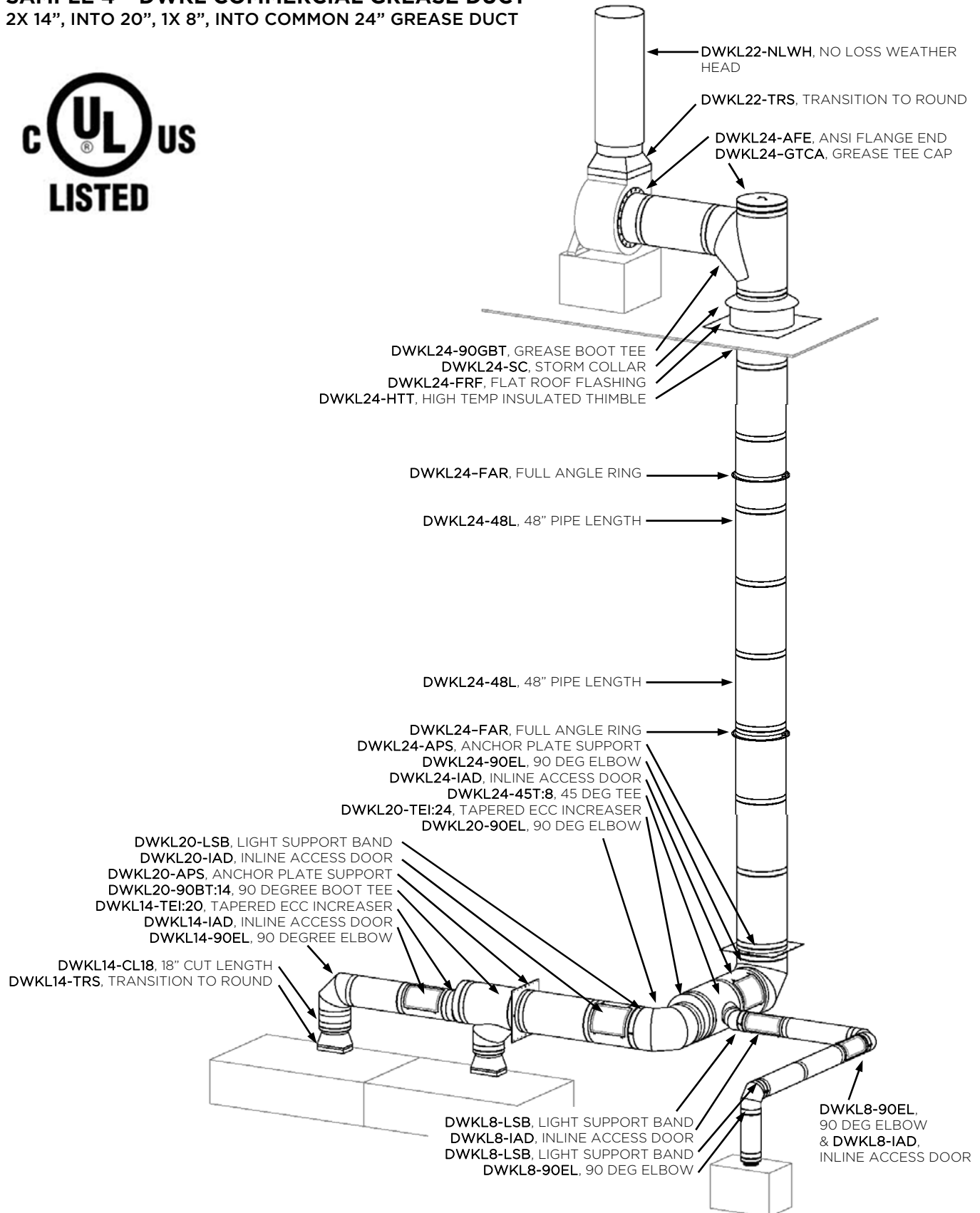

SAMPLE SYSTEMS

SAMPLE 5 - DWKL PIZZA OVEN CHIMNEY & GREASE DUCT

10" I.D. / 12½" O.D. CHIMNEY AND GREASE DUCT

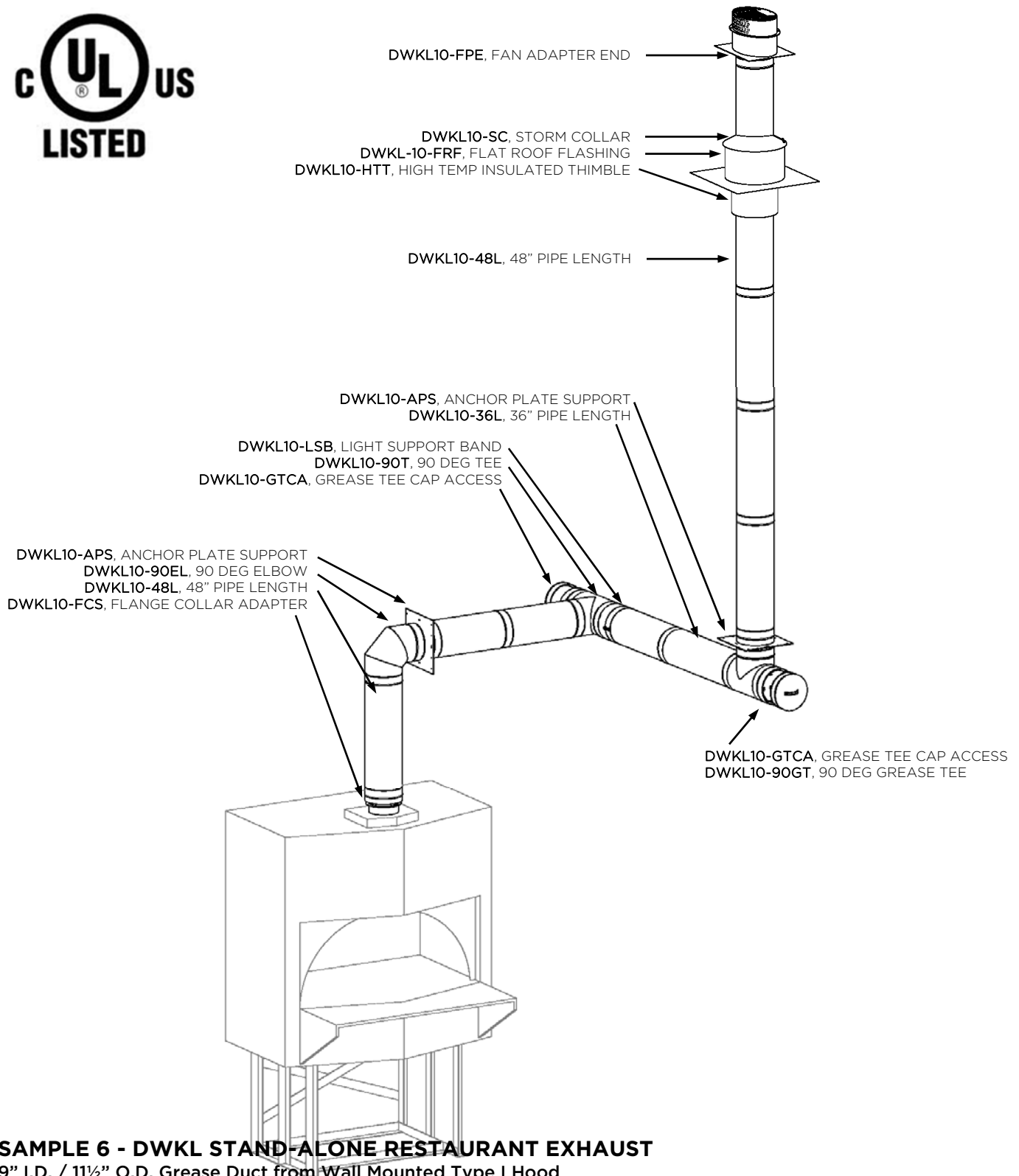

SAMPLE 6 - DWKL STAND-ALONE RESTAURANT EXHAUST

9" I.D. / 11½" O.D. Grease Duct from Wall Mounted Type I Hood

SAMPLE SYSTEMS

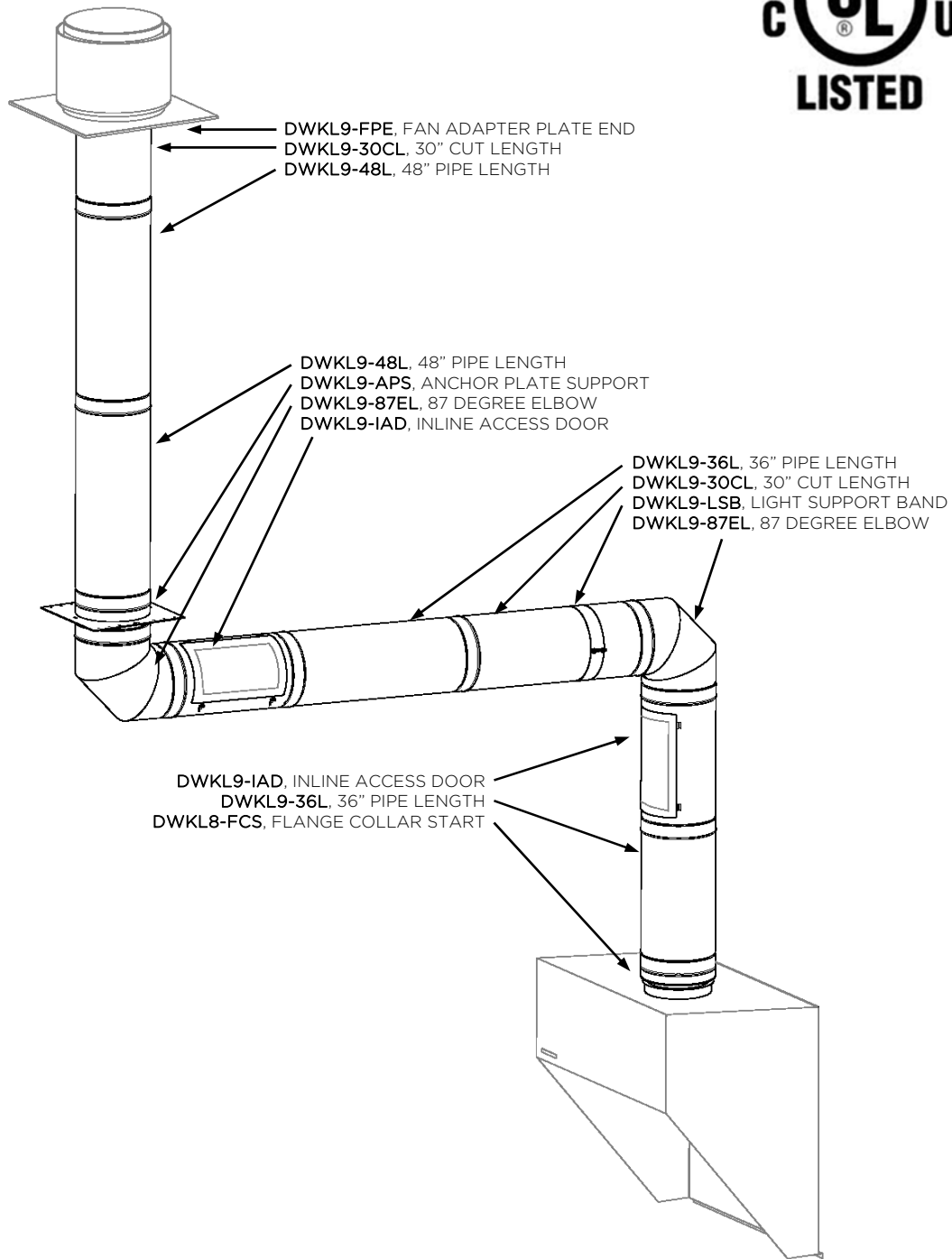

SAMPLE 7 - SWKL COMMERCIAL DISHWASHER EXHAUST
 2X 8" INTO 12" I.D. DISHWASHER EXHAUST

SAMPLE SYSTEMS

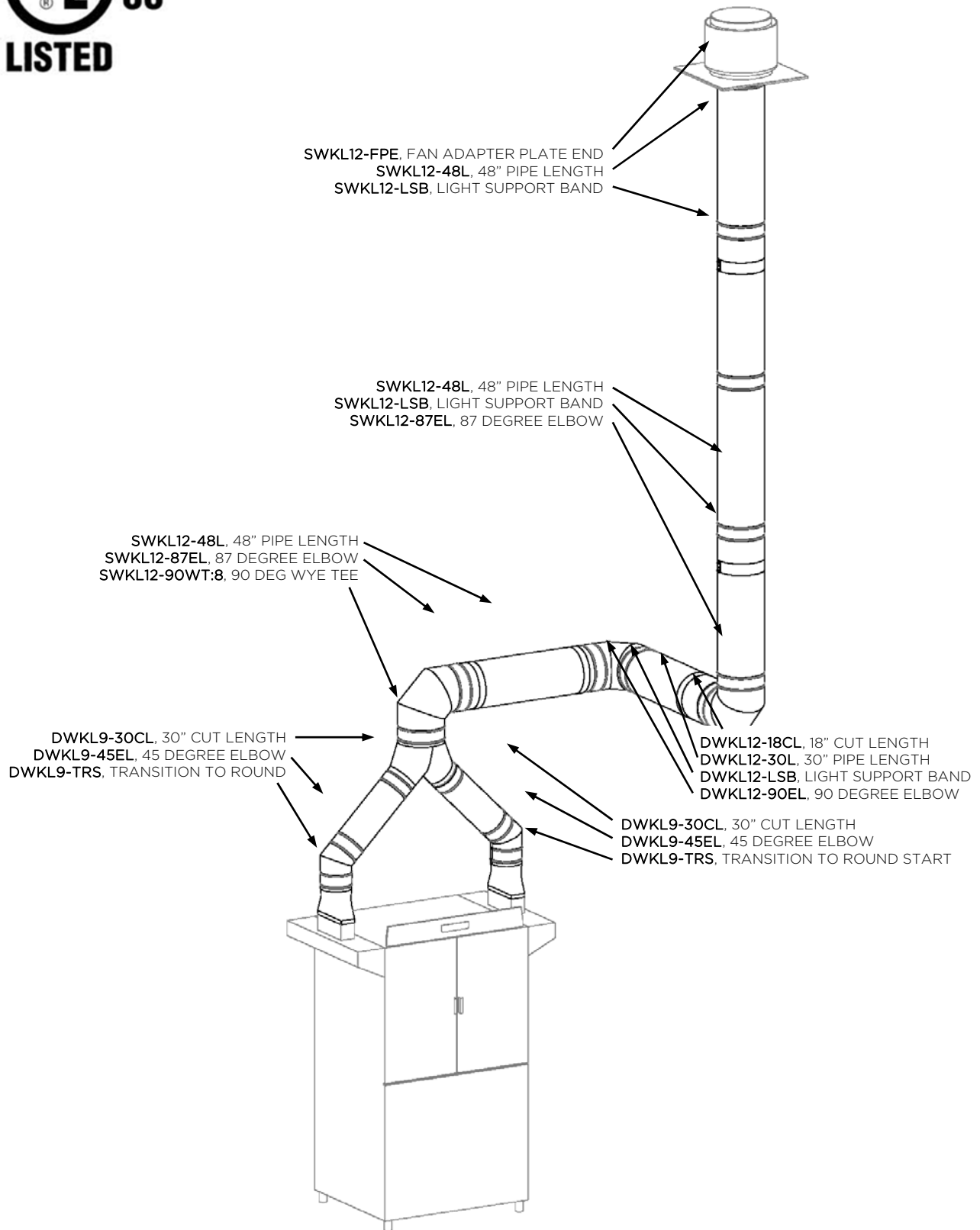

SAMPLE SYSTEMS

SAMPLE 8 - SWKL CATEGORY III OR IV SIDEWALL 4X 10" I.D. SIDEWALL VENTED

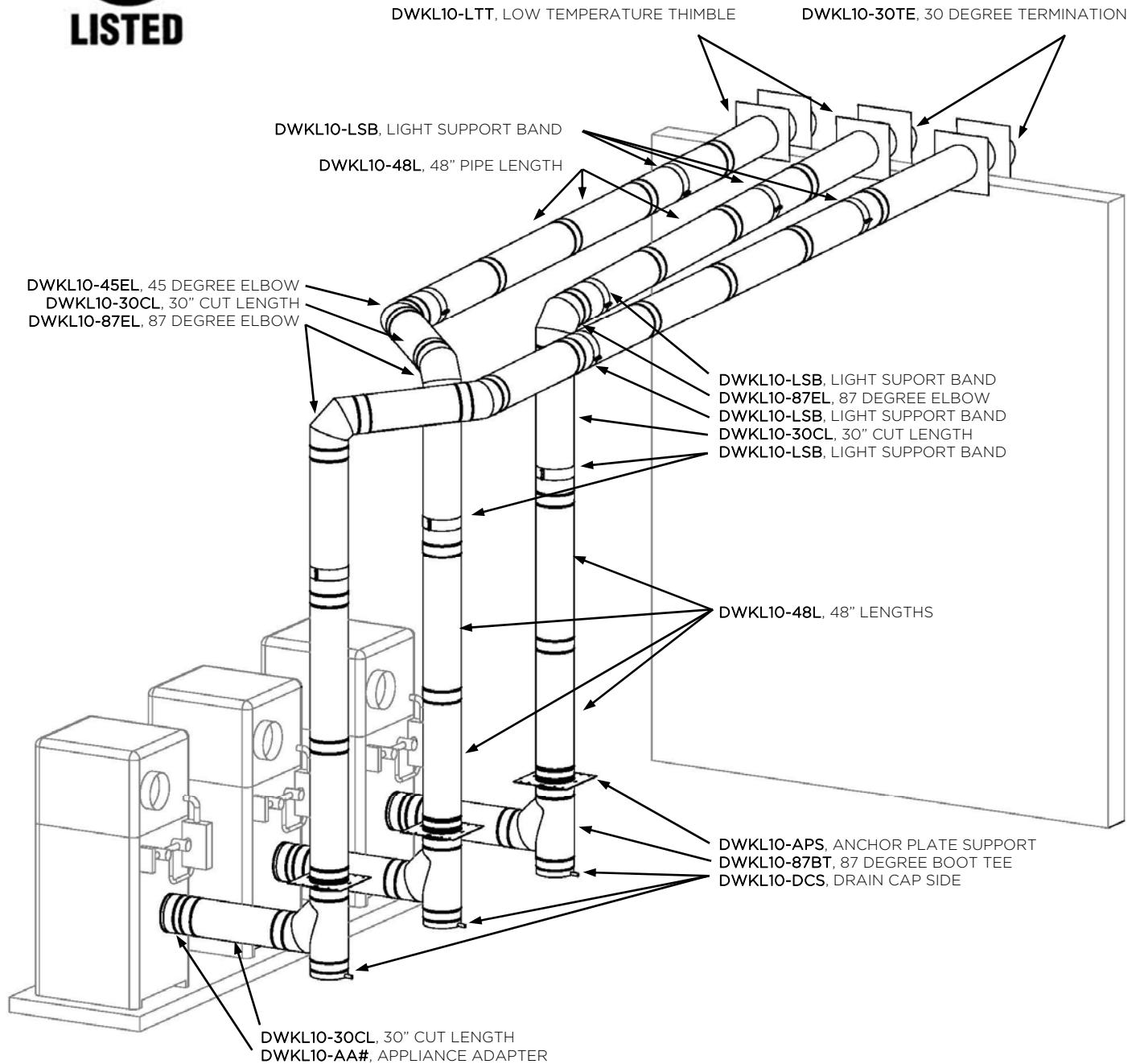

SAMPLE SYSTEMS

SAMPLE 9 - DWKL/SWKL SEALED COMBUSTION

4X 4" I.D. DWKL VERTICALLY VENTED WITH SWKL SIDEWALL INTAKES

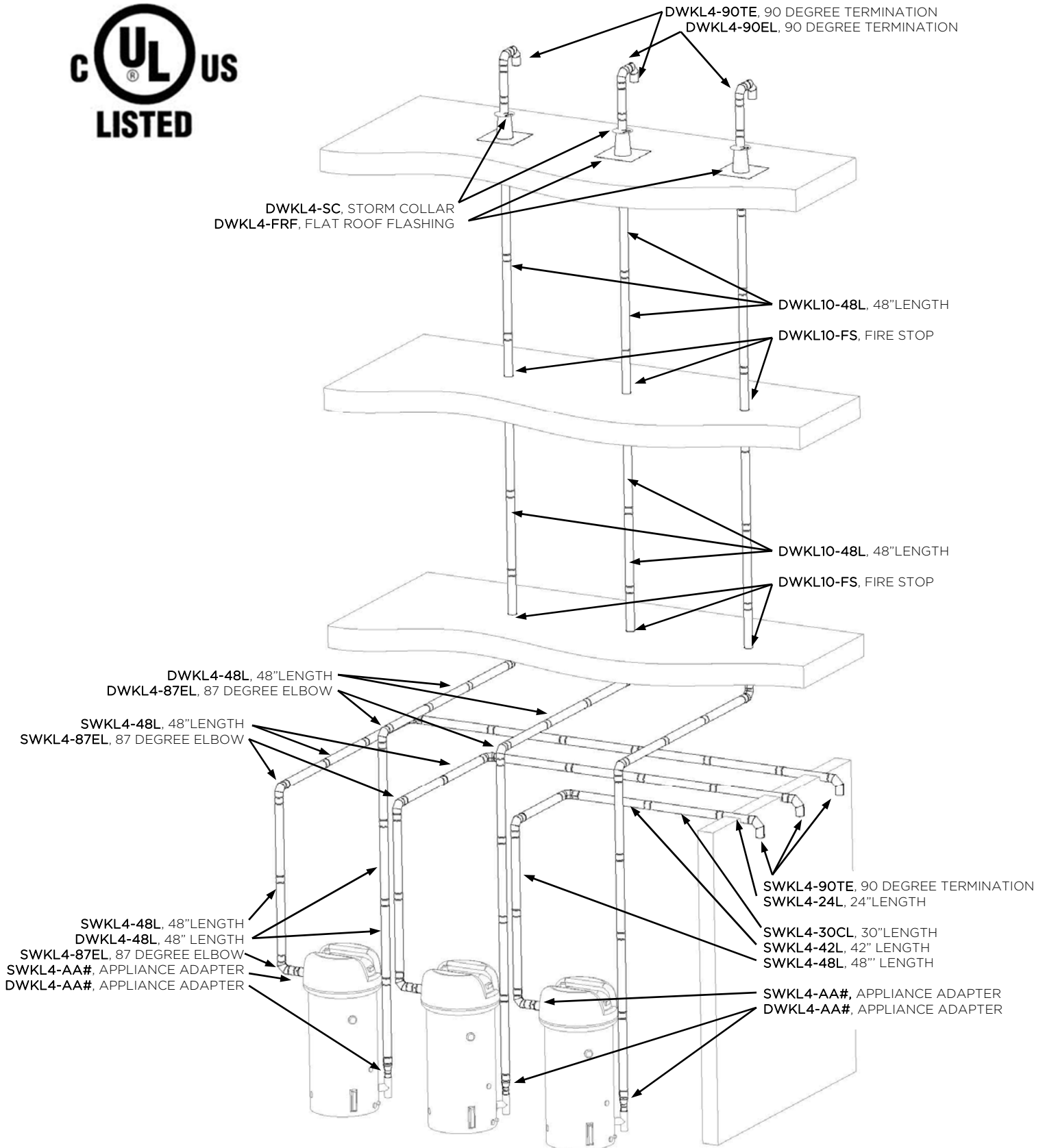

SAMPLE SYSTEMS

SAMPLE 10 -SWKL COMMERCIAL LAUNDRY DRYER EXHAUST 3X 8" I.D. INTO COMMON 16" I.D. WITH INLINE FILTER AND FAN

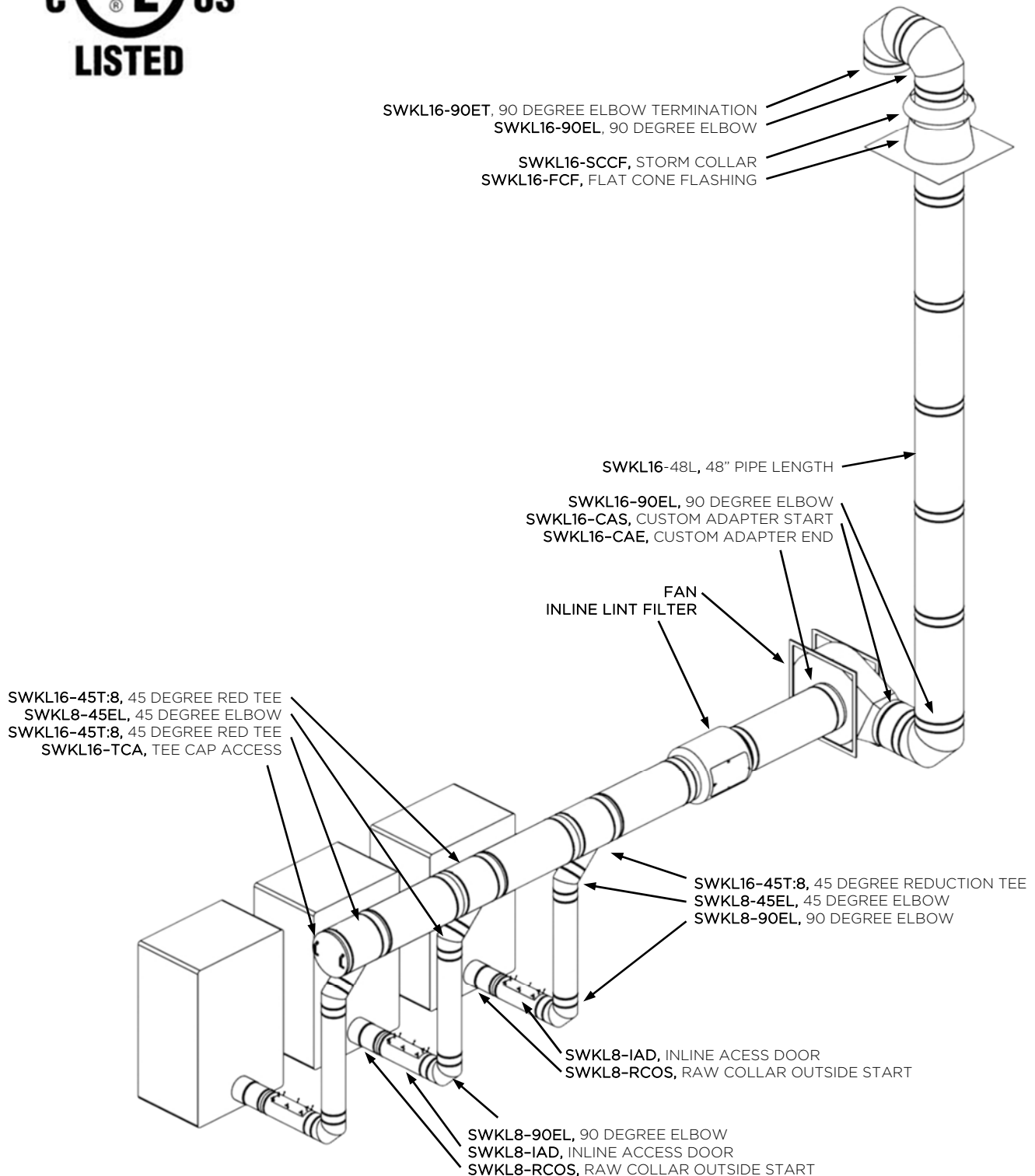

SAMPLE SYSTEMS

SAMPLE 11 - SWKL CHIMNEY LINER 12" SWKL CHIMNEY LINER

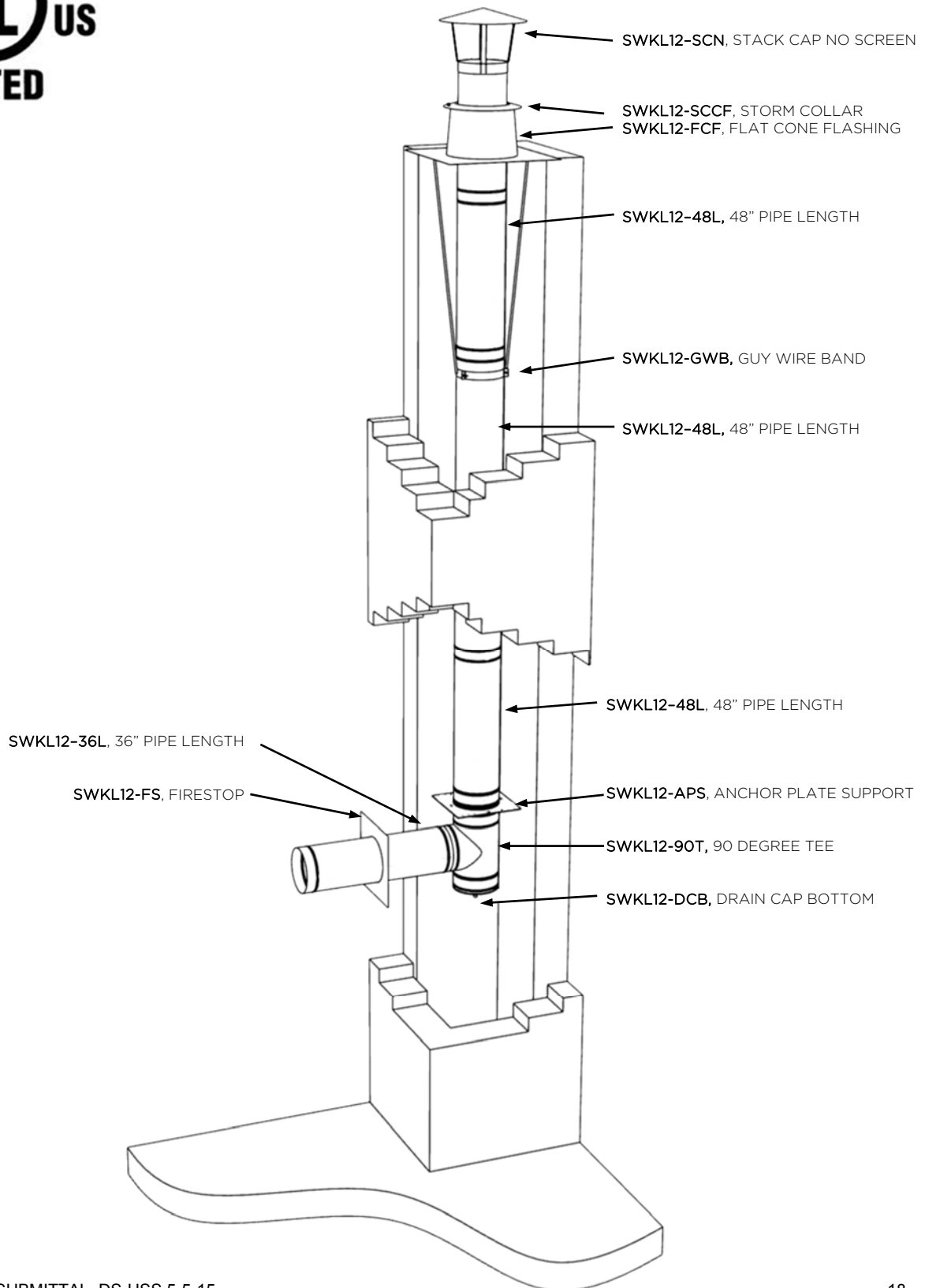

APS Anchor Plate Support

A Ø	B Ø	C
3	5.50	11.50
4	6.50	12.50
5	7.50	13.50
6	8.50	14.50
7	9.50	15.50
8	10.50	16.50
9	11.50	17.50
10	12.50	18.50
11	13.50	19.50
12	14.50	20.50
13	15.50	21.50
14	16.50	22.50
16	18.50	24.50
18	20.50	26.50
20	22.50	28.50
22	24.50	30.50
24	26.50	32.50

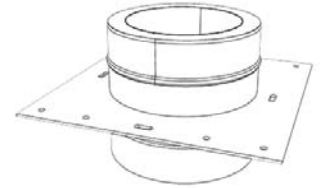
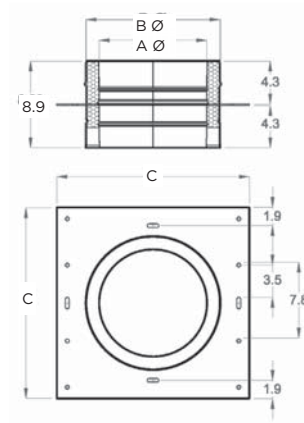

HDB Heavy Duty Base for Anchor Plate Support and Full Angle Ring

Pipe Ø	A Ø	B Ø	C
3	5.50	7.80	11.50
4	6.50	8.80	12.50
5	7.50	9.80	13.50
6	8.50	10.80	14.50
7	9.50	11.80	15.50
8	10.50	12.80	16.50
9	11.50	13.80	17.50
10	12.50	14.80	18.50
11	13.50	15.80	19.50
12	14.50	16.80	20.50
13	15.50	17.80	21.50
14	16.50	18.80	22.50
16	18.50	20.80	24.50
18	20.50	22.80	26.50
20	22.50	24.80	28.50
22	24.50	26.80	30.50
24	26.50	28.80	32.50

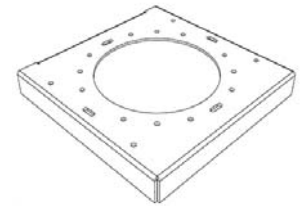
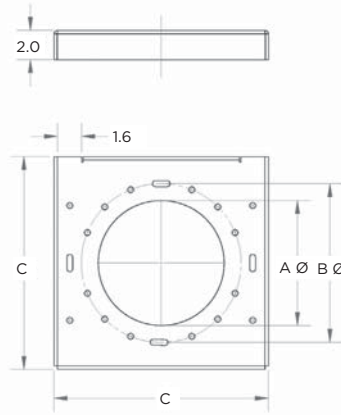

WB Wall Brackets for Anchor Plate Support and Full Angle Ring

Pipe Ø	A	B
3	19.7	10.6
4	19.7	10.6
5	19.7	11.2
6	21.1	11.8
7	22.2	12.9
8	22.2	13.7
9	22.2	13.7
10	24.2	15.7
11	24.2	16.7
12	24.2	17.7
13	26.2	18.6
14	26.2	19.6
16	26.2	21.6
18	28.1	23.6
20	28.1	25.5
22	30.1	27.5
24	30.1	29.5

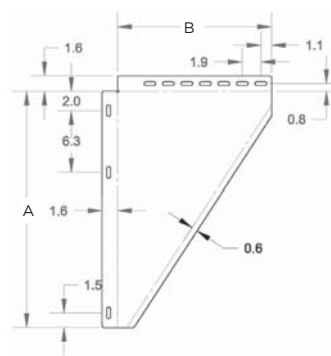

FAR Full Angle Ring

Pipe Ø	A Ø	B Ø	C Ø
3	5.50	7.80	9.50
4	6.50	8.80	10.50
5	7.50	9.80	11.50
6	8.50	10.80	12.50
7	9.50	11.80	13.50
8	10.50	12.80	14.50
9	11.50	13.80	15.50
10	12.50	14.80	16.50
11	13.50	15.80	17.50
12	14.50	16.80	18.50
13	15.50	17.80	19.50
14	16.50	18.80	20.50
16	18.50	20.80	22.50
18	20.50	22.80	24.50
20	22.50	24.80	26.50
22	24.50	26.80	28.50
24	26.50	28.80	30.50

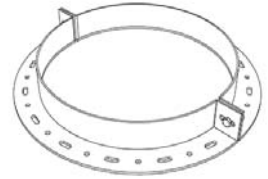
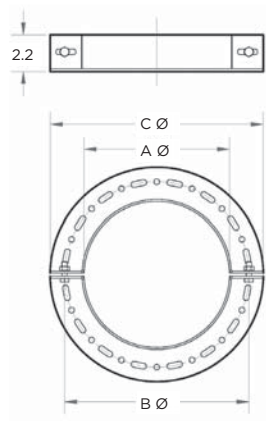

HAR Half Angle Ring

Pipe Ø	A Ø	B Ø	C Ø
3	5.50	7.80	9.50
4	6.50	8.80	10.50
5	7.50	9.80	11.50
6	8.50	10.80	12.50
7	9.50	11.80	13.50
8	10.50	12.80	14.50
9	11.50	13.80	15.50
10	12.50	14.80	16.50
11	13.50	15.80	17.50
12	14.50	16.80	18.50
13	15.50	17.80	19.50
14	16.50	18.80	20.50
16	18.50	20.80	22.50
18	20.50	22.80	24.50
20	22.50	24.80	26.50
22	24.50	26.80	28.50
24	26.50	28.80	30.50

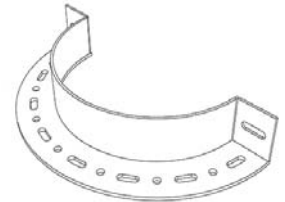
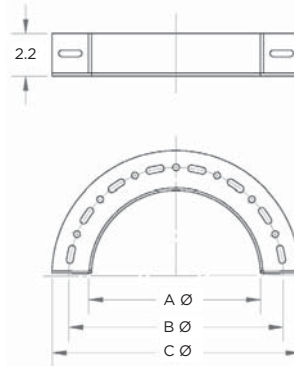

LSB Light Support Band

Pipe Ø	A Ø
3	5.50
4	6.50
5	7.50
6	8.50
7	9.50
8	10.50
9	11.50
10	12.50
11	13.50
12	14.50
13	15.50
14	16.50
16	18.50
18	20.50
20	22.50
22	24.50
24	26.50

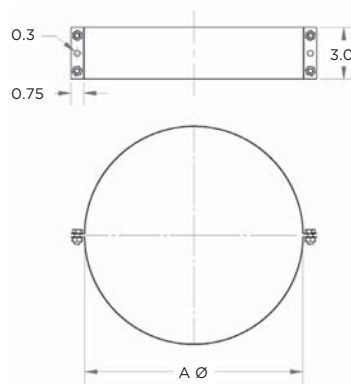

GWB Guy Wires Band

Pipe Ø	A Ø
3	5.50
4	6.50
5	7.50
6	8.50
7	9.50
8	10.50
9	11.50
10	12.50
11	13.50
12	14.50
13	15.50
14	16.50
16	18.50
18	20.50
20	22.50
22	24.50
24	26.50

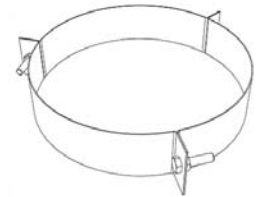
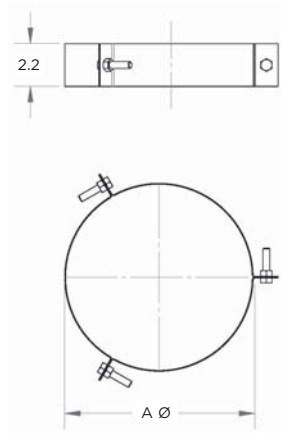

6L 6" Fixed Pipe Length

A Ø	B Ø
3	5.50
4	6.50
5	7.50
6	8.50
7	9.50
8	10.50
9	11.50
10	12.50
11	13.50
12	14.50
13	15.50
14	16.50
16	18.50
18	20.50
20	22.50
22	24.50
24	26.50

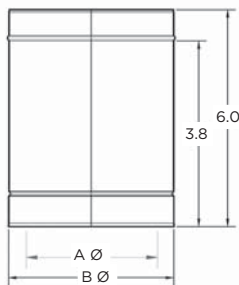

9L 9" Fixed Pipe Length

A Ø	B Ø
3	5.50
4	6.50
5	7.50
6	8.50
7	9.50
8	10.50
9	11.50
10	12.50
11	13.50
12	14.50
13	15.50
14	16.50
16	18.50
18	20.50
20	22.50
22	24.50
24	26.50

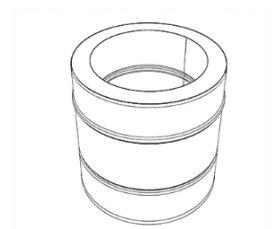
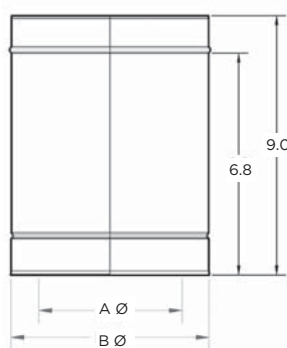

12L 12” Fixed Pipe Length

A Ø	B Ø
3	5.50
4	6.50
5	7.50
6	8.50
7	9.50
8	10.50
9	11.50
10	12.50
11	13.50
12	14.50
13	15.50
14	16.50
16	18.50
18	20.50
20	22.50
22	24.50
24	26.50

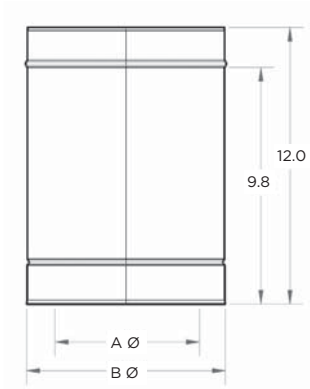

18L 18” Fixed Pipe Length

A Ø	B Ø
3	5.50
4	6.50
5	7.50
6	8.50
7	9.50
8	10.50
9	11.50
10	12.50
11	13.50
12	14.50
13	15.50
14	16.50
16	18.50
18	20.50
20	22.50
22	24.50
24	26.50

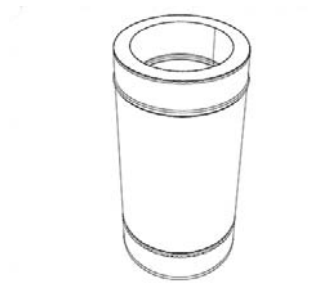
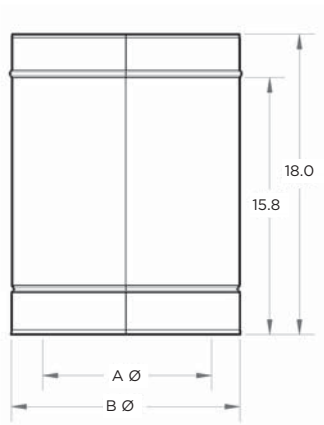

24L 24” Fixed Pipe Length

A Ø	B Ø
3	5.50
4	6.50
5	7.50
6	8.50
7	9.50
8	10.50
9	11.50
10	12.50
11	13.50
12	14.50
13	15.50
14	16.50
16	18.50
18	20.50
20	22.50
22	24.50
24	26.50

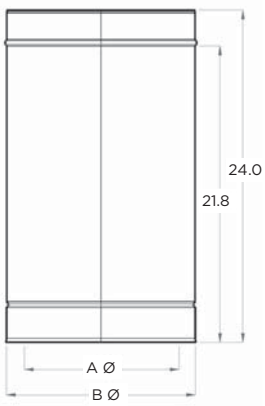

30L 30" Fixed Pipe Length

A Ø	B Ø
3	5.50
4	6.50
5	7.50
6	8.50
7	9.50
8	10.50
9	11.50
10	12.50
11	13.50
12	14.50
13	15.50
14	16.50
16	18.50
18	20.50
20	22.50
22	24.50
24	26.50

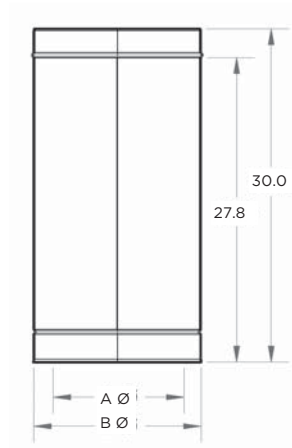

36L 36" Fixed Pipe Length

A Ø	B Ø
3	5.50
4	6.50
5	7.50
6	8.50
7	9.50
8	10.50
9	11.50
10	12.50
11	13.50
12	14.50
13	15.50
14	16.50
16	18.50
18	20.50
20	22.50
22	24.50
24	26.50

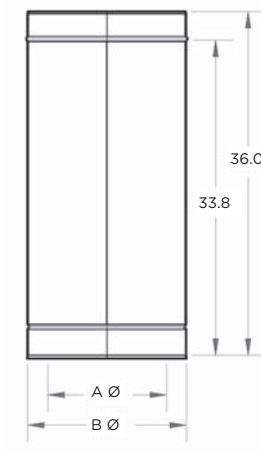

42L 42" Fixed Pipe Length

A Ø	B Ø
3	5.50
4	6.50
5	7.50
6	8.50
7	9.50
8	10.50
9	11.50
10	12.50
11	13.50
12	14.50
13	15.50
14	16.50
16	18.50
18	20.50
20	22.50
22	24.50
24	26.50

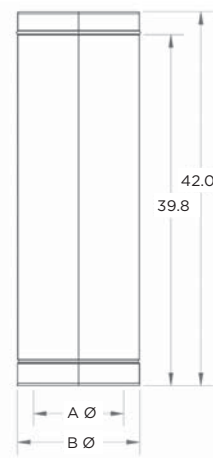

48L 48" Fixed Pipe Length

A Ø	B Ø
3	5.50
4	6.50
5	7.50
6	8.50
7	9.50
8	10.50
9	11.50
10	12.50
11	13.50
12	14.50
13	15.50
14	16.50
16	18.50
18	20.50
20	22.50
22	24.50
24	26.50

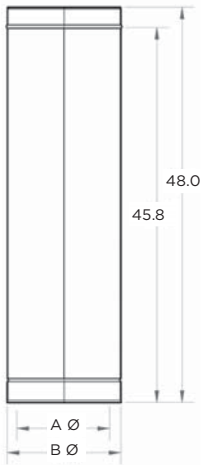

UDL Universal Drain Length

A Ø	B Ø
3	5.50
4	6.50
5	7.50
6	8.50
7	9.50
8	10.50
9	11.50
10	12.50
11	13.50
12	14.50
13	15.50
14	16.50
16	18.50
18	20.50
20	22.50
22	24.50
24	26.50

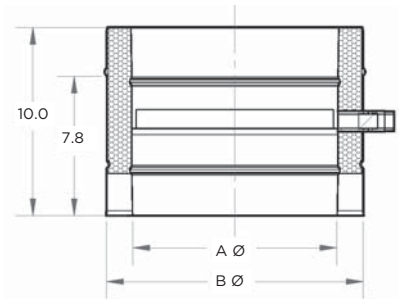

TPL Test and Nozzle Port Length

A Ø	B Ø
3	5.50
4	6.50
5	7.50
6	8.50
7	9.50
8	10.50
9	11.50
10	12.50
11	13.50
12	14.50
13	15.50
14	16.50
16	18.50
18	20.50
20	22.50
22	24.50
24	26.50

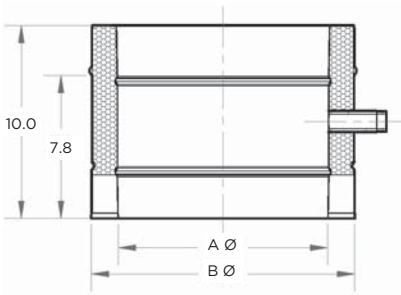

18CL 18" Cut Pipe Length

A Ø	B Ø
3	5.50
4	6.50
5	7.50
6	8.50
7	9.50
8	10.50
9	11.50
10	12.50
11	13.50
12	14.50
13	15.50
14	16.50
16	18.50
18	20.50
20	22.50
22	24.50
24	26.50

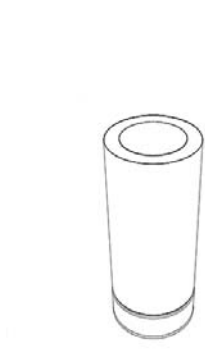
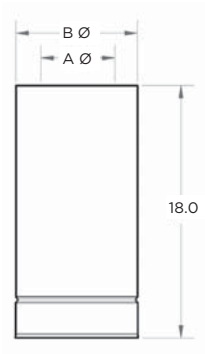

30CL 30" Cut Pipe Length

A Ø	B Ø
3	5.50
4	6.50
5	7.50
6	8.50
7	9.50
8	10.50
9	11.50
10	12.50
11	13.50
12	14.50
13	15.50
14	16.50
16	18.50
18	20.50
20	22.50
22	24.50
24	26.50

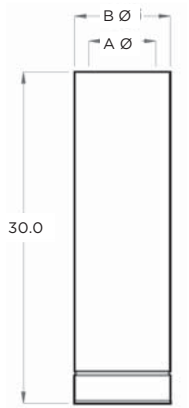

18AL 18" Adjustable Length

A Ø	B Ø
3	5.50
4	6.50
5	7.50
6	8.50
7	9.50
8	10.50
9	11.50
10	12.50
11	13.50
12	14.50
13	15.50
14	16.50
16	18.50
18	20.50
20	22.50
22	24.50
24	26.50

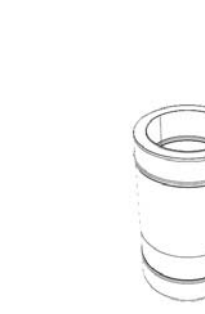
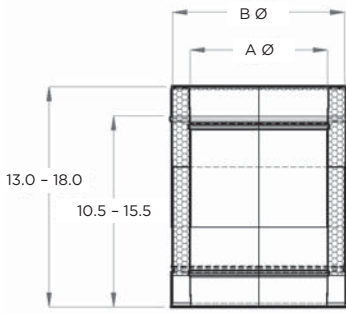

30AL 30" Adjustable Length

A Ø	B Ø
3	5.50
4	6.50
5	7.50
6	8.50
7	9.50
8	10.50
9	11.50
10	12.50
11	13.50
12	14.50
13	15.50
14	16.50
16	18.50
18	20.50
20	22.50
22	24.50
24	26.50

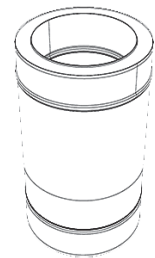
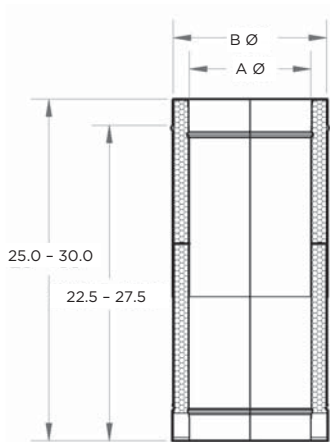

18AG 18" Adjustable Length w/ Gasket

A Ø	B Ø
3	5.50
4	6.50
5	7.50
6	8.50
7	9.50
8	10.50
9	11.50
10	12.50
11	13.50
12	14.50
13	15.50
14	16.50
16	18.50
18	20.50
20	22.50
22	24.50
24	26.50

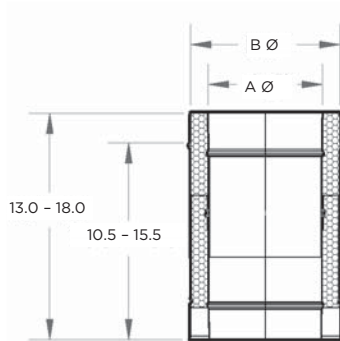

30AG 30" Adjustable Length w/ Gasket

A Ø	B Ø
3	5.50
4	6.50
5	7.50
6	8.50
7	9.50
8	10.50
9	11.50
10	12.50
11	13.50
12	14.50
13	15.50
14	16.50
16	18.50
18	20.50
20	22.50
22	24.50
24	26.50

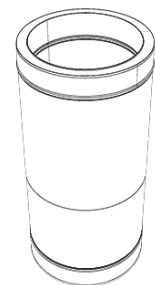
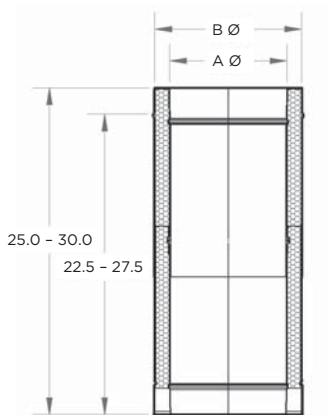

LBL 18" Lined Bellows Length

A Ø	B Ø
3	5.50
4	6.50
5	7.50
6	8.50
7	9.50
8	10.50
9	11.50
10	12.50
11	13.50
12	14.50
13	15.50
14	16.50
16	18.50
18	20.50
20	22.50
22	24.50
24	26.50

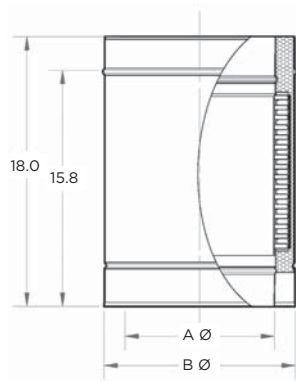

15EL 15° Elbow

A Ø	B Ø	C	D
3	5.50	4.70	2.41
4	6.50	4.77	2.48
5	7.50	4.83	2.55
6	8.50	4.90	2.61
7	9.50	4.96	2.68
8	10.50	5.03	2.74
9	11.50	5.09	2.81
10	12.50	5.16	2.88
11	13.50	5.23	2.95
12	14.50	5.29	3.01
13	15.50	5.36	3.08
14	16.50	5.42	3.14
16	18.50	5.56	3.27
18	20.50	5.59	3.40
20	22.50	5.82	3.53
22	24.50	5.95	3.67
24	26.50	6.08	3.80

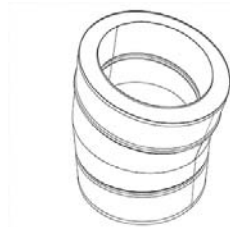
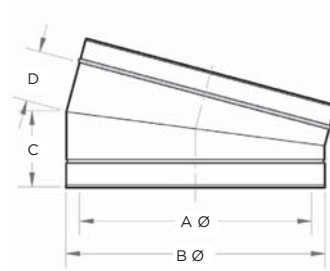

30EL 30° Elbow

A Ø	B Ø	C	D
3	5.50	5.08	2.80
4	6.50	5.22	2.93
5	7.50	5.35	3.07
6	8.50	5.48	3.20
7	9.50	5.62	3.33
8	10.50	5.75	3.47
9	11.50	5.89	3.60
10	12.50	6.02	3.74
11	13.50	6.15	3.87
12	14.50	6.29	4.00
13	15.50	6.42	4.14
14	16.50	6.56	4.27
16	18.50	6.82	4.54
18	20.50	7.09	4.81
20	22.50	7.36	5.07
22	24.50	7.63	5.34
24	26.50	7.90	5.61

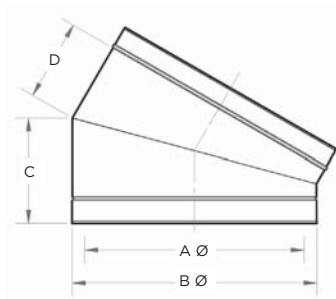

45EL 45° Elbow

A Ø	B Ø	C	D
3	5.50	5.49	3.21
4	6.50	5.70	3.41
5	7.50	5.91	3.62
6	8.50	6.11	3.83
7	9.50	6.32	4.04
8	10.50	6.53	4.24
9	11.50	6.74	4.45
10	12.50	6.94	4.66
11	13.50	7.15	4.86
12	14.50	7.36	5.07
13	15.50	7.56	5.28
14	16.50	7.77	5.49
16	18.50	8.18	5.90
18	20.50	8.60	6.31
20	22.50	9.01	6.73
22	24.50	9.43	7.14
24	26.50	9.84	7.56

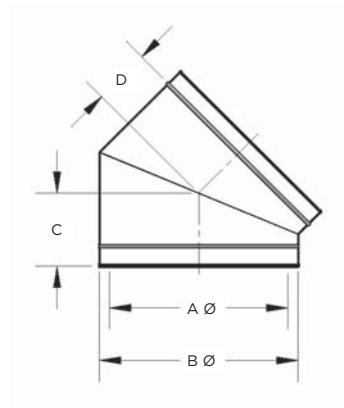

90EL 90° Elbow

A Ø	B Ø	C	D
3	5.50	8.25	5.96
4	6.50	8.75	6.46
5	7.50	9.25	6.96
6	8.50	9.75	7.46
7	9.50	10.25	7.96
8	10.50	10.75	8.46
9	11.50	11.25	8.96
10	12.50	11.75	9.46
11	13.50	12.25	9.96
12	14.50	12.75	10.46
13	15.50	13.25	10.96
14	16.50	13.75	11.46
16	18.50	14.75	12.46
18	20.50	15.75	13.46
20	22.50	16.75	14.46
22	24.50	17.75	15.46
24	26.50	18.75	16.46

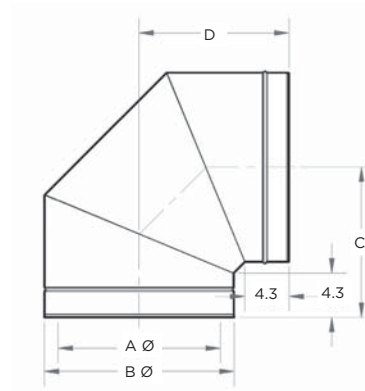

45T 45 Degree Tee

A Ø	B Ø	C	D	E	F	G	H
3	5.50	7.78	3.22	11.10	8.90	16.60	11.10
4	6.50	8.64	3.58	12.30	10.10	18.00	12.30
5	7.50	9.49	3.93	13.50	11.30	19.40	13.50
6	8.50	10.35	4.29	14.70	12.50	20.80	14.70
7	9.50	11.20	4.64	15.90	13.70	22.20	15.90
8	10.50	12.05	4.99	17.10	14.90	23.60	17.10
9	11.50	12.91	5.35	18.30	16.10	25.00	18.30
10	12.50	13.76	5.70	19.50	17.30	26.50	19.50
11	13.50	14.61	6.05	20.70	18.50	27.90	20.70
12	14.50	15.47	6.41	21.90	19.70	29.30	21.90
13	15.50	16.36	6.76	23.10	20.90	30.70	23.10
14	16.50	17.17	7.11	24.30	22.10	32.10	24.30
16	18.50	18.88	7.82	26.70	24.50	34.90	26.70
18	20.50	20.59	8.53	29.10	26.90	37.80	29.10
20	22.50	22.29	9.23	31.60	29.40	40.60	31.60
22	24.50	24.00	9.94	34.00	31.80	43.40	34.00
24	26.50	25.71	10.65	36.40	34.20	46.30	36.40

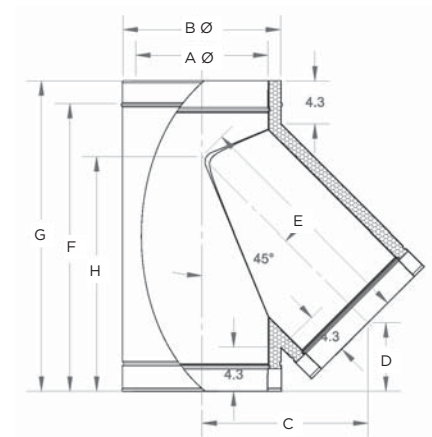

90T 90° Tee

A Ø	B Ø	C	D	E	F
3	5.50	7.05	4.77	11.90	14.10
4	6.50	7.55	5.27	12.90	15.10
5	7.50	8.05	5.77	13.90	16.10
6	8.50	8.55	6.27	14.90	17.10
7	9.50	9.05	6.77	15.90	18.10
8	10.50	9.55	7.27	16.90	19.10
9	11.50	10.05	7.77	17.90	20.10
10	12.50	10.55	8.27	18.90	21.10
11	13.50	10.55	8.27	19.90	22.10
12	14.50	11.55	9.27	20.90	23.10
13	15.50	12.55	9.77	21.90	24.10
14	16.50	12.55	10.27	22.90	25.10
16	18.50	13.55	11.27	24.90	27.10
18	20.50	14.55	12.27	26.90	29.10
20	22.50	15.55	13.27	28.90	31.10
22	24.50	16.55	14.27	31.90	33.10
24	26.50	17.55	15.27	33.90	35.10

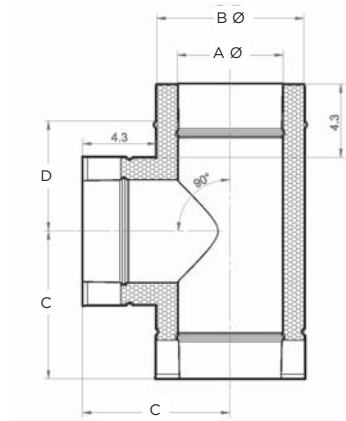

90BT 90° Boot Tee

A Ø	B Ø	C	D	E	F	G
3	5.50	6.17	10.12	7.85	14.00	16.20
4	6.50	6.75	11.04	8.76	15.50	17.70
5	7.50	7.17	11.95	9.68	16.90	19.10
6	8.50	7.67	12.86	10.59	18.30	20.50
7	9.50	8.17	13.78	11.51	19.70	21.90
8	10.50	8.67	14.69	12.42	21.10	23.30
9	11.50	9.17	15.61	13.33	22.50	24.70
10	12.50	9.67	16.52	14.25	23.90	26.10
11	13.50	10.17	17.43	15.16	25.30	27.50
12	14.50	10.67	18.34	16.07	26.70	28.90
13	15.50	11.17	19.25	16.98	28.10	30.40
14	16.50	11.67	20.18	17.91	29.60	31.80
16	18.50	12.67	22.01	19.73	32.40	34.60
18	20.50	13.67	23.83	21.56	35.20	37.40
20	22.50	14.67	25.66	23.39	38.10	40.30
22	24.50	15.67	27.49	25.22	40.90	43.10
24	26.50	16.67	29.32	27.05	43.70	45.90

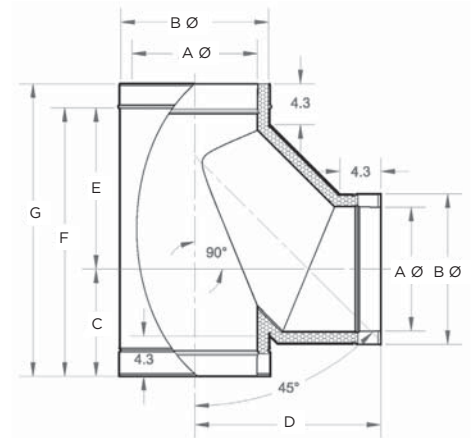

90WT 90° Wye Tee

A Ø	B Ø	C	D
3	5.50	3.12	7.03
4	6.50	3.33	7.53
5	7.50	3.54	8.03
6	8.50	3.74	8.53
7	9.50	3.95	9.03
8	10.50	4.16	9.53
9	11.50	4.36	10.03
10	12.50	4.57	10.53
11	13.50	4.78	11.03
12	14.50	4.99	11.53
13	15.50	5.19	12.03
14	16.50	5.40	12.53
16	18.50	5.81	13.53
18	20.50	6.23	14.53
20	22.50	6.64	15.53
22	24.50	7.06	16.53
24	26.50	7.47	17.53

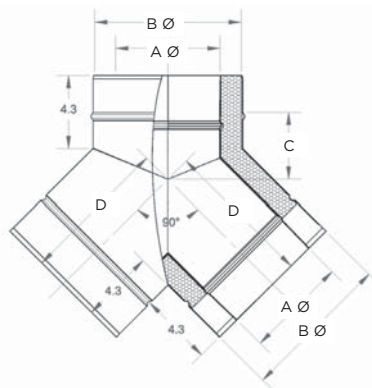

DCB Drain Tee Cap - Bottom

A Ø	B Ø
3	5.50
4	6.50
5	7.50
6	8.50
7	9.50
8	10.50
9	11.50
10	12.50
11	13.50
12	14.50
13	15.50
14	16.50
16	18.50
18	20.50
20	22.50
22	24.50
24	26.50

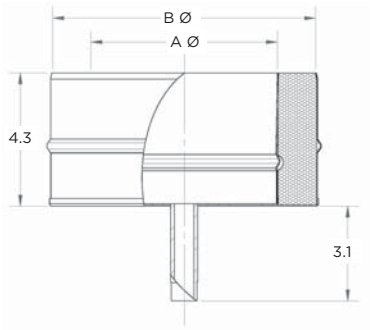

DCS Drain Tee Cap - Side

A Ø	B Ø
3	5.50
4	6.50
5	7.50
6	8.50
7	9.50
8	10.50
9	11.50
10	12.50
11	13.50
12	14.50
13	15.50
14	16.50
16	18.50
18	20.50
20	22.50
22	24.50
24	26.50

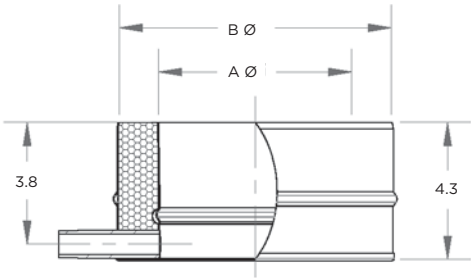

TCA Tee Cap Access

A Ø	B Ø
3	5.50
4	6.50
5	7.50
6	8.50
7	9.50
8	10.50
9	11.50
10	12.50
11	13.50
12	14.50
13	15.50
14	16.50
16	18.50
18	20.50
20	22.50
22	24.50
24	26.50

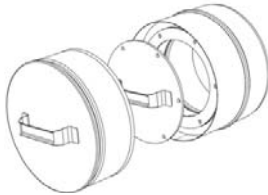
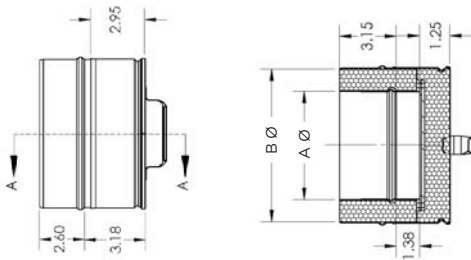

PRV Pressure Relief Valve

Pipe Ø	A Ø	B Ø
3	6.63	8
4	7.63	9
5	8.63	10
6	9.63	11
7	11.63	14
8	12.63	14
9	13.00	16
10	14.00	16
11	15.00	18
12	16.75	19
13	17.50	19
14	18.25	21
16	20.25	24
18	22.25	25
20	24.25	28
22	26.25	32
24	28.25	32

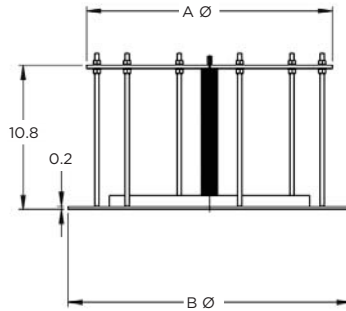

TI Tapered Increaser

A Ø	B Ø	C Ø	D Ø
3	5.50	<p>There are five (5) possible progressions from A Ø to C Ø.</p> <p>Overall length of each = 12.50"</p> <p>Installed length of each = 10.3"</p>	
4	6.50		
5	7.50		
6	8.50		
7	9.50		
8	10.50		
9	11.50		
10	12.50		
11	13.50		
12	14.50		
13	15.50		
14	16.50		
16	18.50		
18	20.50		
20	22.50		
22	24.50		
24	26.50		

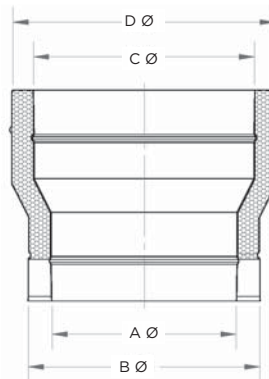

TR Tapered Reducer

A Ø	B Ø	C Ø	D Ø
3	5.50	<p>There are five (5) possible progressions from A Ø to C Ø.</p> <p>Overall length of each = 12.50"</p> <p>Installed length of each = 10.3"</p>	
4	6.50		
5	7.50		
6	8.50		
7	9.50		
8	10.50		
9	11.50		
10	12.50		
11	13.50		
12	14.50		
13	15.50		
14	16.50		
16	18.50		
18	20.50		
20	22.50		
22	24.50		
24	26.50		

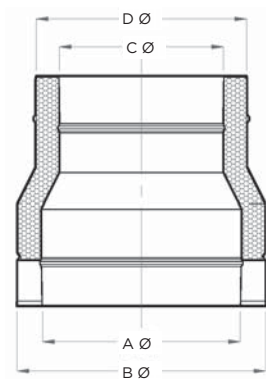

TEI Tapered Eccentric Increaser

A Ø	B Ø	C Ø	D Ø
3	5.50	<p>There are five (5) possible progressions from A Ø to C Ø.</p> <p>Overall length of each = 12.50"</p> <p>Installed length of each = 10.3"</p>	
4	6.50		
5	7.50		
6	8.50		
7	9.50		
8	10.50		
9	11.50		
10	12.50		
11	13.50		
12	14.50		
13	15.50		
14	16.50		
16	18.50		
18	20.50		
20	22.50		
22	24.50		
24	26.50		

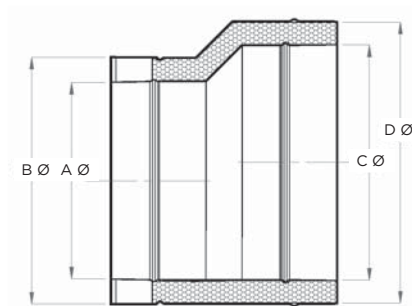

TER Tapered Eccentric Reducer

A Ø	B Ø	C Ø	D Ø
3	5.50	<p>There are five (5) possible progressions from A Ø to C Ø.</p> <p>Overall length of each = 12.50"</p> <p>Installed length of each = 10.3"</p>	
4	6.50		
5	7.50		
6	8.50		
7	9.50		
8	10.50		
9	11.50		
10	12.50		
11	13.50		
12	14.50		
13	15.50		
14	16.50		
16	18.50		
18	20.50		
20	22.50		
22	24.50		
24	26.50		

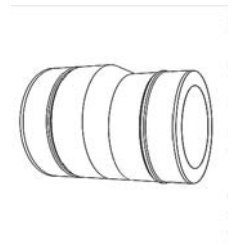
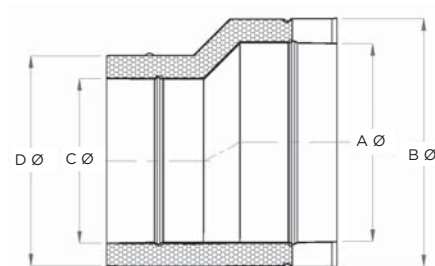

SI Stepped Increaser

A Ø	B Ø	C Ø	D Ø
3	5.50	<p>Any possibility from A Ø to C Ø</p> <p>Overall Length of each = 9.50"</p> <p>Installed Length of each = 7.30"</p>	
4	6.50		
5	7.50		
6	8.50		
7	9.50		
8	10.50		
9	11.50		
10	12.50		
11	13.50		
12	14.50		
13	15.50		
14	16.50		
16	18.50		
18	20.50		
20	22.50		
22	24.50		
24	26.50		

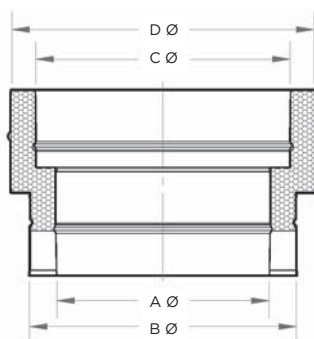

SR Stepped Reducer

A Ø	B Ø	C Ø	D Ø
3	5.50	Any possibility from A Ø to C Ø	Overall Length of each = 9.50" Installed Length of each = 7.30"
4	6.50		
5	7.50		
6	8.50		
7	9.50		
8	10.50		
9	11.50		
10	12.50		
11	13.50		
12	14.50		
13	15.50		
14	16.50		
16	18.50		
18	20.50		
20	22.50		
22	24.50		
24	26.50		

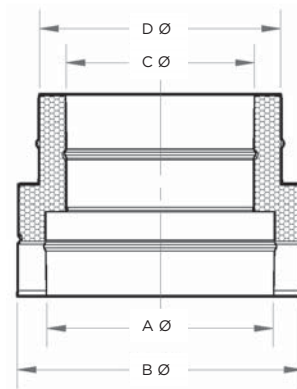

SEI Stepped Eccentric Increaser

A Ø	B Ø	C Ø	D Ø
3	5.50	Any possibility from A Ø to C Ø	Overall Length of each = 9.50" Installed Length of each = 7.30"
4	6.50		
5	7.50		
6	8.50		
7	9.50		
8	10.50		
9	11.50		
10	12.50		
11	13.50		
12	14.50		
13	15.50		
14	16.50		
16	18.50		
18	20.50		
20	22.50		
22	24.50		
24	26.50		

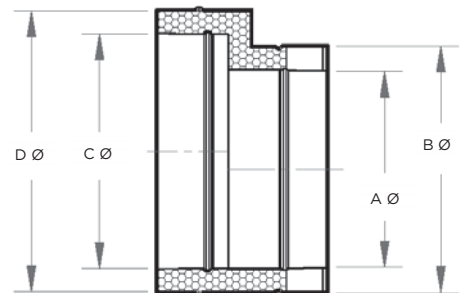

SER Stepped Eccentric Reducer

A Ø	B Ø	C Ø	D Ø
3	5.50	Any possibility from A Ø to C Ø	Overall Length of each = 9.50" Installed Length of each = 7.30"
4	6.50		
5	7.50		
6	8.50		
7	9.50		
8	10.50		
9	11.50		
10	12.50		
11	13.50		
12	14.50		
13	15.50		
14	16.50		
16	18.50		
18	20.50		
20	22.50		
22	24.50		
24	26.50		

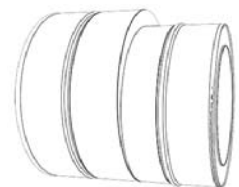
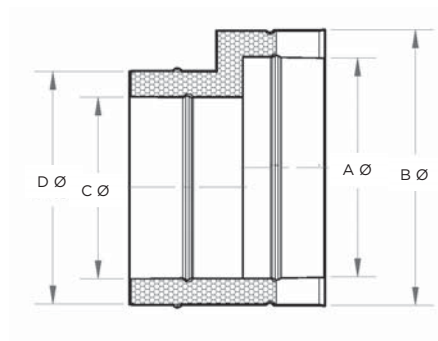

RCIS Raw Collar Adapter - Inside - Start

A Ø	B Ø
3	5.50
4	6.50
5	7.50
6	8.50
7	9.50
8	10.50
9	11.50
10	12.50
11	13.50
12	14.50
13	15.50
14	16.50
16	18.50
18	20.50
20	22.50
22	24.50
24	26.50

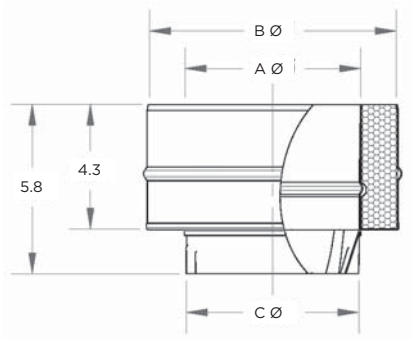

RCIE Raw Collar Adapter - Inside - End

A Ø	B Ø
3	5.50
4	6.50
5	7.50
6	8.50
7	9.50
8	10.50
9	11.50
10	12.50
11	13.50
12	14.50
13	15.50
14	16.50
16	18.50
18	20.50
20	22.50
22	24.50
24	26.50

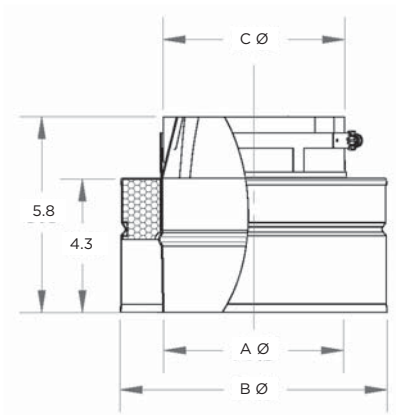

RCOS Raw Collar Adapter - Outside - Start

A Ø	B Ø
3	5.50
4	6.50
5	7.50
6	8.50
7	9.50
8	10.50
9	11.50
10	12.50
11	13.50
12	14.50
13	15.50
14	16.50
16	18.50
18	20.50
20	22.50
22	24.50
24	26.50

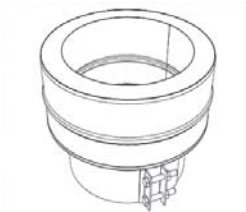
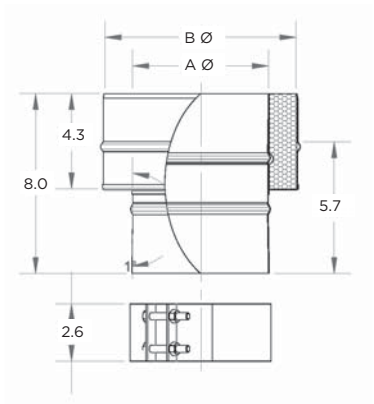

RCOE Raw Collar Adapter - Outside - End

A Ø	B Ø
3	5.50
4	6.50
5	7.50
6	8.50
7	9.50
8	10.50
9	11.50
10	12.50
11	13.50
12	14.50
13	15.50
14	16.50
16	18.50
18	20.50
20	22.50
22	24.50
24	26.50

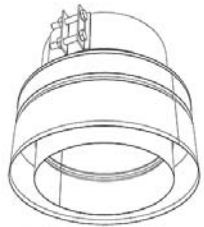
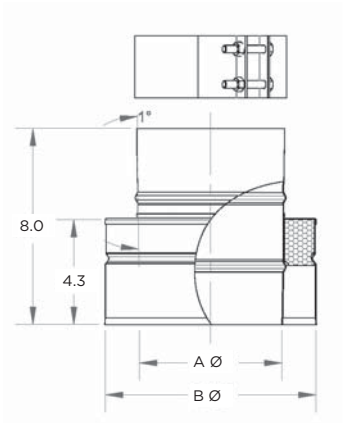

FCS Flange Collar Adapter - Start

A Ø	B Ø	C Ø
3	5.50	4
4	6.50	5
5	7.50	6
6	8.50	7
7	9.50	8
8	10.50	9
9	11.50	10
10	12.50	11
11	13.50	12
12	14.50	13
13	15.50	14
14	16.50	15
16	18.50	17
18	20.50	19
20	22.50	21
22	24.50	23
24	26.50	25

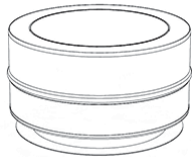
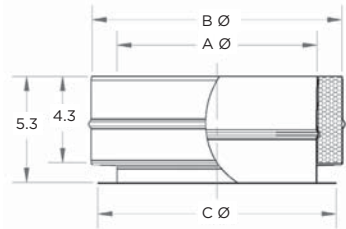

FCE Flange Collar Adapter - End

A Ø	B Ø	C
3	5.50	4
4	6.50	5
5	7.50	6
6	8.50	7
7	9.50	8
8	10.50	9
9	11.50	10
10	12.50	11
11	13.50	12
12	14.50	13
13	15.50	14
14	16.50	15
16	18.50	17
18	20.50	19
20	22.50	21
22	24.50	23
24	26.50	25

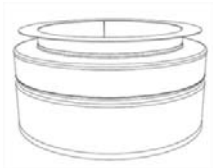
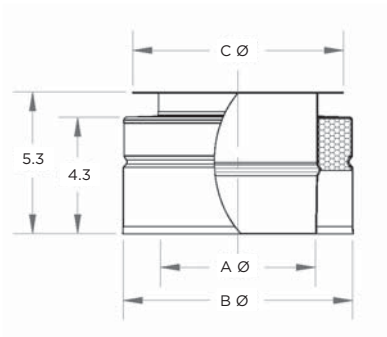

FCK Flange Collar Kit

Pipe Ø	A Ø	N° of Clamps
3	3.315	4
4	4.315	4
5	5.315	4
6	6.315	4
7	7.315	4
8	8.315	4
9	9.315	4
10	10.315	5
11	11.315	5
12	12.315	6
13	13.315	6
14	14.315	7
16	16.315	8
18	18.315	9
20	20.315	10
22	22.315	11
24	24.315	12

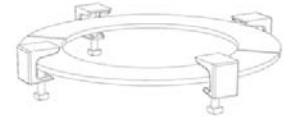
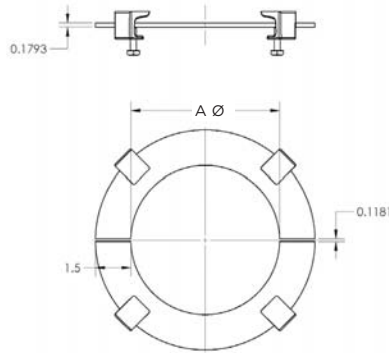

AFS 125 - 150 Lb. ANSI Flange - Start

A Ø	B Ø	C	D	hole Ø	n.holes
3	5.50	6.00	8	0.75	4
4	6.50	7.50	9	0.75	8
5	7.50	8.50	10	0.88	8
6	8.50	9.50	11	0.88	8
7	9.50	11.75	14	0.88	8
8	10.50	11.75	14	0.88	8
9	11.50	14.25	16	1.00	12
10	12.50	14.25	16	1.00	12
11	13.50	16.00	18	1.00	12
12	14.50	17.00	19	1.00	12
13	15.50	17.00	19	1.00	12
14	16.50	18.75	21	1.12	12
16	18.50	21.25	24	1.12	16
18	20.50	22.75	25	1.25	16
20	22.50	25.00	28	1.25	20
22	24.50	29.50	32	1.38	20
24	26.50	29.50	32	1.38	20

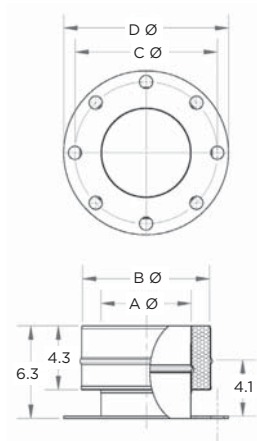

AFE 125 - 150 Lb. ANSI Flange - End

A Ø	B Ø	C	D	hole Ø	n.holes
3	5.50	6.00	8	0.75	4
4	6.50	7.50	9	0.75	8
5	7.50	8.50	10	0.88	8
6	8.50	9.50	11	0.88	8
7	9.50	11.75	14	0.88	8
8	10.50	11.75	14	0.88	8
9	11.50	14.25	16	1.00	12
10	12.50	14.25	16	1.00	12
11	13.50	16.00	18	1.00	12
12	14.50	17.00	19	1.00	12
13	15.50	17.00	19	1.00	12
14	16.50	18.75	21	1.12	12
16	18.50	21.25	24	1.12	16
18	20.50	22.75	25	1.25	16
20	22.50	25.00	28	1.25	20
22	24.50	29.50	32	1.38	20
24	26.50	29.50	32	1.38	20

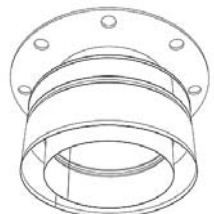
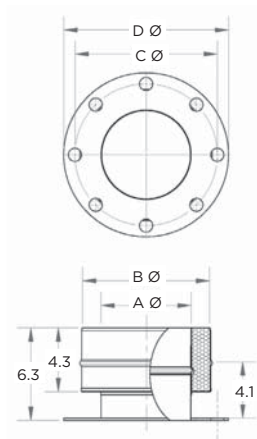

TRS Transition to Round - Start

A Ø	B Ø	C	D
3	5.50	Customer dimension	Customer dimension
4	6.50		
5	7.50		
6	8.50		
7	9.50		
8	10.50		
9	11.50		
10	12.50		
11	13.50		
12	14.50		
13	15.50		
14	16.50		
16	18.50		
18	20.50		
20	22.50		
22	24.50		
24	26.50		

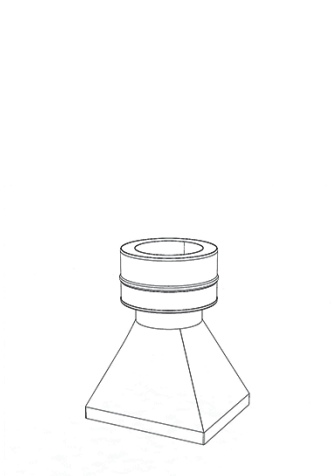
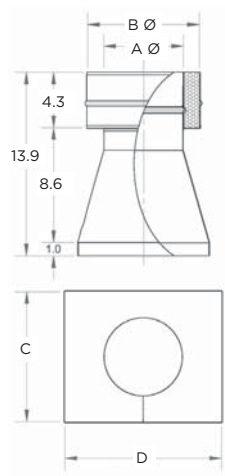

TRE Transition to Round - End

A Ø	B Ø	C	D
3	5.50	Customer dimension	Customer dimension
4	6.50		
5	7.50		
6	8.50		
7	9.50		
8	10.50		
9	11.50		
10	12.50		
11	13.50		
12	14.50		
13	15.50		
14	16.50		
16	18.50		
18	20.50		
20	22.50		
22	24.50		
24	26.50		

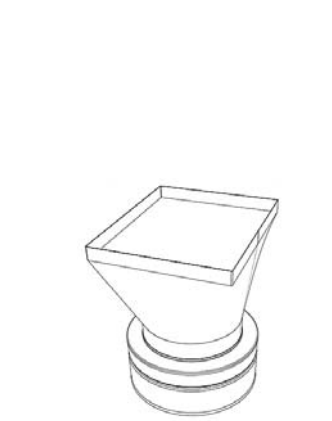
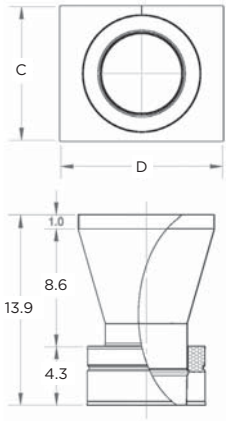

FPS Fan Plate Adapter - Start

A Ø	B Ø	C
3	5.50	min A Ø +3"
4	6.50	
5	7.50	
6	8.50	
7	9.50	
8	10.50	
9	11.50	
10	12.50	
11	13.50	
12	14.50	
13	15.50	
14	16.50	
16	18.50	
18	20.50	
20	22.50	
22	24.50	
24	26.50	

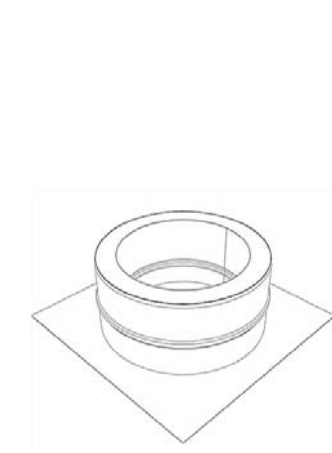
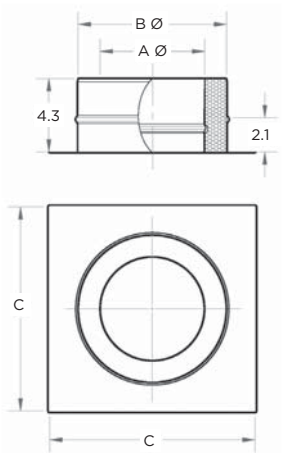

FPE Fan Plate Adapter - End

A Ø	B Ø	C
3	5.50	min A Ø +3"
4	6.50	
5	7.50	
6	8.50	
7	9.50	
8	10.50	
9	11.50	
10	12.50	
11	13.50	
12	14.50	
13	15.50	
14	16.50	
16	18.50	
18	20.50	
20	22.50	
22	24.50	
24	26.50	

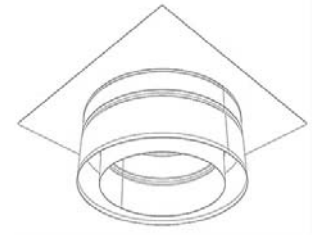
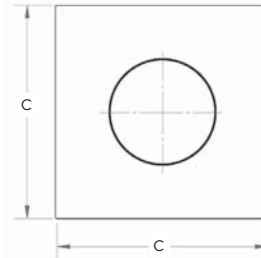
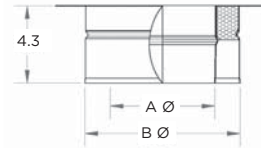

D2S DWKL to SWKL Adapter

A Ø	B Ø
3	5.50
4	6.50
5	7.50
6	8.50
7	9.50
8	10.50
9	11.50
10	12.50
11	13.50
12	14.50
13	15.50
14	16.50
16	18.50
18	20.50
20	22.50
22	24.50
24	26.50

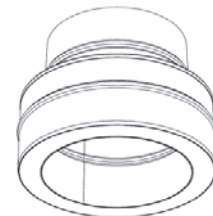
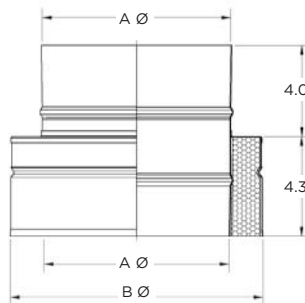

S2D SWKL to DWKL Adapter

A Ø	B Ø
3	5.50
4	6.50
5	7.50
6	8.50
7	9.50
8	10.50
9	11.50
10	12.50
11	13.50
12	14.50
13	15.50
14	16.50
16	18.50
18	20.50
20	22.50
22	24.50
24	26.50

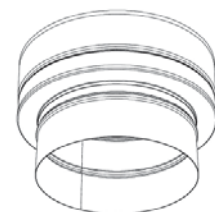
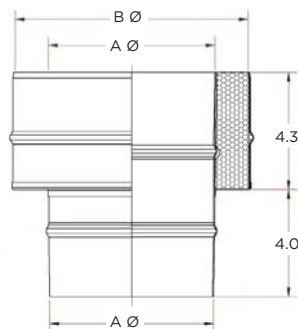

OTN Opened Termination

A Ø	B Ø
3	5.50
4	6.50
5	7.50
6	8.50
7	9.50
8	10.50
9	11.50
10	12.50
11	13.50
12	14.50
13	15.50
14	16.50
16	18.50
18	20.50
20	22.50
22	24.50
24	26.50

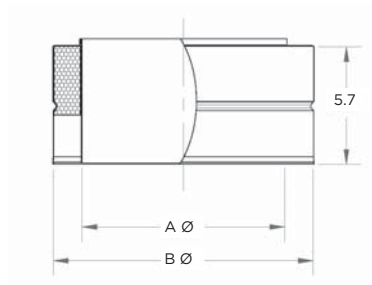

OTNH Open Termination High Temp

A Ø	B Ø
3	5.50
4	6.50
5	7.50
6	8.50
7	9.50
8	10.50
9	11.50
10	12.50
11	13.50
12	14.50
13	15.50
14	16.50
16	18.50
18	20.50
20	22.50
22	24.50
24	26.50

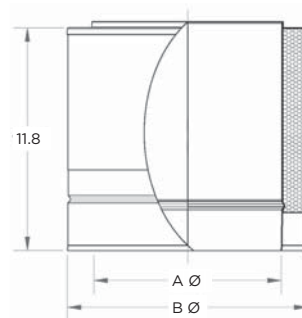

OTS Opened Termination with Screen

A Ø	B Ø
3	5.50
4	6.50
5	7.50
6	8.50
7	9.50
8	10.50
9	11.50
10	12.50
11	13.50
12	14.50
13	15.50
14	16.50
16	18.50
18	20.50
20	22.50
22	24.50
24	26.50

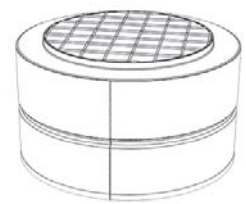
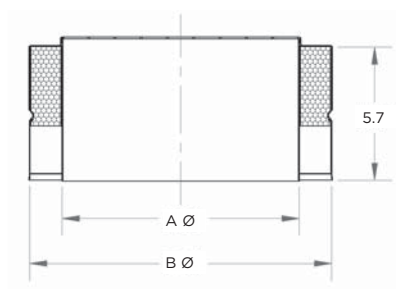

OTSH Open Termination with Screen High Temp

A Ø	B Ø
3	5.50
4	6.50
5	7.50
6	8.50
7	9.50
8	10.50
9	11.50
10	12.50
11	13.50
12	14.50
13	15.50
14	16.50
16	18.50
18	20.50
20	22.50
22	24.50
24	26.50

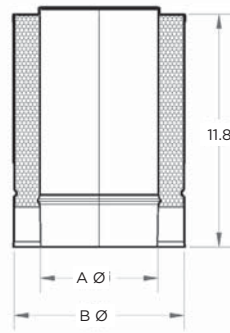

EC Exit Cone

A Ø	B Ø	C Ø
3	5.50	2.44
4	6.50	3.26
5	7.50	4.08
6	8.50	4.89
7	9.50	5.71
8	10.50	6.53
9	11.50	7.34
10	12.50	8.16
11	13.50	8.98
12	14.50	9.79
13	15.50	10.61
14	16.50	11.43
16	18.50	13.06
18	20.50	14.69
20	22.50	16.32
22	24.50	17.96
24	26.50	19.59

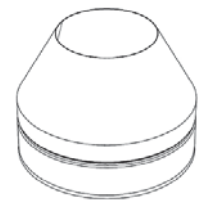
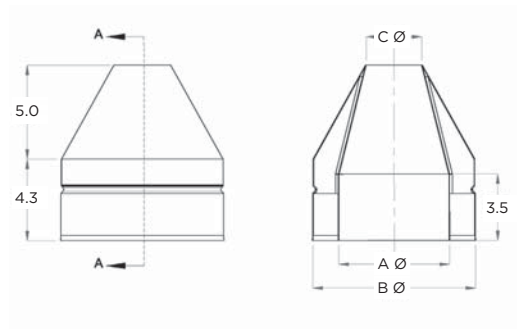

ECH Exit Cone High Temp

A Ø	B Ø	C Ø
3	5.50	2.44
4	6.50	3.26
5	7.50	4.08
6	8.50	4.89
7	9.50	5.71
8	10.50	6.53
9	11.50	7.34
10	12.50	8.16
11	13.50	8.98
12	14.50	9.79
13	15.50	10.61
14	16.50	11.43
16	18.50	13.06
18	20.50	14.69
20	22.50	16.32
22	24.50	17.96
24	26.50	19.59

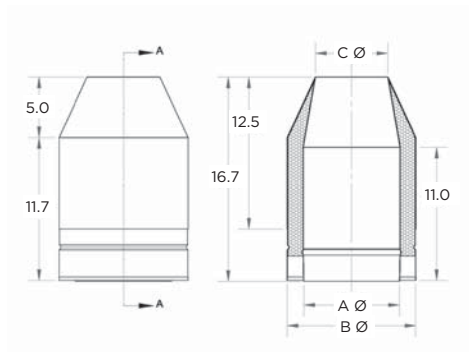

FTN Flat Top Rain Cap No Screen

A Ø	B Ø	C	D Ø
3	5.50	5.31	11.10
4	6.50	5.31	11.10
5	7.50	6.89	12.60
6	8.50	7.09	12.80
7	9.50	7.87	13.60
8	10.50	8.27	14.00
9	11.50	8.27	14.00
10	12.50	10.24	16.00
11	13.50	11.02	17.70
12	14.50	12.01	17.70
13	15.50	12.01	17.70
14	16.50	13.39	17.70
16	18.50	14.57	20.30
18	20.50	15.35	21.10
20	22.50	15.35	21.10
22	24.50	16.54	22.30
24	26.50	16.93	22.70

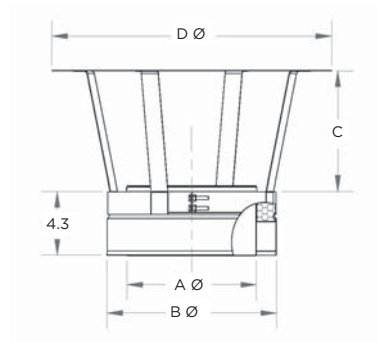

FTNH Flat Top Rain Cap No Screen High Temp

A Ø	B Ø	C	D Ø
3	5.50	5.31	11.10
4	6.50	5.31	11.10
5	7.50	6.89	12.60
6	8.50	7.09	12.80
7	9.50	7.87	13.60
8	10.50	8.27	14.00
9	11.50	8.27	14.00
10	12.50	10.24	16.00
11	13.50	11.02	17.70
12	14.50	12.01	17.70
13	15.50	12.01	17.70
14	16.50	13.39	17.70
16	18.50	14.57	20.30
18	20.50	15.35	21.10
20	22.50	15.35	21.10
22	24.50	16.54	22.30
24	26.50	16.93	22.70

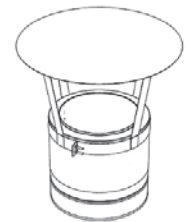
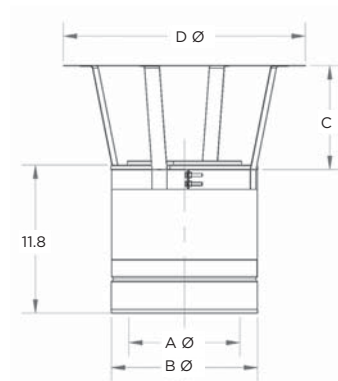

FTS Flat Top Rain Cap with Screen

A Ø	B Ø	C	D Ø
3	5.50	5.31	11.1
4	6.50	5.31	11.1
5	7.50	6.89	12.6
6	8.50	7.09	12.8
7	9.50	7.87	13.6
8	10.50	8.27	14.0
9	11.50	8.27	14.0
10	12.50	10.24	16.0
11	13.50	11.02	17.7
12	14.50	12.01	17.7
13	15.50	12.01	17.7
14	16.50	13.39	17.7
16	18.50	14.57	20.3
18	20.50	15.35	21.1
20	22.50	15.35	21.1
22	24.50	16.54	22.3
24	26.50	16.93	22.7

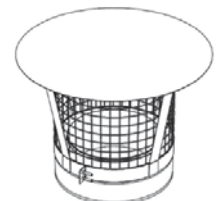
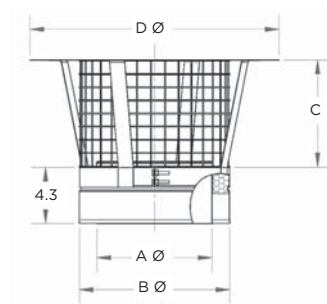

FTSH Flat Top Rain Cap with Screen High Temp

A Ø	B Ø	C	D Ø
3	5.50	5.31	11.1
4	6.50	5.31	11.1
5	7.50	6.89	12.6
6	8.50	7.09	12.8
7	9.50	7.87	13.6
8	10.50	8.27	14.0
9	11.50	8.27	14.0
10	12.50	10.24	16.0
11	13.50	11.02	17.7
12	14.50	12.01	17.7
13	15.50	12.01	17.7
14	16.50	13.39	17.7
16	18.50	14.57	20.3
18	20.50	15.35	21.1
20	22.50	15.35	21.1
22	24.50	16.54	22.3
24	26.50	16.93	22.7

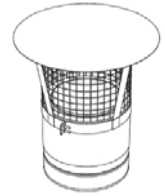
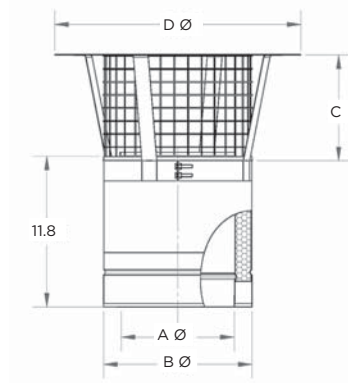

WRC High Wind Rain Cap

A Ø	B Ø	C Ø
3	5.50	A Ø + 7.3"
4	6.50	
5	7.50	
6	8.50	
7	9.50	
8	10.50	
9	11.50	
10	12.50	
11	13.50	
12	14.50	
13	15.50	
14	16.50	
16	18.50	
18	20.50	
20	22.50	
22	24.50	
24	26.50	

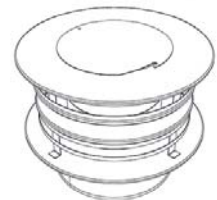
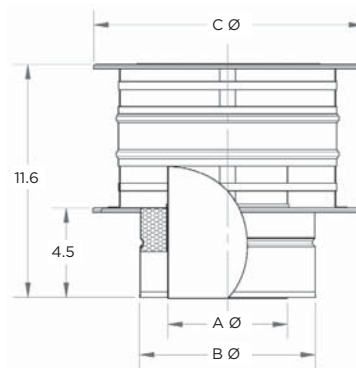

SCN Stack Cap No Screen

A Ø	B Ø	C	D
3	5.50	12.00	8.90
4	6.50	12.00	9.20
5	7.50	12.00	9.40
6	8.50	12.00	9.73
7	9.50	14.00	11.30
8	10.50	16.00	11.54
9	11.50	17.00	13.34
10	12.50	17.00	13.42
11	13.50	20.50	15.42
12	14.50	20.50	15.42
13	15.50	24.00	17.36
14	16.50	24.00	17.36
16	18.50	27.38	19.24
18	20.50	30.75	21.21
20	22.50	34.13	21.21
22	24.50	37.63	25.16
24	26.50	41.00	27.16

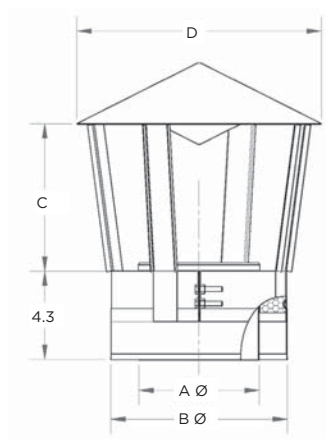

SCNH Stack Cap No Screen High Temp

A Ø	B Ø	C	D
3	5.50	12.00	8.90
4	6.50	12.00	9.20
5	7.50	12.00	9.40
6	8.50	12.00	9.73
7	9.50	14.00	11.30
8	10.50	16.00	11.54
9	11.50	17.00	13.34
10	12.50	17.00	13.42
11	13.50	20.50	15.42
12	14.50	20.50	15.42
13	15.50	24.00	17.36
14	16.50	24.00	17.36
16	18.50	27.38	19.24
18	20.50	30.75	21.21
20	22.50	34.13	21.21
22	24.50	37.63	25.16
24	26.50	41.00	27.16

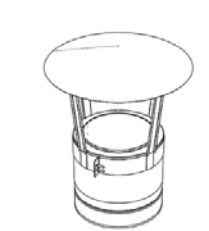
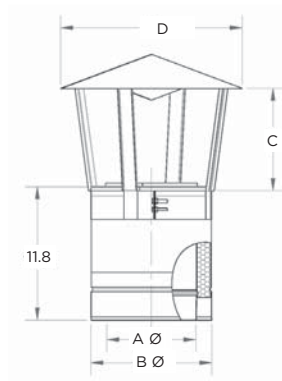

SCS Stack Cap with Screen

A Ø	B Ø	C	D
3	5.50	12.00	8.90
4	6.50	12.00	9.20
5	7.50	12.00	9.40
6	8.50	12.00	9.73
7	9.50	14.00	11.30
8	10.50	16.00	11.54
9	11.50	17.00	13.34
10	12.50	17.00	13.42
11	13.50	20.50	15.42
12	14.50	20.50	15.42
13	15.50	24.00	17.36
14	16.50	24.00	17.36
16	18.50	27.38	19.24
18	20.50	30.75	21.21
20	22.50	34.13	21.21
22	24.50	37.63	25.16
24	26.50	41.00	27.16

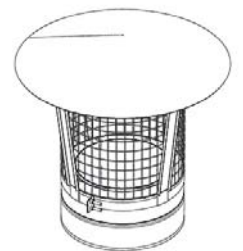
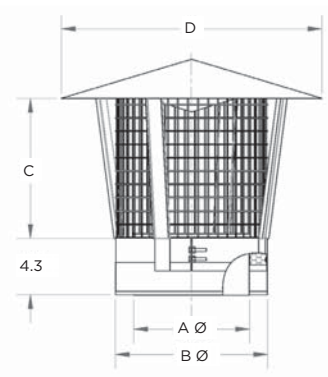

SCSH Stack Cap with Screen High Temp

A Ø	B Ø	C	D
3	5.50	12.00	8.90
4	6.50	12.00	9.20
5	7.50	12.00	9.40
6	8.50	12.00	9.73
7	9.50	14.00	11.30
8	10.50	16.00	11.54
9	11.50	17.00	13.34
10	12.50	17.00	13.42
11	13.50	20.50	15.42
12	14.50	20.50	15.42
13	15.50	24.00	17.36
14	16.50	24.00	17.36
16	18.50	27.38	19.24
18	20.50	30.75	21.21
20	22.50	34.13	21.21
22	24.50	37.63	25.16
24	26.50	41.00	27.16

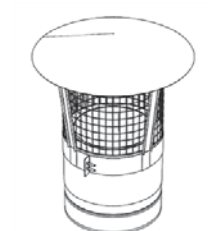
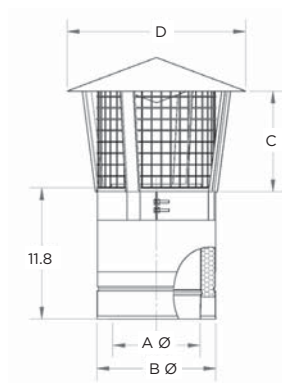

MCS Miter Cut Termination

A Ø	B Ø
3	5.50
4	6.50
5	7.50
6	8.50
7	9.50
8	10.50
9	11.50
10	12.50
11	13.50
12	14.50
13	15.50
14	16.50
16	18.50
18	20.50
20	22.50
22	24.50
24	26.50

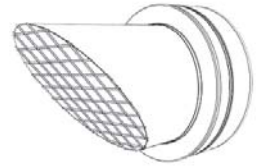
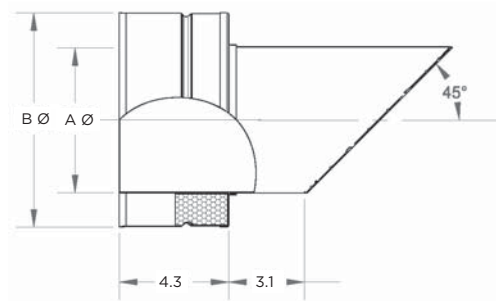

MCSH Miter Cut Termination High Temp

A Ø	B Ø
3	5.50
4	6.50
5	7.50
6	8.50
7	9.50
8	10.50
9	11.50
10	12.50
11	13.50
12	14.50
13	15.50
14	16.50
16	18.50
18	20.50
20	22.50
22	24.50
24	26.50

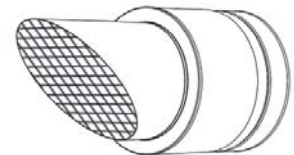
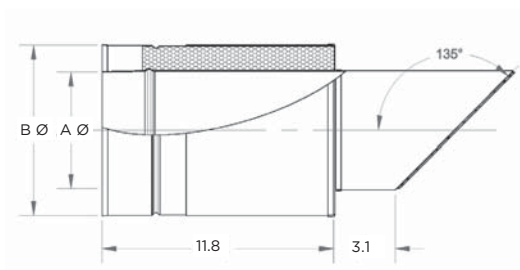

EFT Engine Flip Top

A Ø	B Ø
3	5.50
4	6.50
5	7.50
6	8.50
7	9.50
8	10.50
9	11.50
10	12.50
11	13.50
12	14.50
13	15.50
14	16.50
16	18.50
18	20.50
20	22.50
22	24.50
24	26.50

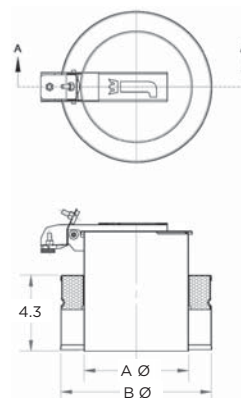

EFTH Engine Flip Top High Temp

A Ø	B Ø
3	5.50
4	6.50
5	7.50
6	8.50
7	9.50
8	10.50
9	11.50
10	12.50
11	13.50
12	14.50
13	15.50
14	16.50
16	18.50
18	20.50
20	22.50
22	24.50
24	26.50

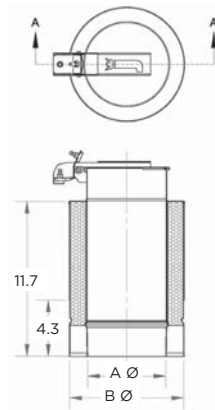

NLWH No-Loss Weather Head

A Ø	B Ø	C Ø	D	E
3	5.50	5.00	11.69	15.94
4	6.50	6.00	15.69	19.94
5	7.50	7.00	19.69	23.94
6	8.50	8.00	23.69	27.94
7	9.50	9.00	27.69	31.94
8	10.50	10.00	31.69	35.94
9	11.50	12.00	39.44	43.75
10	12.50	14.00	47.44	51.75
11	13.50	15.00	47.44	51.75
12	14.50	16.00	52.94	57.25
13	15.50	17.00	52.94	57.25
14	16.50	18.00	61.94	66.25
16	18.50	20.00	70.94	75.25
18	20.50	22.00	70.94	75.25
20	22.50	24.00	70.94	75.25
22	24.50	24.00	70.94	75.25
24	26.50	26.00	70.94	75.25

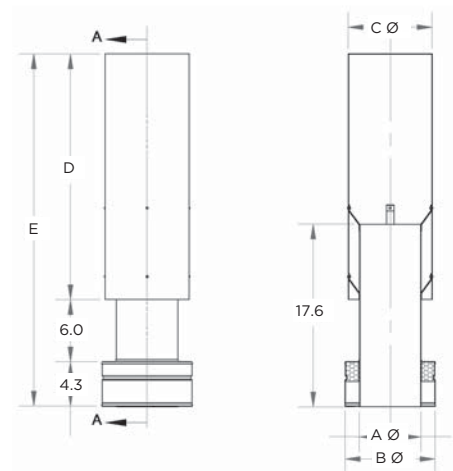

HTT High Temperature Insulated Thimble

Pipe Ø	A Ø	B Ø	C Ø
3	5.50	6	8.50
4	6.50	7	9.50
5	7.50	8	10.50
6	8.50	9	11.50
7	9.50	10	12.50
8	10.50	11	13.50
9	11.50	12	14.50
10	12.50	13	15.50
11	13.50	14	16.50
12	14.50	15	17.50
13	15.50	16	18.50
14	16.50	17	19.50
16	18.50	19	21.50
18	20.50	21	23.50
20	22.50	23	25.50
22	24.50	25	27.50
24	26.50	27	29.50

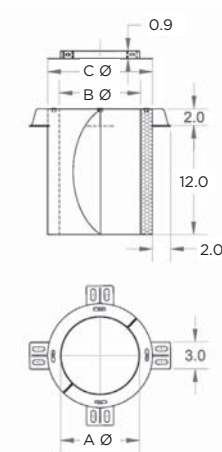

FRF Flat Roof Flashing

Pipe Ø	A Ø	B Ø	C
3	5.50	13	25
4	6.50	14	26
5	7.50	15	27
6	8.50	16	28
7	9.50	17	29
8	10.50	18	30
9	11.50	19	31
10	12.50	20	32
11	13.50	21	33
12	14.50	22	34
13	15.50	23	35
14	16.50	24	36
16	18.50	26	38
18	20.50	28	40
20	22.50	30	42
22	24.50	32	44
24	26.50	34	46

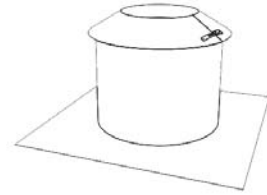
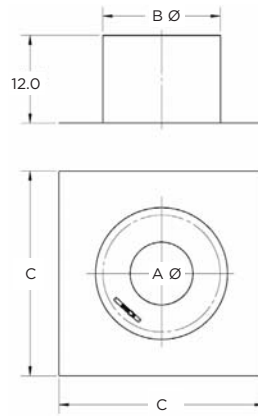

PRF Pitched Roof Flashing

Pipe Ø	A Ø	B Ø	C
3	5.50	13	25
4	6.50	14	26
5	7.50	15	27
6	8.50	16	28
7	9.50	17	29
8	10.50	18	30
9	11.50	19	31
10	12.50	20	32
11	13.50	21	33
12	14.50	22	34
13	15.50	23	35
14	16.50	24	36
16	18.50	26	38
18	20.50	28	40
20	22.50	30	42
22	24.50	32	44
24	26.50	34	46

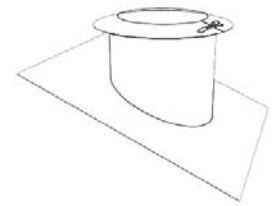
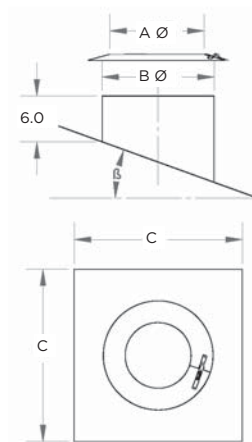

SC Storm Collar

Pipe Ø	A Ø	B Ø
3	5.5	15
4	6.5	16
5	7.5	17
6	8.5	18
7	9.5	19
8	10.5	20
9	11.5	21
10	12.5	22
11	13.5	23
12	14.5	24
13	15.5	25
14	16.5	26
16	18.5	28
18	20.5	30
20	22.5	32
22	24.5	34
24	26.5	36

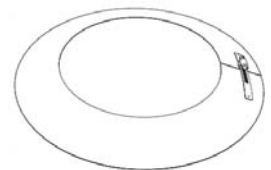
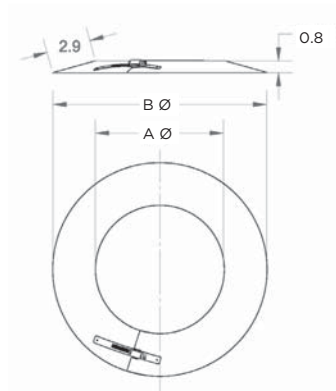

VRF Ventilated Roof Flashing

Pipe Ø	A Ø	B
3	16	24
4	17	25
5	18	26
6	19	27
7	20	28
8	21	29
9	22	30
10	23	31
11	24	32
12	25	33
13	26	34
14	27	35
16	29	37
18	31	39
20	33	41
22	35	43
24	37	45

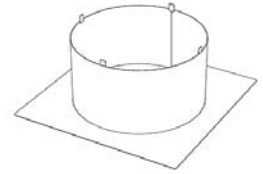
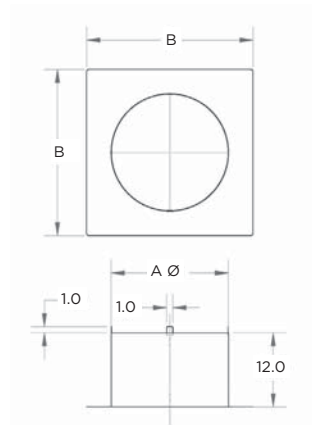

VSC Ventilated Storm Collar

Pipe Ø	A Ø	B Ø
3	5.5	19
4	6.5	20
5	7.5	21
6	8.5	22
7	9.5	23
8	10.5	24
9	11.5	25
10	12.5	26
11	13.5	27
12	14.5	28
13	15.5	29
14	16.5	30
16	18.5	32
18	20.5	34
20	22.5	36
22	24.5	38
24	26.5	40

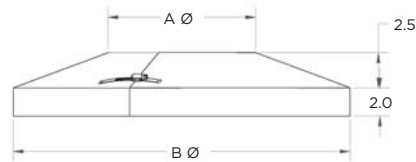

WARRANTY STATEMENT

I. 1-Year Limited Warranty

Jeremias Inc. ("Jeremias") provides a 1-year limited warranty ("1-Year Limited Warranty") for its Universal Stacks and Exhaust Systems models SWKL and DWKL (collectively, the "Products") for any defect in workmanship or materials under normal use from the date of shipment to the purchaser of Products ("Purchaser"), subject to the following conditions:

- Product sizing and specifications have been performed in accordance with generally accepted engineering practices.
- Correct installation and maintenance in full compliance with Jeremias' installation and maintenance instructions as published at the time of installation.

II. Extended 25-Year Limited Warranty

Jeremias provides for an extended 25-year limited warranty ("25-Year Limited Warranty") for any defect in workmanship or materials under normal use from the date of shipment to the Purchaser, subject to the satisfaction of the following conditions:

- Products must have been designed and sized by Jeremias' personnel.
- Availability of a written inspection report from the time of installation, or timely thereafter, by a Jeremias inspector or an inspector authorized by Jeremias, that the Product assembly and installation conformed to all of Jeremias' assembly and installation instructions.
- Products were at all times operated and maintained in full compliance with Jeremias' operation and maintenance instructions as published at the time of installation or as later provided to Purchaser by Jeremias.

III. Exclusion of Limited Warranty

The 1-Year Limited Warranty and the 25-Year Limited Warranty (collectively the "Limited Warranty") shall not cover (i) damages to: wear parts, e.g. seals; demonstration units; paintwork; moving parts, including but not limited to compensators, flue gas dampers, draught regulators, chimney, doors; flexible piping; insulation; consumables, such as granulates; minor Product deviations which do not effect functionality; or (ii) damages caused by: contamination of ambient air or combustion air by chlorinated hydrocarbons or other vapors which may cause excessively severe acid condensate to form within the Products; merchandise provided by other manufacturers; installation, transport or commissioning; Purchaser, an installer or other third parties; normal wear and tear; any party other than Jeremias in a willful manner; force majeure, including, but not limited to flood, fire or frost; non-compliance with the assembly, installation, operation and maintenance instructions available at www.JeremiasInc.com; assembly, installation, maintenance or repair by unqualified personnel; improper commissioning; use of Products not in accordance with their intended purpose; exposure of Products to any metals of an inferior quality; contamination of the Products between unpacking and assembly; burning of wood other than unpainted, natural wood, which has been stored for at least 3 years and which moisture level does not exceed 20%; or burning of chipboard or domestic waste.

IV. Remedies

If a valid Limited Warranty claim arises, Jeremias shall, at its sole discretion, either repair the Product or deliver a properly functioning Product. This Limited Warranty is limited to repair or replacement of the Product plus shipping cost to the location of the defective Product. The Limited Warranty does not cover labor costs for removal or replacement of the defective Product, unless such labor shall be carried out by Jeremias itself in its sole discretion.

V. Filing of a Limited Warranty Claim

Limited Warranty claims may only be asserted during the term of the applicable Limited Warranty period. Any extension of the term of the Limited Warranties shall be excluded, regardless of the legal basis. If Purchaser believes that there is a justified Limited Warranty claim, Purchaser shall notify Jeremias to that effect in writing. Any claims stemming from or relating to a Limited Warranty shall be asserted in detail within eight weeks after the discovery of the defect (the time when the notification is received by Jeremias will be the basis for determining whether a claim has been reported within this deadline) or else shall be excluded and not be recognized by Purchaser. Such notification shall include a description of the defect, original proof of purchase, and a copy of the written inspection report as described in Section II above (if applicable).

VI. No Other Warranty

EXCEPT AS SET FORTH EXPRESSLY THEREIN, JEREMIAS MAKES NO WARRANTIES, EITHER EXPRESS OR IMPLIED, REGARDING THE PRODUCTS, INCLUDING, BUT NOT LIMITED TO, THE IMPLIED WARRANTIES OF MERCHANTABILITY AND FITNESS FOR A PARTICULAR PURPOSE.

VII. Damages Disclaimer and Limitation

IN NO EVENT SHALL JEREMIAS BE LIABLE TO ANY CLIENT OR ANY OTHER PERSON FOR ANY (A) INDIRECT, INCIDENTAL, CONSEQUENTIAL OR PUNITIVE DAMAGES, INCLUDING LOSS OF PROFIT OR GOODWILL OR (B) DIRECT DAMAGES TO BODY, HEALTH OR PROPERTY FOR ANY MATTER ARISING OUT OF OR RELATING TO THE PRODUCTS, WHETHER SUCH LIABILITY IS ASSERTED ON THE BASIS OF CONTRACT, TORT OR OTHERWISE EVEN IF JEREMIAS HAS BEEN ADVISED OF THE POSSIBILITY OF SUCH DAMAGES. IN NO EVENT SHALL JEREMIAS' TOTAL AGGREGATE LIABILITY FOR DAMAGES EXCEED THE GREATER OF THE AMOUNT OF (A) TOTAL COMPENSATION PAID BY PURCHASER TO JEREMIAS FOR THE PRODUCTS, OR (B) PROCEEDS AVAILABLE FROM ANY INSURANCE POLICY IN EFFECT AND APPLICABLE TO THE EVENT GIVING RISE TO SUCH LIABILITY.

VIII. Notice

Any notice or other communication hereunder to Jeremias shall be sent postage prepaid, by certified mail, by courier such as United Parcel Service or e-mail, to the following: Jeremias Inc., 983 Industrial Park Drive, Marietta, GA 30062, E-mail: Info@JeremiasInc.com. Notices shall be effective upon receipt.

IX. Terms and Conditions of Sale

Purchaser's Terms and Conditions of Sale as currently in effect shall govern these Limited Warranties, including without limitation the rights and responsibilities granted hereunder.

This image shows a single sheet of white paper with horizontal blue or grey ruling lines. The lines are evenly spaced and run across the width of the page. There are approximately 20 lines visible. The paper has a slight shadow on the right side, suggesting it's resting on a surface.



Jeremias SUBMITTAL_DS-USS 5-5-15