

- Special Gas Vent
- Category I, II, III, & IV Venting
- Type B & L Vents
- UL-103 Pressure Stacks

**GOV**

## **Gas/Oil Vents & UL-103 Stacks**



### **Models DWKL-Vt and SWKL-Vt Submittal Record**

- ☐ **DWKL-Vt Double Wall**
- ☐ **SWKL-Vt Single Wall**



PROJECT: \_\_\_\_\_

PREPARED BY: \_\_\_\_\_

PREPARED FOR: \_\_\_\_\_

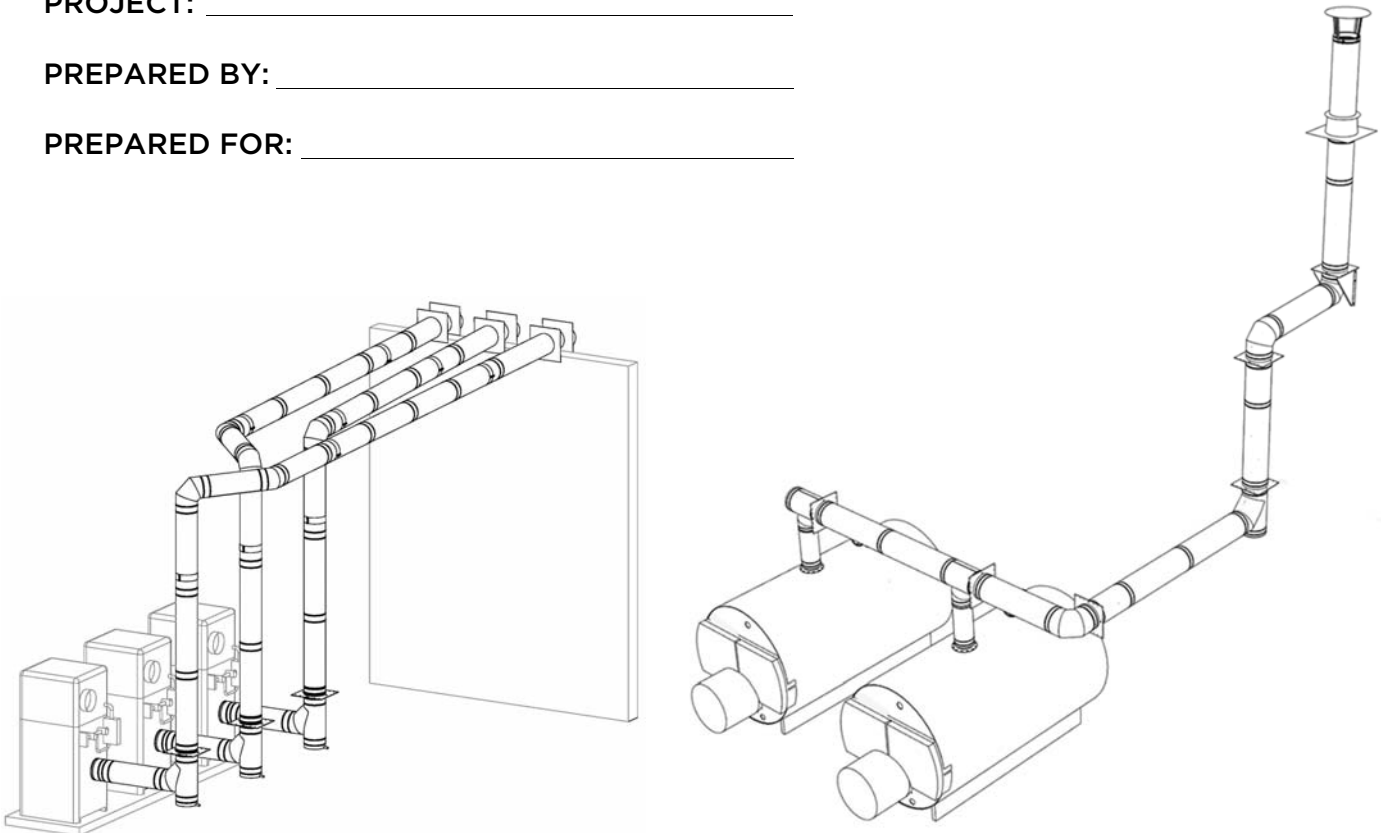

# INDEX

## INTRODUCTION

Jeremias Exhaust Systems	3
40 Years of Experience	3
Research & Development	3
All Stainless Steel Construction	4
Best Insulation	4
Joint Connection Surface Area	4

## TECHNICAL SPECIFICATIONS

Model and Part Identifications	5
Material and Thicknesses	5
Underwriters Laboratories Listings	5
Code and Standards	5
Operating Pressures	5
Operating Temperatures	5
Clearance to Combustibles	5
Installation Clearance Example	6
Joint Detail	6
Pipe Weight per Foot	6
Joint Assembly	7
Support Innovations	7
Sizing/Pressure Calculations	7
Submittal and Warranted Designs	7

## ITEMS

(supports)

APS Anchor Plate Support
HDB Heavy Duty Base
WB Wall Brackets
FAR Full Angle Ring
HAR Half Angle Ring
LSB Light Support Band
GWB Guy Wires Band

(pipe and other lengths)

6L 6" Fixed Pipe Length
9L 9" Fixed Pipe Length
12L 12" Fixed Pipe Length
18L 18" Fixed Pipe Length
24L 24" Fixed Pipe Length
30L 30" Fixed Pipe Length
36L 36" Fixed Pipe Length
42L 42" Fixed Pipe Length
48L 48" Fixed Pipe Length
UDL Universal Drain Length
TPL Test/Nozzle Port Length
18CL 18" Cut Pipe Length
30CL 30" Cut Pipe Length
18AL 18" Adjustable Length
30AL 30" Adjustable Length
18AG 18" Adjustable Length w/ Gasket
30AG 30" Adjustable length w/ Gasket
LBL 18" Lined Bellows Length

(fittings and accessories)

15EL 15° Elbow
30EL 30° Elbow
45EL 45° Elbow
90EL 90° Elbow
45T 45° Tee
90T 90° Tee

90BT 90° Boot Tee
90WT 90° Wye Tee
DCB Drain Tee Cap Bottom
DCS Drain Tee Cap Side
TCA Tee Cap Access
PRV Pressure Relief Valve

(increasers and reducers)

TI Tapered Increaser
TR Tapered Reducer
TEI Tapered Eccentric Increaser
TER Tapered Eccentric Reducer
SI Stepped Increaser
SR Stepped Reducer
SEI Stepped Eccentric Increasers
SER Stepped Eccentric Reducer

(start and end adapters)

RCIS & RCIE Raw Collar Adapter Inside
RCOS & RCOE Raw Collar Adapter Outside
FCS & FCE Flange Collar Adapter
FCK Flange Collar Kit
AFS & AFE 125/150 Lb ANSI Flange
TRS & TRE Transition to Round
FPS & FPE Fan Plate Adapter
D2S DWKL to SWKL Adapter
S2D SWKL to DWKL Adapter

(terminations)

OTN, OTNH, OTS, & OTSH Open Termination
EC & ECH Exit Cone
FTN, FTNH, FTS, & FTSH Flat Top Rain Cap
WRC High Wind Rain Cap
SCN, SCNH, SCS, SCSH Stack Cap
MCS & MCSH Miter Cut Termination w/ Screen
EFT & EFTH Engine Flip Top
NLWH No-Loss Weather Head

(thimble and flashings)

HTT High Temperature Insulated Thimble
FRF Flat Roof Flashing
PRF Pitched Roof Flashing
SC Storm Collar
VRF Ventilated Roof Flashing
VSC Ventilated Storm Collar

## SAMPLE DESIGNS

Sample 1 - SWKL-Vt Cat III or IV Sidewall	8
Sample 2 - DWKL/SWKL-Vt Sealed Comb.	9
Sample 3 - SWKL-Vt Fume Hood Vent	10
Sample 4 - SWKL-Vt Dishwasher Exhaust	11
Sample 5 - DWKL-Vt Boiler Stack	12
Sample 6 - DWKL-Vt Engine Exhaust	13

<b>WARRANTY STATEMENT</b>	<b>14</b>
---------------------------	-----------

<b>NOTES</b>	<b>15</b>
--------------	-----------

<b>COMPANY INFO</b>	<b>16</b>
---------------------	-----------

## INTRODUCTION

### Jeremias Exhaust Systems

Models DWKL and SWKL are factory built high pressure and high temperature exhaust systems for various type of appliances. Model DWKL is Double Wall and Model SWKL is Single Wall. Each may be intermixed in the same exhaust or chimney system.

The Models DWKL-Vt and SWKL-Vt variations are intended for use in connecting heating and hot water appliances, engines, and turbines to the outdoors. These 'Vent' variations are limited to 1200°F continuous so not approved for such extreme high temperatures such as 1400°F continuous, 2000°F for 30 minutes, and 2100°F for 10 minutes which are approved for the DWKL and SWKL Models (see separate Submittal and Instructions). There are also many other applications and uses including, but not limited to the following: Chimney Liners, Chutes, Dryer Vents, Fume Venting, Industrial Oven and Process Stacks, Paint Booth Exhausts, Particle Conveying, and Ventilation Ducts.

## STRONG - OPEN - INTERNATIONAL



### 40 Years of Experience

Jeremias is one of the world's leading manufacturers of flue and chimney systems for the exhaust of gases and ventilation, covering all kinds of domestic, commercial and industrial applications. Jeremias Group product range includes 50 different CE or UL certified systems covering commercial and domestic applications complimented by freestanding Industrial steel chimneys up to 10 feet in diameter. Jeremias offers its clients a wide range of high quality products, technical support for projects, and stack sizing software.

With over 40 years of experience in the venting and component exhaust industries, Jeremias has seven (7) manufacturing plants in six (6) different countries worldwide. Jeremias today has more than 1,000 employees and is proud of its German engineering origins. Today we are manufactured in the USA from 100% local materials!

Here in North America, Jeremias Inc. focuses on only high pressure exhaust systems for commercial and industrial applications.

### Research and Development

Jeremias has over sixty (60) CE Certified exhaust and chimney systems worldwide for domestic, commercial, and industrial applications. "CE Certification" is the mandatory conformity safety testing for products sold throughout Europe and other parts of the world.

In North America, Jeremias employs only Underwriters' Laboratories (UL) for testing, certifications, and listings to all applicable UL and ULC Standards.



## INTRODUCTION

Opened in 2013, the Jeremias R&D Lab in Logan, OH has the industry's most experienced lab technicians on staff and incorporates the latest equipment technologies. This laboratory enables Jeremias to provide industry leadership with a continued focus on new factory-built exhaust applications and unique listings. For example, Model DWKL is the first double wall commercial exhaust system in North America that is purposely designed to use insulation between the walls from the start; whereas other manufacturers derived insulated versions from the original air space design.

### All Stainless Steel Construction



The standard 444 stainless steel (EN 1.4521) inner wall is the new standard for high temperatures yet still corrosion resistant to flue gas condensation. 444 stainless steel provides a better higher temperature solution over austenitic 304 or 316 stainless steels due to lower expansion coefficient value, meaning no cracking from less expanding oxides. 444 stainless steel has very good resistance to pitting corrosion in chloride media, much better than 304 (EN 1.4301) and 316 (EN 1.4401) stainless steels, and even better than 316L (EN 1.4404) stainless steel. 444 stainless steel also has a higher minimum proof strength than 304 stainless steel in combination with lower work hardening behavior.

The outer jacket is always made of stainless steel, Type 430 stainless steel with a bright annealed finish is standard. All accessories (including support plates and angle rings) are also made of stainless steel. This means there is no cross contamination in the factory from carbon steel cutting/welding. Jeremias cleans all external welds to assure the customer clearly sees the quality standard we are setting.

Jeremias backs our exhaust systems with an industry's first Twenty-Five (25) Year Standard Warranty.

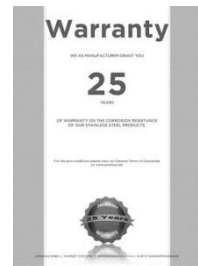

### Best Insulation

Jeremias uses ROXUL ProRox® rigid mineral wool (stone wool) insulation board, which provides superior thermal and acoustical values. It is also fire resistant, water repellent, non-corrosive and resistant to mold. ROXUL Inc. is part of ROCKWOOL International with 75+ years of global experience where they remain fully committed to providing the very best service in the market and a total range of cutting-edge insulation solutions.

Jeremias wire cuts the insulation board into 1¼" wide curved and ship lapped strips. The ship lapped edges guarantee a continuous insulation without any breaks. These strips are aligned together around the inner pipe and the outer jacket is pressed into place. A precise length of the strips assures that there are also no gaps within the installed joint. Due to the compression of the insulation, the inner pipe is kept in place without metal connections between the inner and outer jacket and therefore without any heat bridge. This delivers the best clearances and skin temperatures in the gas vent market.



### Largest Joint Connection Surface Area

Models DWKL-Vt and SWKL-Vt are cylindrical, factory-built, modular venting systems that incorporate a steel to steel conical joint and clamp system for quick and easy assembly in the field. A Jeremias supplied high temperature ceramic lubricating and assembly paste is applied on the conical joint to assure the best steel to steel connection; and it is then tapped into place creating a gas-tight and liquid-tight seal.

The conical joints have a 2.2" steel to steel overlap at each connection allowing greater stiffness, sealing, and durability compared to ½" flange to flange systems. Example, 6" I.D. SWKL/DWKL-Vt have a 41.45 in<sup>2</sup> surface area at each joint where a ½" flanged systems has 9.42 in<sup>2</sup>. UL Testing resulted in an industry first 90" W.C. pressure capability after continuous 1400°F flue gas temperatures.

The double wall Model DWKL-Vt is insulated with 1¼" cut mineral wool which allows the inner and outer pipes to stay aligned without the use of additional clips or brackets. On other designs, clips or brackets act as a thermal bridge from the inner wall to outer jacket, so with no additional thermal bridge at the joint means there are no hot spots at the pipe and fitting connections.

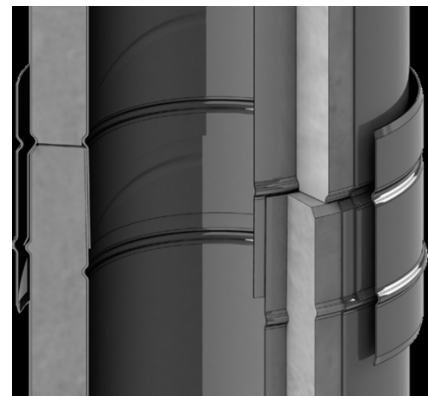

## TECHNICAL SPECIFICATIONS

### Model and Part Identifications

Part numbers include the Model (DWKL or SWKL), diameter, item code, and variation

Example 1: DWKL8-36L-Vt for an 8 inch inner diameter Model DWKL double wall 36 inch length of pipe.

Example 2: SWKL10-90WT-Vt for a 10 inch inner diameter Model SWKL single wall 90° Wye Tee.

### Material and Thicknesses

(DWKL-Vt and SWKL-Vt)

Inner Liner:

0.020" thick Type 444 stainless steel

(DWKL-Vt only)

Insulation:

1.25" thick cut rigid mineral wool

(DWKL-Vt only)

Outer Jacket:

0.025" thick Type 430 stainless steel

All supports and accessories:

304 stainless steel

### Underwriters Laboratories Listings

United States:

(DWKL-Vt)

1. UL-1738 Standard, Special Gas Vent for Category II, III, & IV Appliances
2. UL-641 Standard, Type L Vent
3. UL-441 Standard, Type B Gas Vent
4. UL-103 Standard, Building Heating Appliance Chimney

(SWKL-Vt)

5. UL-1738 Standard, Special Gas Vent for Category II, III, & IV Appliances
6. UL-103 Standard, Building Heating Appliance Chimney

Canada:

(DWKL-Vt)

7. ULC-S636 Standard for Type BH Gas Venting Systems
8. ULC-S609 Standard for Low-Temperature Vents Type L
9. ULC-S605 Standard for Gas Vents
10. Industrial Type 540°C Chimney

(SWKL-Vt)

11. ULC-S636 Standard for Type BH Gas Venting Systems

### Operating Pressures

Models DWKL-Vt and SWKL-Vt have been evaluated and Listed by UL for positive pressures up to 90" W.C. internal static pressure.

### Code and Standards

Models DWKL-Vt and SWKL-Vt when installed per their Installation Instructions, are code compliant with:

- NFPA 211
- NFPA 54
- NFPA 31
- NFPA 37
- CSA-B149
- IMC
- IFGC
- UMC
- CMC
- CSA-B139

Also Models DWKL-Vt and SWKL-Vt comply with the following codes and standards related agencies or associations:

- NFPA (National Fire Protection Association)
- ASHRAE (American Society of Heating, Refrigerating and Air Conditioning Engineers)
- ICC (International Code Congress)
- UL (Underwriters Laboratories, Inc.)
- ULC (Underwriters' Laboratories of Canada)
- CSA (Canadian Standards Association)
- IAPMO (International Association of Plumbing and Mechanical Officials)

### Operating Temperatures and Clearances

#### Operating Temperatures:

Criteria	Permitted Temperatures
UL-1738 Special Gas Vent ULC-S636 Gas Vent	550°F (288°C) Continuous
Optional 480°F UL-1738 Special Gas Vent	480°F (204°C) Continuous
Optional Plastic UL-1738 Special Gas Vent	148°F (64°C) Continuous for PVC 194°F (90°C) Continuous for CPVC 248°F (120°C) Continuous for PP
UL-441 Gas Vents ULC-S605 Gas Vents	480°F (249°C) Continuous
UL-641 Type L Vent ULC-S609 Vents Type L	570°F (300°C) Continuous
UL-103 Building Heating Appliance Chimney ULC/ORD-C959 Industrial Type 540°C Chimney	1000°F (540°C) Continuous 1400°F (760°C) Intermittent

## TECHNICAL SPECIFICATIONS

### Joint Detail

Models DWKL-Vt and SWKL-Vt are cylindrical, factory-built, modular venting systems that incorporate a steel to steel conical joint and clamp system for quick and easy assembly in the field.

A Jeremias supplied ceramic lubricating and assembly paste is applied on the inner wall conical joint to assure the best steel to steel connection.

The double wall Model DWKL-Vt is insulated with 1¼" thick compressed fiber which allows the inner and outer pipes to stay aligned.

Model DWKL-Vt Assembly Detail

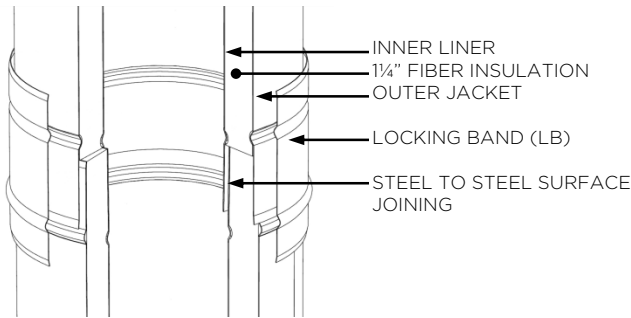

Further features of Model DWKL-Vt double wall and fiber insulated include:

- Reduced clearance to combustibles
- Reduced outer pipe skin temperatures
- Reduced building heat gain
- Increased efficiencies of energy recovery systems
- Reduced noise levels caused by high velocity exhausts
- Maintain flue gas heat for chimney draft performance

Model SWKL-Vt Assembly Detail

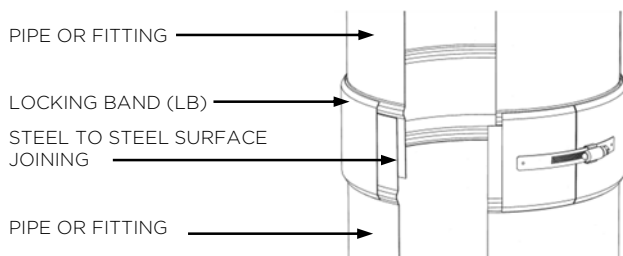

Further features of Model SWKL-Vt single wall include:

- No field welding
- All stainless steel construction
- Smooth flowing inner liner compared to welded steel
- Wide array of accessories such as supports and drains
- May be connected to and from DWKL-Vt

### Pipe Weight per Foot

The approximate installed weight of the DWKL-Vt and SWKL-Vt exhaust systems can be found using this table. This table does not include accessories such as supports and guides, nor shipping packaging or palletizing weight.

Pipe Weight - Lb./Ft. (kg/m)

Inside Diameter	DWKL-Vt	SWKL-Vt
3" (76mm)	2.8 (4.2)	0.6 (0.9)
4" (102mm)	3.5 (5.2)	0.9 (1.3)
5" (127mm)	4.1 (6.1)	1.1 (1.6)
6" (152mm)	4.8 (7.2)	1.3 (1.9)
7" (178 mm)	5.4 (8.0)	1.5 (2.2)
8" (203mm)	6.1 (9.1)	1.7 (2.5)
9" (229mm)	6.7 (10.0)	1.9 (2.8)
10" (254mm)	7.4 (11.0)	2.1 (3.1)
11" (249mm)	8.0 (11.9)	2.3 (3.4)
12" (305mm)	8.7 (13.0)	2.6 (3.9)
13" (330mm)	9.3 (13.8)	2.8 (4.2)
14" (456mm)	10.0 (14.9)	3.0 (4.5)
16" (406mm)	11.3 (16.8)	3.4 (5.1)
18" (457mm)	12.6 (18.8)	3.8 (5.7)
20" (508mm)	13.8 (20.6)	4.3 (6.4)
22" (559mm)	15.1 (22.5)	4.7 (7.0)
24" (610mm)	16.4 (24.4)	5.1 (7.6)

### Sizing/Pressure Calculations

Jeremias' engineering uses its own software based upon the "Chimney, Gas Vent, and Fireplace Systems" chapter of the ASHRAE Handbook to assure that the exhaust and chimney system is sized in accordance with the appliance manufacturers' installation instructions.



## TECHNICAL SPECIFICATIONS

### Joint Assembly

The Model DWKL-Vt joint system is designed for a quick and easy installation. Follow Steps 1 through 4 for general pipe and fittings assembly.

#### Model DWKL-Vt Assembly

##### Step 1

Clean the inner side of the female end and the outer side of the male end of each pipe. Apply the KL Paste to the female end.

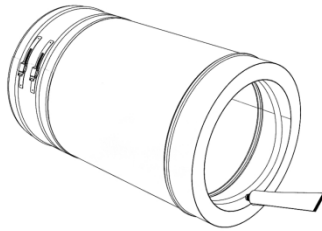

##### Step 2

Use your hands to center both pipes in alignment. Connect both pipes and press them together as much as possible by hand.

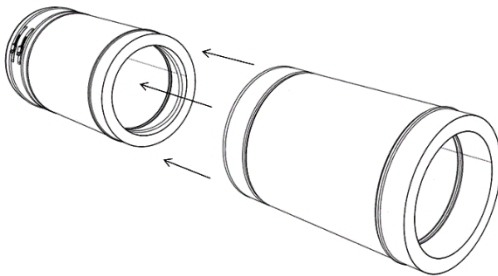

##### Step 3

Use the wood plate (supplied with shipment) and place it on the end of the assembly.

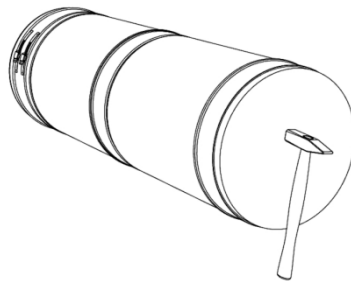

Tap 2-3 times. Make sure to press both inner and outer pipes together; the inner should not be more than 1/8" longer than the outer pipe once the male/female conical ends are engaged.

##### Step 4

Install and fix the Locking Band (LB). To ensure the connection is well done, the Locking Band has to be perfectly fitted in both grooves.

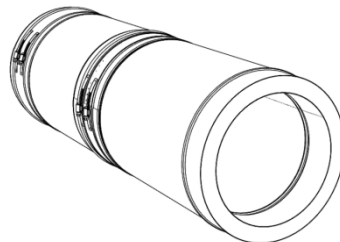

The Model SWKL-Vt single wall system includes the same construction features as the inner portion of the Model DWKL-Vt. SWKL-Vt is installed in a similar manner to DWKL-Vt.

### Support Innovations

Jeremias uses a one-piece Anchor Plate Support (APS) that incorporates a heavy gauge stainless steel plate that is factory welded to a short pipe length.

Also available is the Heavy Duty Base (HDB) that eliminates the need for the installer to build framework around the support base. The HDB is made to accept steel by the installer (for both vertical and horizontal configurations) and can support heights up to 300' of vertical pipe weight.

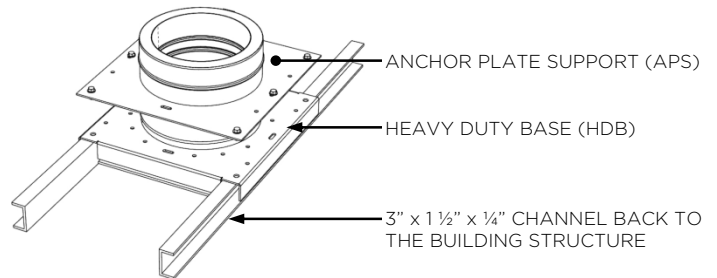

2" x 2" x 1/4" ANGLE BRACING BACK TO THE BUILDING STRUCTURE BY THE INSTALLING CONTRACTOR

HEAVY DUTY BASE (HDB)

ANCHOR PLATE SUPPORT (APS)

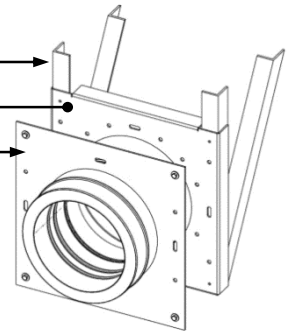

### Submittal and Warranted Designs

Jeremias also provides CAD layout designs that show all required accessories including drains, supports, access panels, etc., permitting it to be installed in accordance with any specific appliance manufacturers' installation instructions.

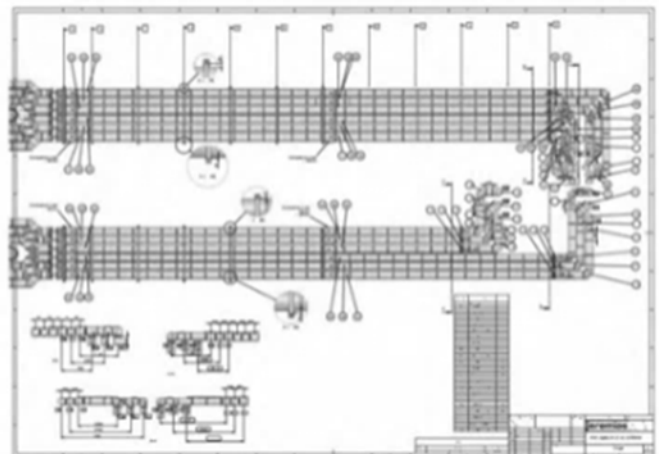

## SAMPLE SYSTEMS

### SAMPLE 1 - SWKL-Vt CATEGORY III OR IV SIDEWALL 4X 10" I.D. SIDEWALL VENTED

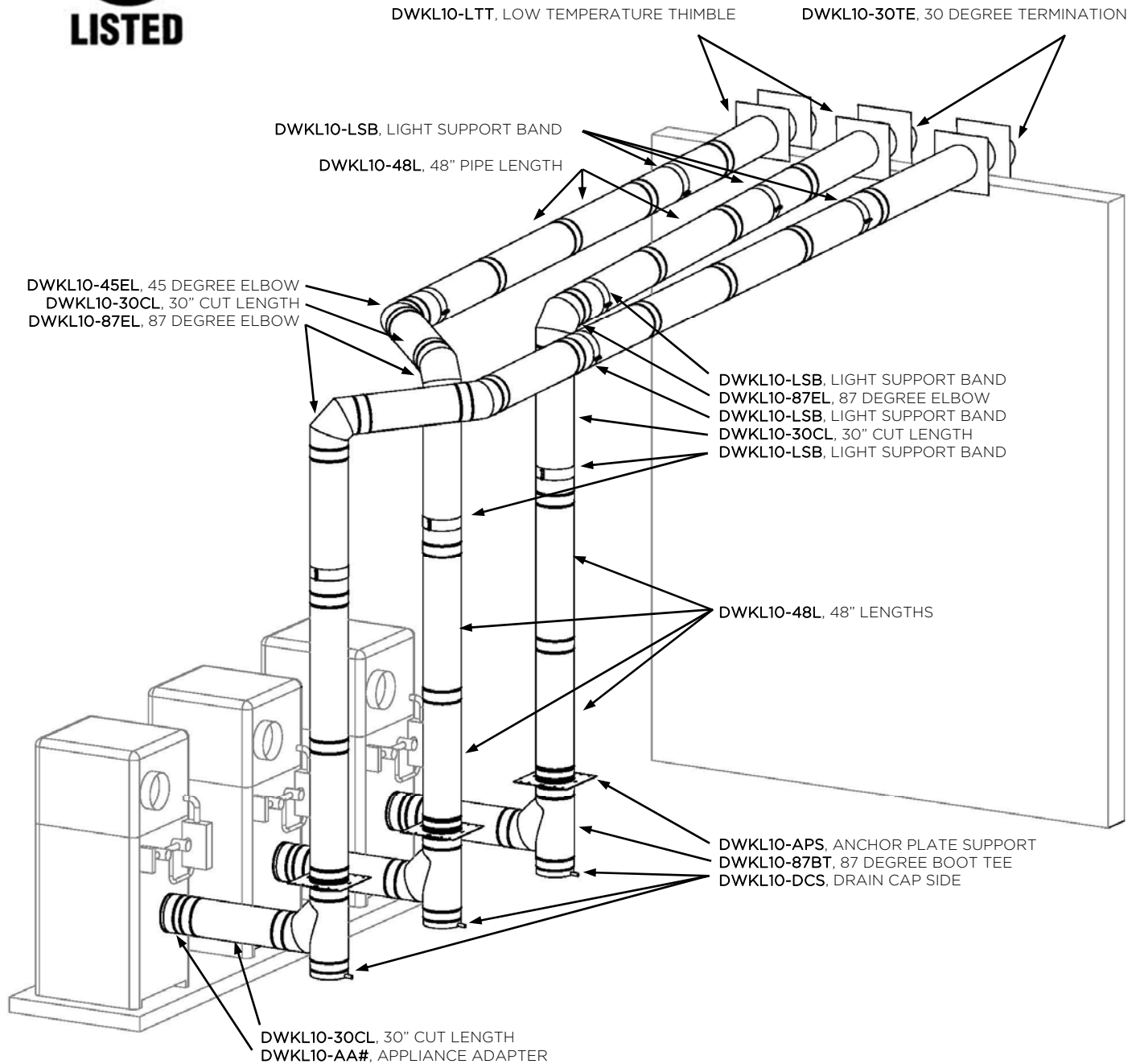



## SAMPLE SYSTEMS

### SAMPLE 2 - DWKL-Vt/SWKL-Vt SEALED COMBUSTION 4X 4" I.D. DWKL VERTICALLY VENTED WITH SWKL SIDEWALL INTAKES

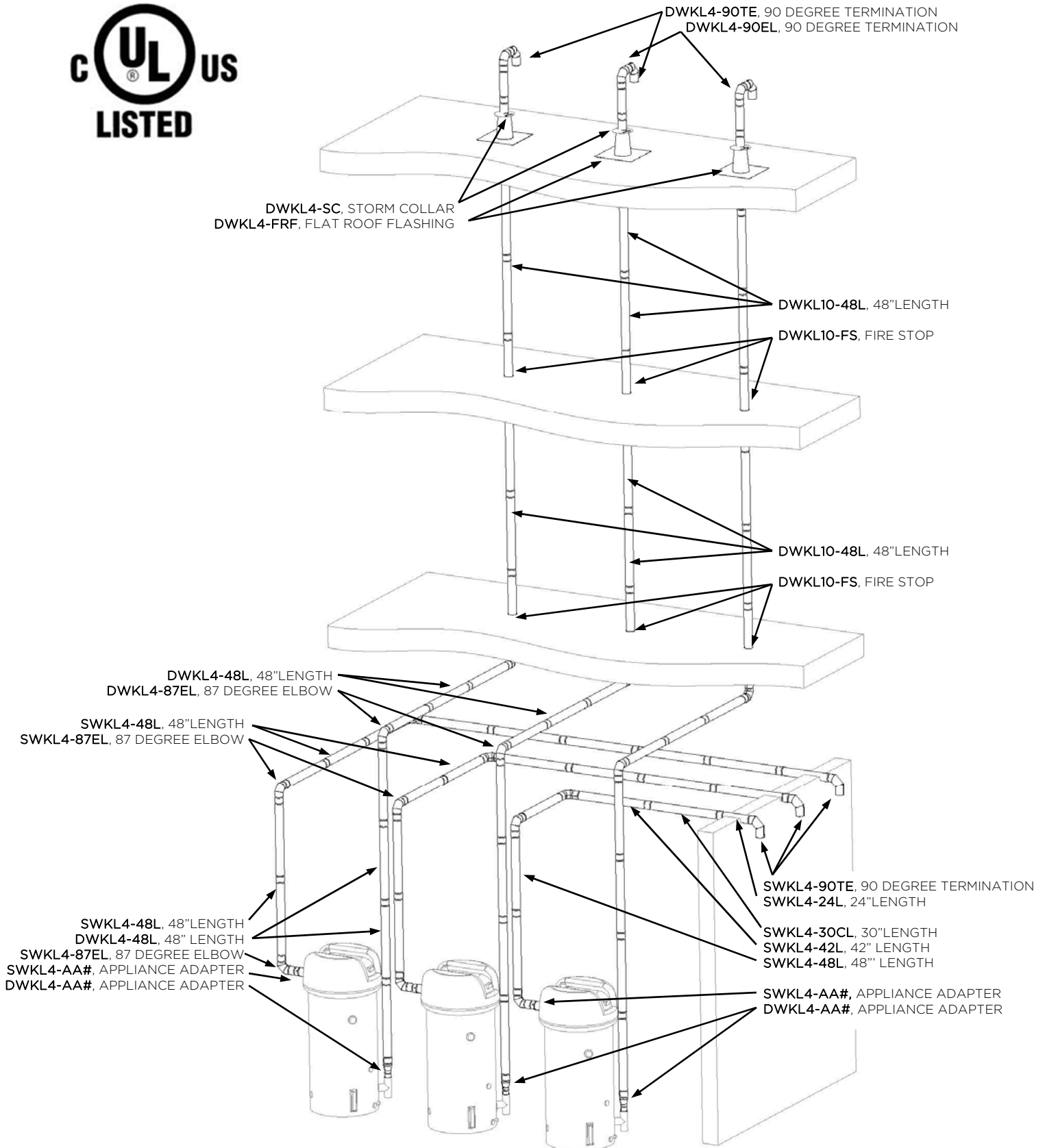

## SAMPLE SYSTEMS

### SAMPLE 3 - SWKL-Vt FUME HOOD VENT

THREE (3) 8" I.D. INTO 10" I.D. AND 14" I.D. SINGLE WALL EXHAUST

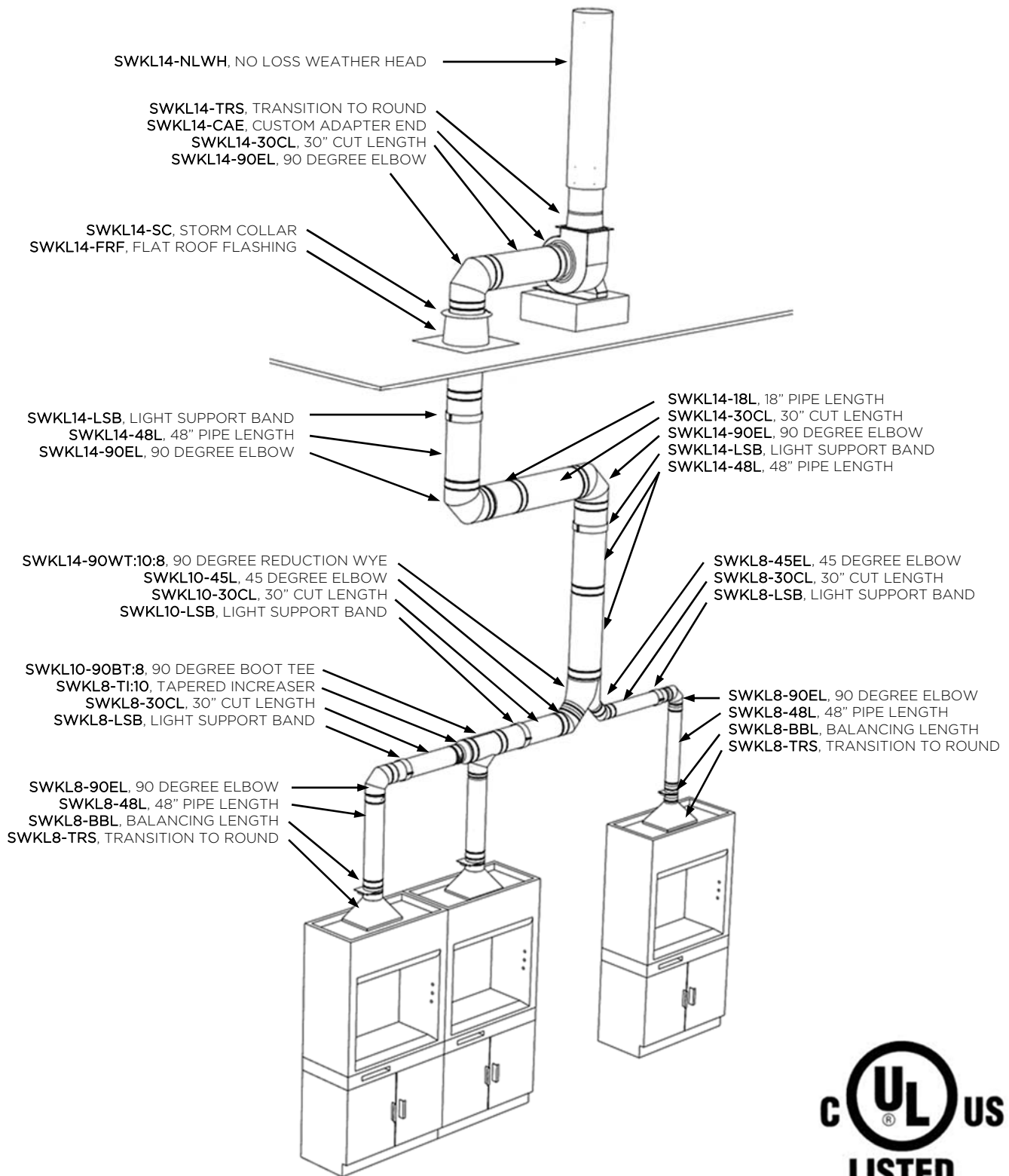

## SAMPLE SYSTEMS

### SAMPLE 4 - SWKL-Vt COMMERCIAL DISHWASHER EXHAUST 2X 8" INTO 12" I.D. DISHWASHER EXHAUST

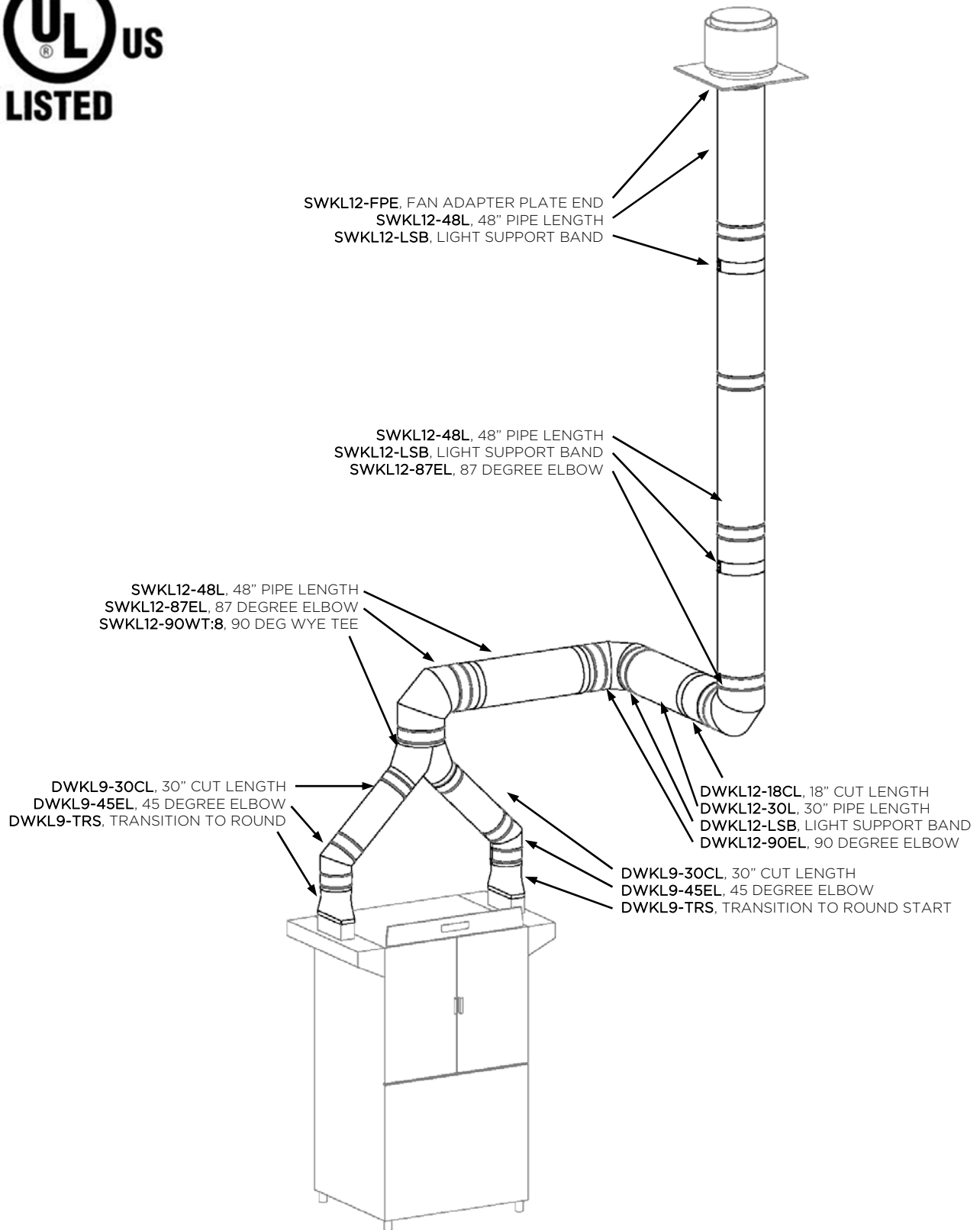

## SAMPLE SYSTEMS

### SAMPLE 5 - DWKL-Vt BOILER STACK

TWO (2) 16" I.D. INTO 20" I.D. / 22 1/2" O.D. STACK

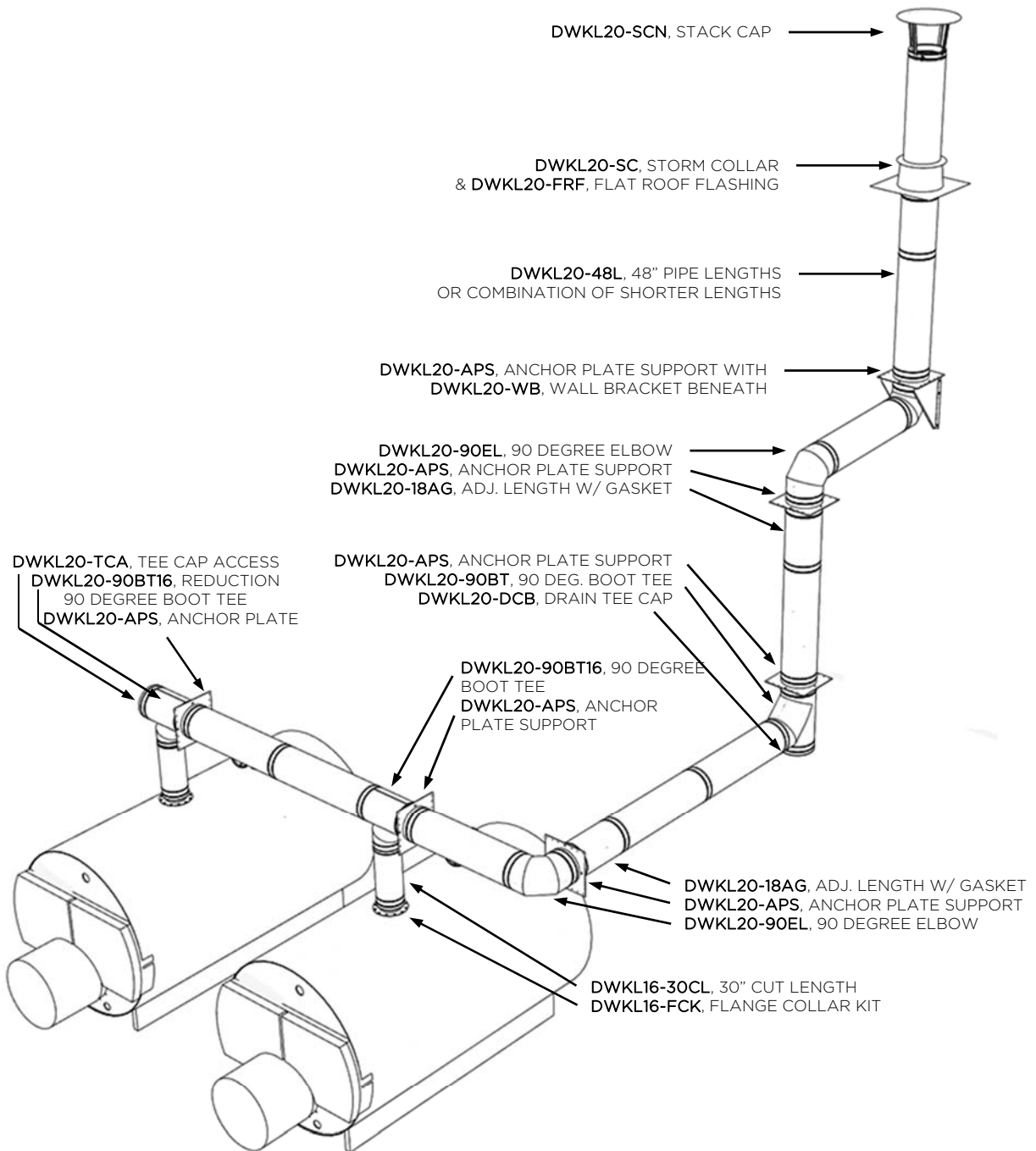

## SAMPLE SYSTEMS

### SAMPLE 6 - DWKL-Vt ENGINE EXHAUST THREE (3) 14" I.D. / 16 1/2" O.D. EXHAUST SYSTEMS

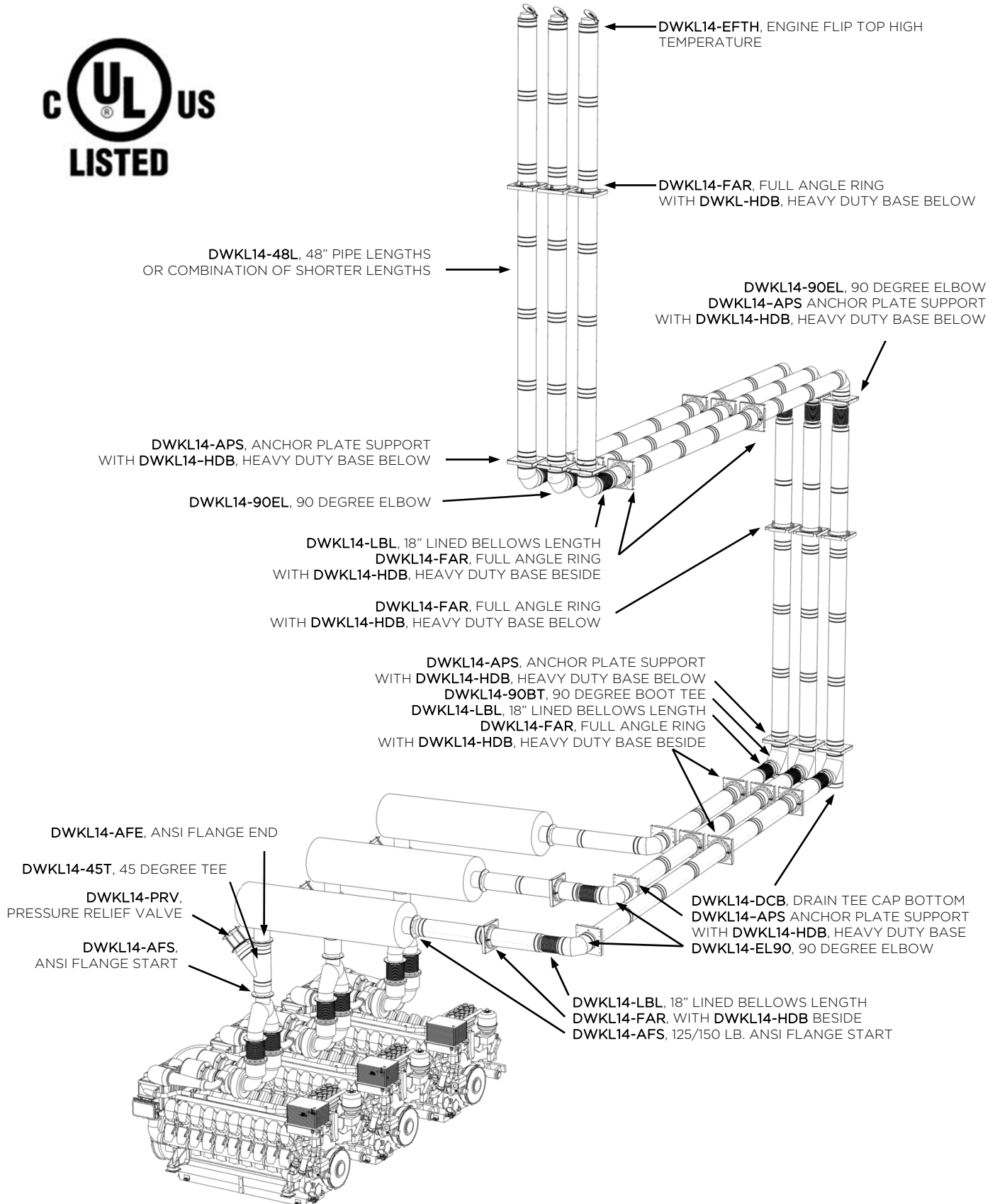

## WARRANTY STATEMENT

### I. 1-Year Limited Warranty

Jeremias Inc. ("Jeremias") provides a 1-year limited warranty ("1-Year Limited Warranty") for its high pressure and high temperature exhaust systems models SWKL-Vt and DWKL-Vt (collectively, the "Products") for any defect in workmanship or materials under normal use from the date of shipment to the purchaser of Products ("Purchaser"), subject to the following conditions:

- Product sizing and specifications have been performed in accordance with generally accepted engineering practices.
- Correct installation and maintenance in full compliance with Jeremias' installation and maintenance instructions as published at the time of installation.

### II. Extended 25-Year Limited Warranty

Jeremias provides for an extended 25-year limited warranty ("25-Year Limited Warranty") for any defect in workmanship or materials under normal use from the date of shipment to the Purchaser, subject to the satisfaction of the following conditions:

- Products must have been designed and sized by Jeremias' personnel.
- Availability of a written inspection report from the time of installation, or timely thereafter, by a Jeremias inspector or an inspector authorized by Jeremias, that the Product assembly and installation conformed to all of Jeremias' assembly and installation instructions.
- Products were at all times operated and maintained in full compliance with Jeremias' operation and maintenance instructions as published at the time of installation or as later provided to Purchaser by Jeremias.

### III. Exclusion of Limited Warranty

The 1-Year Limited Warranty and the 25-Year Limited Warranty (collectively the "Limited Warranty") shall not cover (i) damages to: wear parts, e.g. seals; demonstration units; paintwork; moving parts, including but not limited to compensators, flue gas dampers, draught regulators, chimney, doors; flexible piping; insulation; consumables, such as granulates; minor Product deviations which do not effect functionality; or (ii) damages caused by: contamination of ambient air or combustion air by chlorinated hydrocarbons or other vapors which may cause excessively severe acid condensate to form within the Products; merchandise provided by other manufacturers; installation, transport or commissioning; Purchaser, an installer or other third parties; normal wear and tear; any party other than Jeremias in a willful manner; force majeure, including, but not limited to flood, fire or frost; non-compliance with the assembly, installation, operation and maintenance instructions available at [www.JeremiasInc.com](http://www.JeremiasInc.com); assembly, installation, maintenance or repair by unqualified personnel; improper commissioning; use of Products not in accordance with their intended purpose; exposure of Products to any metals of an inferior quality; contamination of the Products between unpacking and assembly; burning of wood other than unpainted, natural wood, which has been stored for at least 3 years and which moisture level does not exceed 20%; or burning of chipboard or domestic waste.

### IV. Remedies

If a valid Limited Warranty claim arises, Jeremias shall, at its sole discretion, either repair the Product or deliver a properly functioning Product. This Limited Warranty is limited to repair or replacement of the Product plus shipping cost to the location of the defective Product. The Limited Warranty does not cover labor costs for removal or replacement of the defective Product, unless such labor shall be carried out by Jeremias itself in its sole discretion.

### V. Filing of a Limited Warranty Claim

Limited Warranty claims may only be asserted during the term of the applicable Limited Warranty period. Any extension of the term of the Limited Warranties shall be excluded, regardless of the legal basis. If Purchaser believes that there is a justified Limited Warranty claim, Purchaser shall notify Jeremias to that effect in writing. Any claims stemming from or relating to a Limited Warranty shall be asserted in detail within eight weeks after the discovery of the defect (the time when the notification is received by Jeremias will be the basis for determining whether a claim has been reported within this deadline) or else shall be excluded and not be recognized by Purchaser. Such notification shall include a description of the defect, original proof of purchase, and a copy of the written inspection report as described in Section II above (if applicable).

### VI. No Other Warranty

EXCEPT AS SET FORTH EXPRESSLY THEREIN, JEREMIAS MAKES NO WARRANTIES, EITHER EXPRESS OR IMPLIED, REGARDING THE PRODUCTS, INCLUDING, BUT NOT LIMITED TO, THE IMPLIED WARRANTIES OF MERCHANTABILITY AND FITNESS FOR A PARTICULAR PURPOSE.

### VII. Damages Disclaimer and Limitation

IN NO EVENT SHALL JEREMIAS BE LIABLE TO ANY CLIENT OR ANY OTHER PERSON FOR ANY (A) INDIRECT, INCIDENTAL, CONSEQUENTIAL OR PUNITIVE DAMAGES, INCLUDING LOSS OF PROFIT OR GOODWILL OR (B) DIRECT DAMAGES TO BODY, HEALTH OR PROPERTY FOR ANY MATTER ARISING OUT OF OR RELATING TO THE PRODUCTS, WHETHER SUCH LIABILITY IS ASSERTED ON THE BASIS OF CONTRACT, TORT OR OTHERWISE EVEN IF JEREMIAS HAS BEEN ADVISED OF THE POSSIBILITY OF SUCH DAMAGES. IN NO EVENT SHALL JEREMIAS' TOTAL AGGREGATE LIABILITY FOR DAMAGES EXCEED THE GREATER OF THE AMOUNT OF (A) TOTAL COMPENSATION PAID BY PURCHASER TO JEREMIAS FOR THE PRODUCTS, OR (B) PROCEEDS AVAILABLE FROM ANY INSURANCE POLICY IN EFFECT AND APPLICABLE TO THE EVENT GIVING RISE TO SUCH LIABILITY.

### VIII. Notice

Any notice or other communication hereunder to Jeremias shall be sent postage prepaid, by certified mail, by courier such as United Parcel Service or e-mail, to the following: Jeremias Inc., 983 Industrial Park Drive, Marietta, GA 30062, E-mail: [Info@JeremiasInc.com](mailto:Info@JeremiasInc.com). Notices shall be effective upon receipt.

### IX. Terms and Conditions of Sale

Purchaser's Terms and Conditions of Sale as currently in effect shall govern these Limited Warranties, including without limitation the rights and responsibilities granted hereunder.

[illegible]

## This image shows a single sheet of white paper with horizontal blue or grey ruling lines. The lines are evenly spaced and run across the width of the page. There are no margins, text, or other markings on the paper.



Jeremias SUBMITTAL\_DS-GOV, 4-11-15