

# Technical Data Sheet

## Support Base Plate

### SBP

#### Product Line

-SBP, -DCSS, -87ES, -90ES, -87BTS, & -90BTS



#### Purpose

Installation ease when supporting vertical sections in a Jeremias conical joining system.

The Support Base Plate saves contractor time and money while giving the installation a clean European appearance.

Eliminates the need for an Anchor Plate Support (APS) above the fitting, and the need to support that back to the building structure.

#### Applications

For all DWKL and SWKL variations, diameters, and UL Listings.

#### UL Listings (and ULC)

All applicable UL and ULC Listings for all variations of DWKL & SWKL.

#### -SBP, -DCSS, & -87BTS (or -90BTS)



#### -SBP Support Base Plate



#### Materials / Construction

The supporting tube is a normal 0.025" thick 304/430 stainless steel DWKL outer jacket (or SWKL pipe for single wall applications).

A 16-gage 304 stainless steel square base plate is factory welded to the bottom.

#### Installation Details

Must be used with accepting Drain Tee Cap Side for Support (DCSS), 87-Degree Elbow for Support (87ES), or 90-Degree Elbow for Support (90ES).

The installer field cuts the 48" tube to appropriate height allowing the Support Base Plate to support the vertical riser. Greater than 48" lengths are possible on custom orders.

Maximum height above standard 3" though 24" Support Base Plate (SBP) is 50'. Up to 300' and other diameters are possible on custom orders.

#### Features

- All-stainless with 25-year warranty.
- Cut length available for maximum field flexibility.
- Clean and smooth appearance.

# Technical Data Sheet

## Support Base Plate

### SBP

#### Product Line

-SBP, -DCSS, -87ES, -90ES, -87BTS, & -90BTS



#### Dimensions

Standard dimensions used for each component.

Customs are available upon request.

-87ES (or -90ES), & -SBP

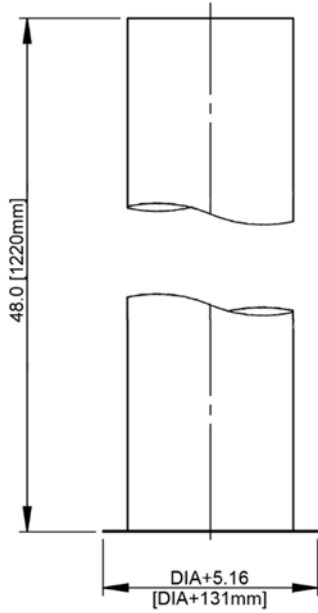

**Support with Square Base Plate**

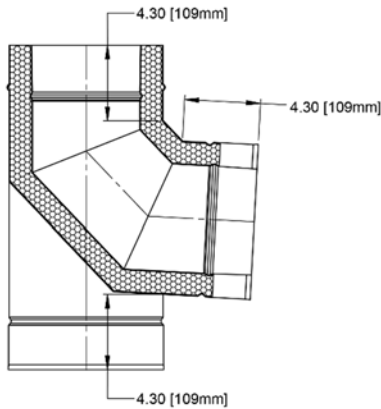

**87° Elbow with Support Leg**

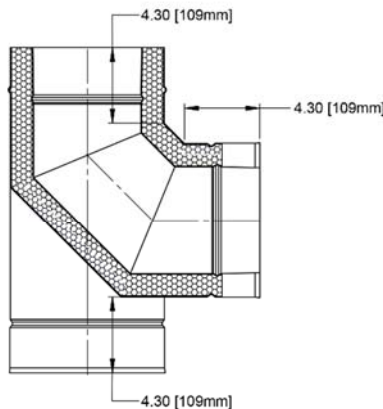

**90° Elbow with Support leg**

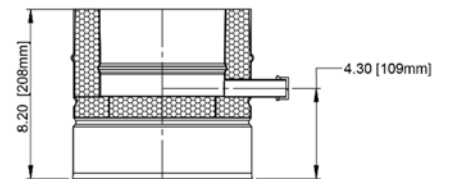

**Drain Tee Cap for Support**