

TECHNICAL DATA SHEET

Modulating Vent Damper

VSD



PRODUCT LINE

VSD - Modulating and On/Off Vent Damper System

DESCRIPTION

The VSD Vent Damper System consists of a single blade damper. The damper restricts the air flow to maintain a constant negative or positive pressure in the vent exhaust connector of Building Heating Appliances.



APPLICATIONS

- Motor actuated on/off and modulating gas vent damper for Building Heating Appliances
- Essential for common venting appliances - as the common diameter of a multiple appliance manifold and stack could have too much available draft for a single appliance
- Essential for tall chimneys - as even at low fire it might be possible the dedicated vented appliance has too much available draft
- Reduction of cycle venting losses through boilers and draft hoods

FUNCTION

- Open/close damper with appliance on/off
- Pressure sensor reads internal vent pressure
- Sensor is interlocked with controller to maintain constant pressure
- Controller interlocks with actuator, which turns the external damper rod
- The rod is connected to a damper blade that rotates to restrict or relieve exhaust flow

LISTINGS & RATINGS

- Listed to UL-378 Standard for Draft Equipment
- 0.85" WC maximum static pressure
- Maximum 1000°F continuous flue gas temperature
- 24V DC/AC power supply

CONSTRUCTION

- 20 Gauge 316L stainless-steel housing and blade
- ½" graphite-sealed bearings

CONNECTION/INSTALLATION DETAILS

- ½" flanged connections
- Positioning: horizontal or vertical - shaft must remain horizontal

ADVANTAGES

- Includes a capacitor return safety mechanism
- Condensate tight shaft
- Two auxiliary switches
- Bi-directional pressure transducer
- Fast acting actuator, 2 or 4 second 0°-90° span

INTEGRATED COMPONENTS

- Damper housing, blade, and shaft
- 0-10 VDC fast-acting actuator
- Constant pressure controller
- LP5 bi-directional pressure transducer
- Vent probe and silicone tubing



TECHNICAL DATA SHEET

Modulating Vent Damper

VSD

PRODUCT LINE

VSD - Modulating and On/Off Vent Damper System

PRODUCT SPECIFICATIONS

VSD Dimensions - Modulating and On/Off Vent Damper System



Dimensional Data - Damper & Actuator				
Model	A	B	C	D
VSD4	4"	4.875"	10.625"	11.25"
VSD6	6"	6.875"	10.625"	12.875"
VSD8	8"	8.875"	10.625"	14.875"
VSD10	10"	10.875"	10.625"	16.875"
VSD12	12"	12.875"	10.625"	19"
VSD14	14"	14.875"	10.625"	21"
VSD16	16"	16.875"	15.875"	23"

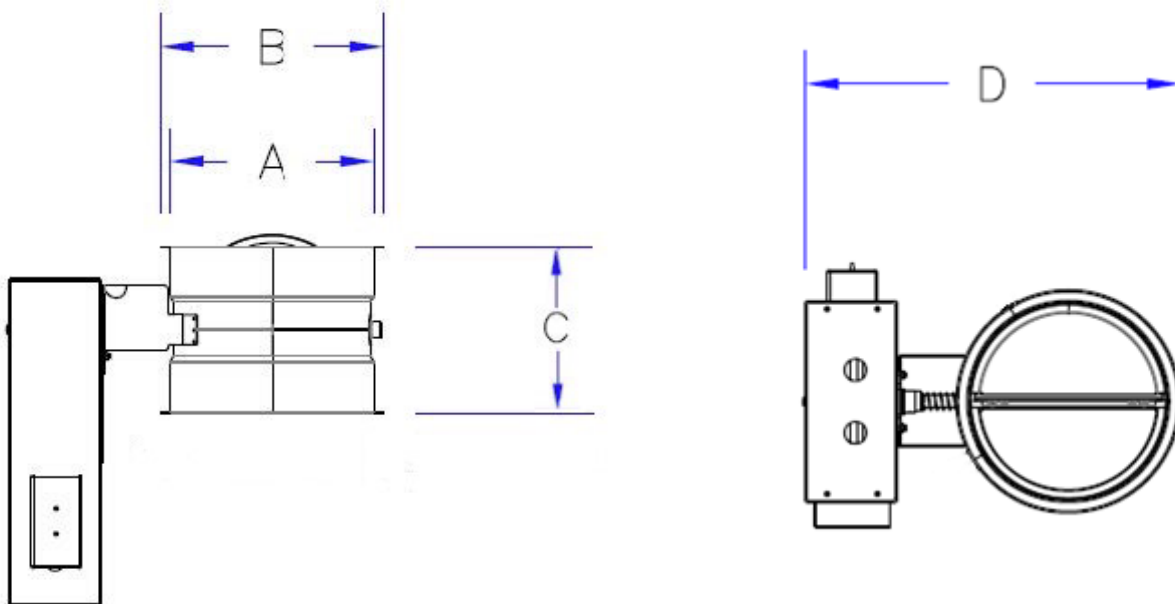

Controller (Attached to Actuator Housing)		
A	B	C
4.375"	3.125"	1.25"
Power Supply		Power Consumption
24V DC/AC (12V-30V Class 2)		100 mA max @ 12V DC
Relay Output Contact Rating		
2A @ 24VDC/AC		

