

TECHNICAL DATA SHEET

Modulating Vent Damper

VSD-G



PRODUCT LINE

VSD-G – Modulating and On/Off Vent Damper System

DESCRIPTION

The VSD-G Vent Damper System consists of a single blade damper. It can be used as an on/off damper to prevent airflow through the appliance in an off cycle as well as to maintain a constant negative or positive pressure in the vent exhaust connector.



APPLICATIONS

- Motor actuated on/off and modulating gas vent damper for gas vents serving gas or liquid burning appliances such as Category I, II, III, & IV Appliances
- Essential for common venting Condensing or Category II/IV Appliances – will not allow any possibility of flue gas recirculation and to always maintain constant exhaust pressure for each appliance
- Elimination of cycle venting losses through boilers and draft hoods

FUNCTION

- Open/close damper with appliance on/off
- Pressure sensor reads internal vent pressure
- Sensor is interlocked with controller to maintain constant pressure
- Controller interlocks with actuator, which turns the external damper rod
- The rod is connected to a damper blade that rotates to restrict or relieve exhaust flow

LISTINGS & RATINGS

- Listed to UL-378 Standard for Draft Equipment
- 0.85" WC maximum static pressure
- Leakage rate 10 CFH at 3" WC
- Maximum 550°F continuous flue gas temperature
- 24V DC/AC power supply

CONSTRUCTION

- 20 Gauge 316L stainless-steel housing and blade
- ½" graphite-sealed bearings
- Viton seal on damper blade

CONNECTION/INSTALLATION DETAILS

- ½" flanged connections
- Positioning: horizontal or vertical – shaft must remain horizontal

ADVANTAGES

- Includes a capacitor return safety mechanism
- Condensate tight shaft
- Two auxiliary switches
- Bi-directional pressure transducer
- Fast acting actuator, 2 or 4 second 0°-90° span

INTEGRATED COMPONENTS

- Damper housing, blade, and shaft
- 0-10 VDC fast-acting actuator
- Constant pressure controller
- LP5 bi-directional pressure transducer
- Vent probe and silicone tubing



TECHNICAL DATA SHEET

Modulating Vent Damper

VSD-G



PRODUCT LINE

VSD-G – Modulating and On/Off Vent Damper System

PRODUCT SPECIFICATIONS

VSD-G Dimensions – Modulating and On/Off Vent Damper System

Dimensional Data - Damper & Actuator				
Model	A	B	C	D
VSD4-G	4"	4.875"	10.625"	11.25"
VSD6-G	6"	6.875"	10.625"	12.875"
VSD8-G	8"	8.875"	10.625"	14.875"
VSD10-G	10"	10.875"	10.625"	16.875"
VSD12-G	12"	12.875"	10.625"	19"
VSD14-G	14"	14.875"	10.625"	21"
VSD16-G	16"	16.875"	15.875"	23"

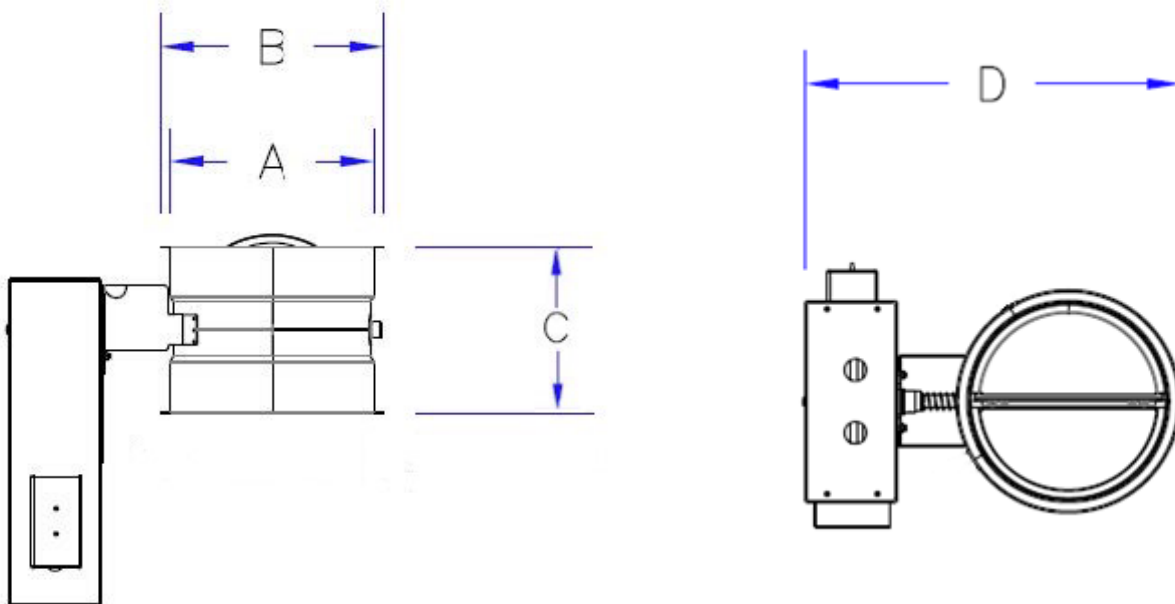

Controller (Attached to Actuator Housing)		
A	B	C
4.375"	3.125"	1.25"
Power Supply		Power Consumption
24V DC/AC (12V-30V Class 2)		100 mA max @ 12V DC
Relay Output Contact Rating		
2A @ 24VDC/AC		

